

**WINTER HEY LANE, HORWICH
TEMPORARY CLOSURE**

THE BOROUGH COUNCIL OF BOLTON
ROAD TRAFFIC REGULATION ACT 1984 S.14

The Council intends to make an order, operative on 27 July 2026 for 1 day approx, the effect of which will be to prohibit all traffic from proceeding on Winter Hey Lane from Chorley New Rd to Emmett St, to allow electricity works to take place. Alternate route will be via Lee Lane. The Order will end after 18 months or on completion of the works whichever first occurs.

Bolton Council. 6 July 2026.
[bolton.gov.uk/trafficorders](https://www.bolton.gov.uk/trafficorders)

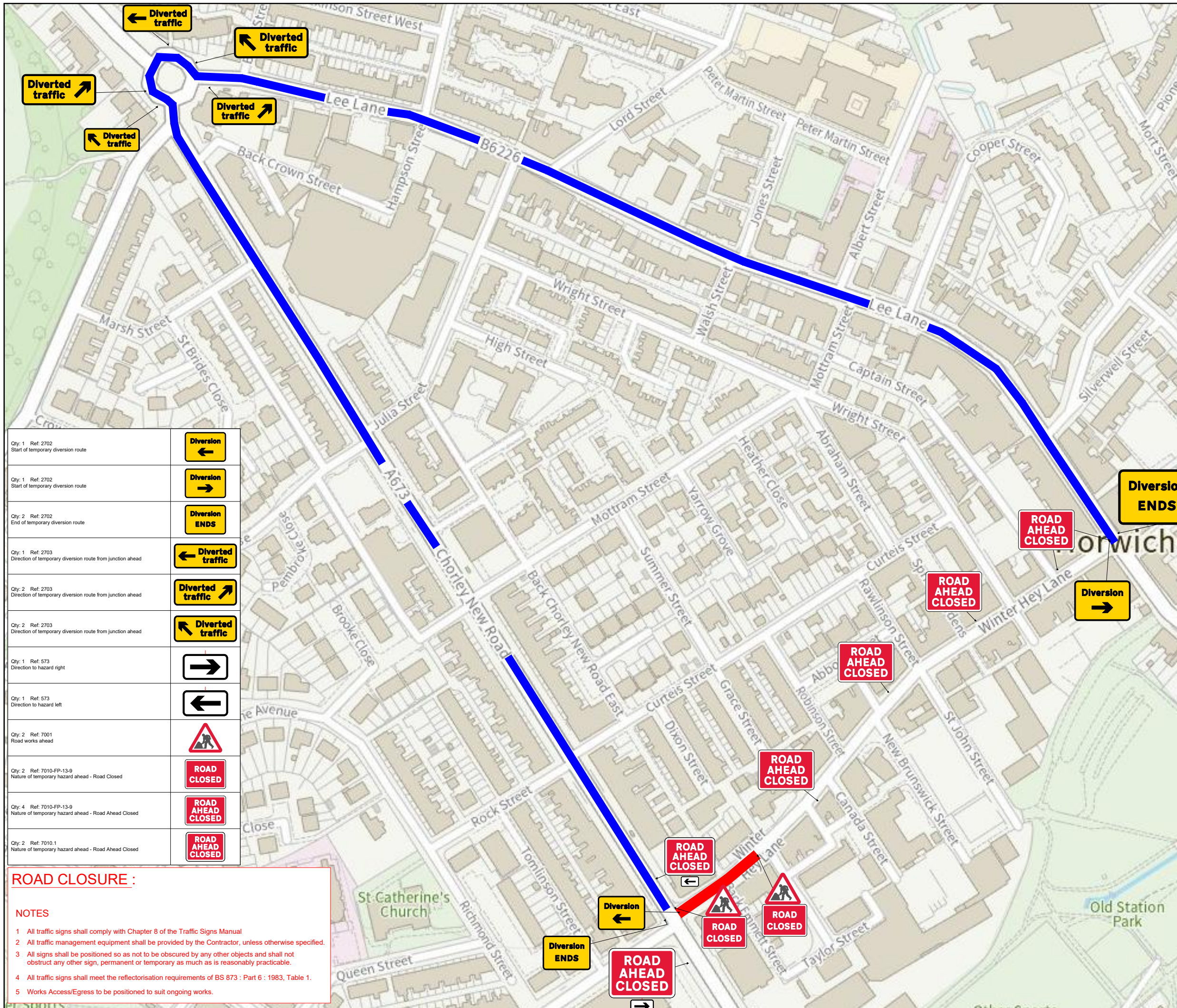

KEY	
	Pedestrian Barrier
	Traffic signal phase
	Cone
	Sign
	Portable traffic signal
	Work area
	Closed area
	Safety Zone
	Diversion Route
	Pedestrian Route
	Pedestrian ramp (Fixed to ground)
	TM Operative
	No Parking Cones
	Temporary Pedestrian Crossing

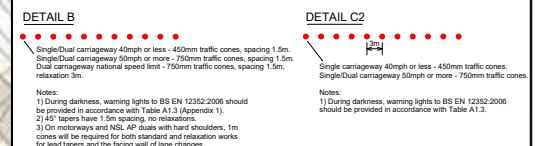
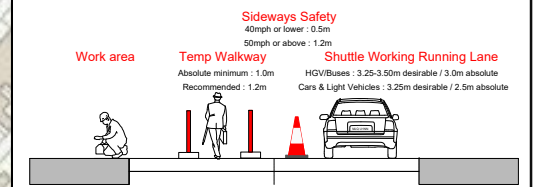

Qty: 1 Ref: 2702 Start of temporary diversion route	
Qty: 1 Ref: 2702 Start of temporary diversion route	
Qty: 2 Ref: 2702 End of temporary diversion route	
Qty: 1 Ref: 2703 Direction of temporary diversion route from junction ahead	
Qty: 2 Ref: 2703 Direction of temporary diversion route from junction ahead	
Qty: 1 Ref: 573 Direction to hazard right	
Qty: 1 Ref: 573 Direction to hazard left	
Qty: 2 Ref: 7001 Road works ahead	
Qty: 2 Ref: 7010-FP-13-9 Nature of temporary hazard ahead - Road Closed	
Qty: 4 Ref: 7010-FP-13-9 Nature of temporary hazard ahead - Road Ahead Closed	
Qty: 2 Ref: 7010.1 Nature of temporary hazard ahead - Road Ahead Closed	

ROAD CLOSURE :

NOTES

- All traffic signs shall comply with Chapter 8 of the Traffic Signs Manual
- All traffic management equipment shall be provided by the Contractor, unless otherwise specified.
- All signs shall be positioned so as not to be obscured by any other objects and shall not obstruct any other sign, permanent or temporary as much as is reasonably practicable.
- All traffic signs shall meet the reflectorisation requirements of BS 873 : Part 6 : 1983, Table 1.
- Works Access/Egress to be positioned to suit ongoing works.

Click Pin and Map for Google Maps link
EASTINGS & NORTHINGS:
363737 , 411403



Client
openreach

Works Description
HEAVY CABLE RECOVERY

Address
92, Winter Hey Lane, Horwich, Bolton,
Greater Manchester, England, BL6

TM Type
ROAD CLOSURE DIVERSION

Design: M.MCSTEIN	Drawn: M.MCSTEIN	Chkd: A.B
Date: 16/10/25	Date: 16/10/25	Date: 16/10/25
Scale: NTS	Status: DRAFT	Revision: N/A

Drawing No
67-1900-0005076 – E CABLE – HORWICH –
50-6000.003

Road Speed