

**THE BOROUGH COUNCIL OF BOLTON  
ADOPTION OF ROADS INTO THE PUBLIC HIGHWAY  
HIGHWAYS ACT 1980 - SECTION 278**

**DECLARATION**

I, Dwayne Lowe, Assistant Director of Highways & Planning, pursuant to the powers delegated to me for and on behalf of the Borough Council of Bolton, hereby declare the street(s) named below, having been made up to the appropriate standard, to be highway(s) maintainable at the public expense and to be recorded as such in the register of adopted streets, as of 5 June 2026.

This adoption is pursuant to Section 278 of the Highways Act 1980.

**SCHEDULE**

<i>Name of Street &amp; USRN</i>	<i>Description</i>	<i>Approximate Length</i>
<b>LOCOMOTIVE WAY, HORWICH</b>  (PART)  USRN: 3406758	From its junction with Station Road, for an approximate distance of 260 metres in an east-northeasterly direction.  An area as shown on drawing number 317713-ADP1	260 metres

SIGNED:

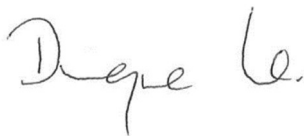

DATE:

**23 June 2026**

.....  
Dwayne Lowe CEng FCIHT FIHE  
Deputy Director of Place

Highways & Engineering Division  
Paderborn House  
Civic Centre  
Bolton BL1 1UA

**Bolton  
Council**

26/317713/ADO1/PDH

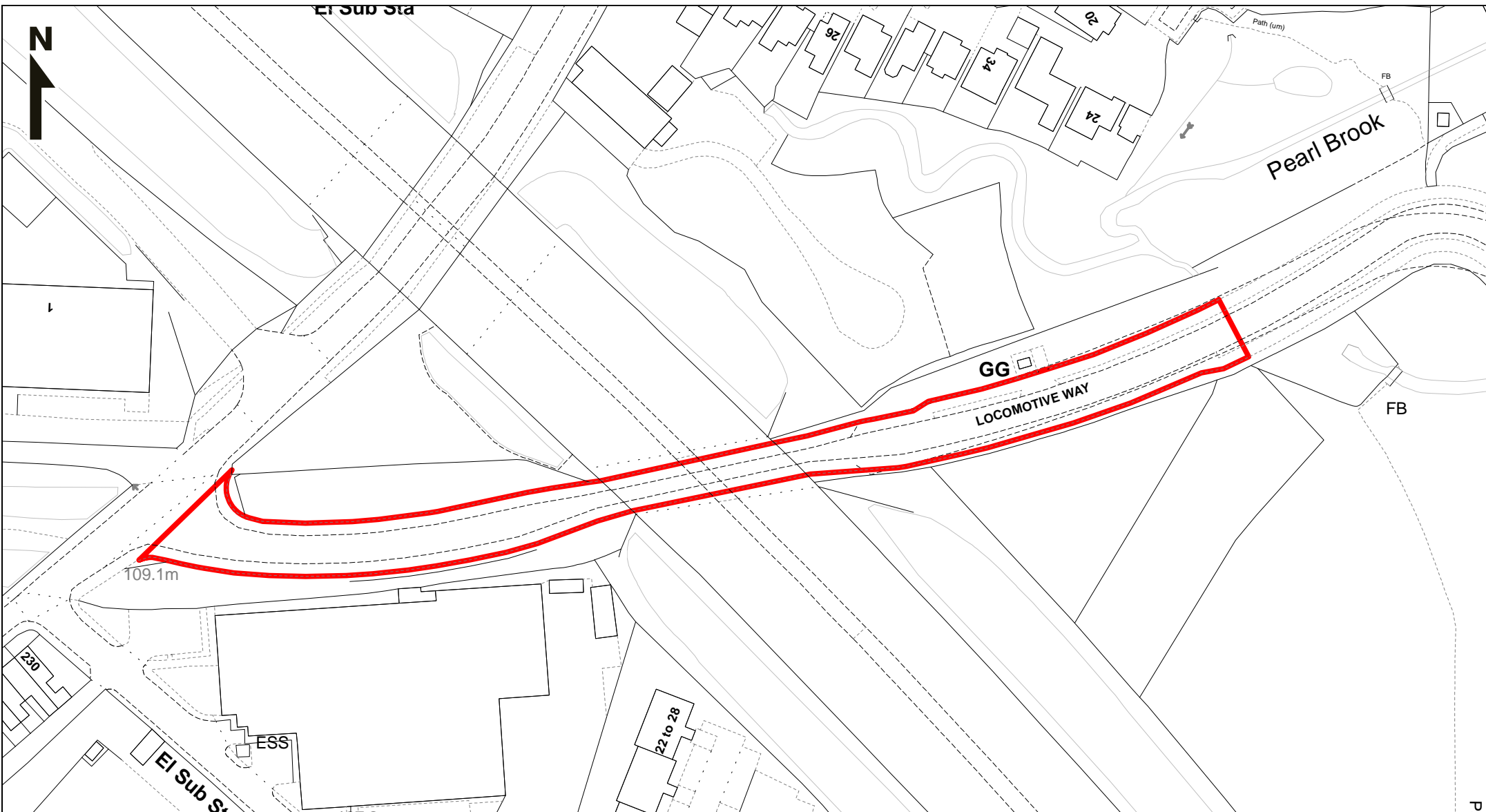

Based upon the Ordnance Survey mapping with the permission of the Controller of Her Majesty's Stationary Office © Crown Copyright  
 Unauthorised reproduction may lead to prosecution. Bolton Council Licence No 10019389/2026

**Bolton Council**  
 Highways & Engineering  
 Bolton Council  
 Paderborn House  
 Civic Centre  
 Bolton BL1 1UA

Jon Dyson  
 Director of Place

**ADOPTION OF ROADS INTO THE PUBLIC HIGHWAY  
 HIGHWAYS ACT 1980 - SECTION 278**

**HIGHWAY TO BE ADOPTED**  
 **Locomotive Way, Horwich  
 (PART)  
 USRN: 3406758**

Scale	1:1250 at A4
Drawn By	PDHouse
Date	05 JUN 2026
Dwg No.	317713-ADP1