

PUBLIC NOTICE



**THE BOROUGH COUNCIL OF BOLTON
ROAD TRAFFIC REGULATION ACT 1984 S14
BRIDGEWATER AVENUE, BOLTON
TEMPORARY TRAFFIC REGULATION NOTICE 2026**

The Borough Council of Bolton hereby enacts the temporary prohibition of right turn on Bridgewater Avenue for vehicles travelling northbound towards the roundabout junction with Cutacre Way and Leadbeaters Lane, from this date and for approximately 5 days, in exercise of its powers under Section 14 of The Road Traffic Regulation Act 1984.

The effect of this Notice will be to prohibit all vehicular traffic from turning right at the above mentioned location.

The closure is necessary because electricity works are being, or are proposed to being, executed on or near the road.

12 June 2026

Assistant Director of Highways & Planning
Town Hall, Bolton BL1 1RU

[bolton.gov.uk/highways](https://www.bolton.gov.uk/highways)

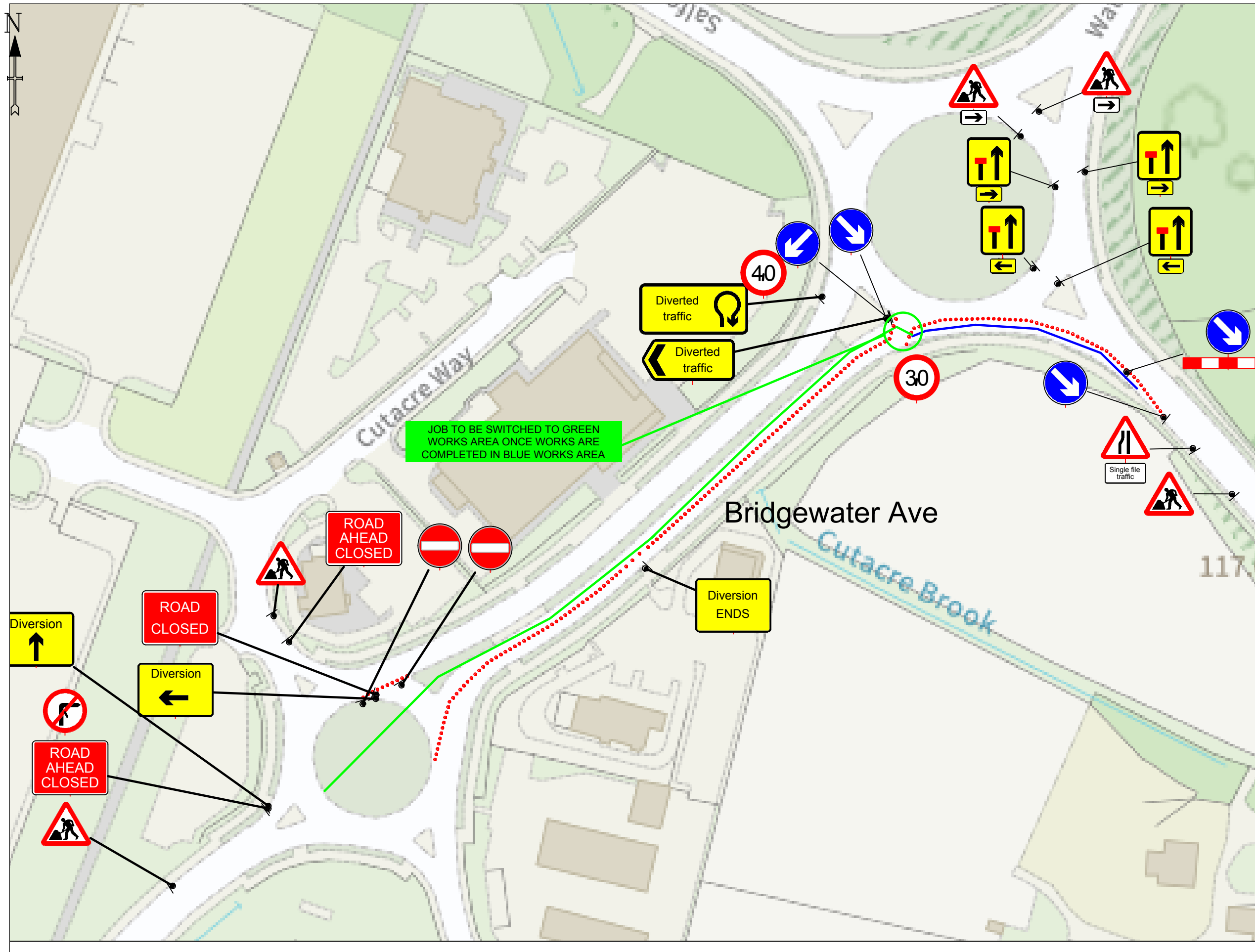

JOB TO BE SWITCHED TO GREEN WORKS AREA ONCE WORKS ARE COMPLETED IN BLUE WORKS AREA

DETAIL B (B)

Single/Dual carriageway 40mph or less - 450mm traffic cones, spacing 1.5m.
 Single/Dual carriageway 50mph or more - 750mm traffic cones, spacing 1.5m.
 Dual carriageway national speed limit - 750mm traffic cones, spacing 1.5m, relaxation 3m.

Notes:
 1) During darkness, warning lights to BS EN 12352:2006 should be provided in accordance with Table A1.3 (Appendix 1).
 2) 45° tapers have 1.5m spacing, no relaxations.
 3) On motorways and NSL AP duals with hard shoulders, 1m cones will be required for both standard and relaxation works for lead tapers and the facing wall of lane changes.

DETAIL D (D)

Single/Dual carriageway 40mph or less - 450mm traffic cones.
 Single/Dual carriageway 50mph or more - 750mm traffic cones.

Notes:
 1) During darkness, warning lights to BS EN 12352:2006 should be provided in accordance with Table A1.3 (Appendix 1).
 2) Detail D applies only to relaxation cases.

SAFETY ZONE DIMENSIONS (S)

Permanent speed limit 30mph or less
 Sideways safety zone 0.5m
 Longways safety zone 0.5m
 (Dimensions are minima)

	Standard: Normal traffic including buses and HGVs	Restricted: Cars and light vehicles only
Two-way working	6.75 m minimum	5.5 m minimum
Shuttle working	3.25-3.50 m desirable width range 3.0 m absolute minimum	3.25 m desirable minimum width 2.5 m absolute minimum

Road Type	Single carriageway road (permanent speed limit of 30mph or less)	Single carriageway road (permanent speed limit of 50mph or more)	Dual carriageway road (permanent speed limit of 30mph or 40mph)	Dual carriageway road (permanent speed limit of 50mph or 60mph)	Dual carriageway road (national speed limit)
Rate of taper (see Note 3)	1 in 15	1 in 25	1 in 25	1 in 40	1 in 60
Taper length (m) for hazard of standard carriageway width 3.0m and 4.0m	50 80	100 150	100 150	150 200	200 300
Minimum number of cones	18 28	68 95	35 35	101 51	135 51
Minimum cone size (mm)	450	450	450	450	750
Maximum cone spacing (m)	3	3	3	1.5	1.5
Maximum warning light spacing (m)	9	9	9	9	9
Minimum cone spacing (m)	450	450	450	450	750
Maximum cone spacing (m)	9	9	9	9	9
Maximum warning light spacing (m)	9	9	9	9	9



Notes -

WORKFORCE IN ROAD SLOW

KEY

- ⊥ Traffic sign
- Traffic cone
- ← Traffic signals to Diagram 3000.1
- ▬ Working Space
- ▬ Pedestrian Barrier

TEMPORARY TRAFFIC MANAGEMENT		Issue	Date
		1	24.05.26
		Drawn By	MM

LANE CLOSURE & ROAD CLOSURE & DIVERSION
 BRIDGEWATER AVE BL5 1FN PART 1

Original drawing size A3 - NTS
 Drawing Ref: ELECTRIC