

**BACK EDEN STREET  
TEMPORARY CLOSURE**

THE BOROUGH COUNCIL OF BOLTON  
ROAD TRAFFIC REGULATION ACT 1984 S.14

The Council intends to make an order, operative from 22 June 2026 for 5 days approx, the effect of which will be to prohibit all traffic from proceeding on Back Eden Street, for 10m at its junction with Old Rd, to allow water works to take place. The Order will end after 18 months or on completion of the works whichever first occurs.

Bolton Council. 1 June 2026.  
**[bolton.gov.uk/trafficorders](https://www.bolton.gov.uk/trafficorders)**

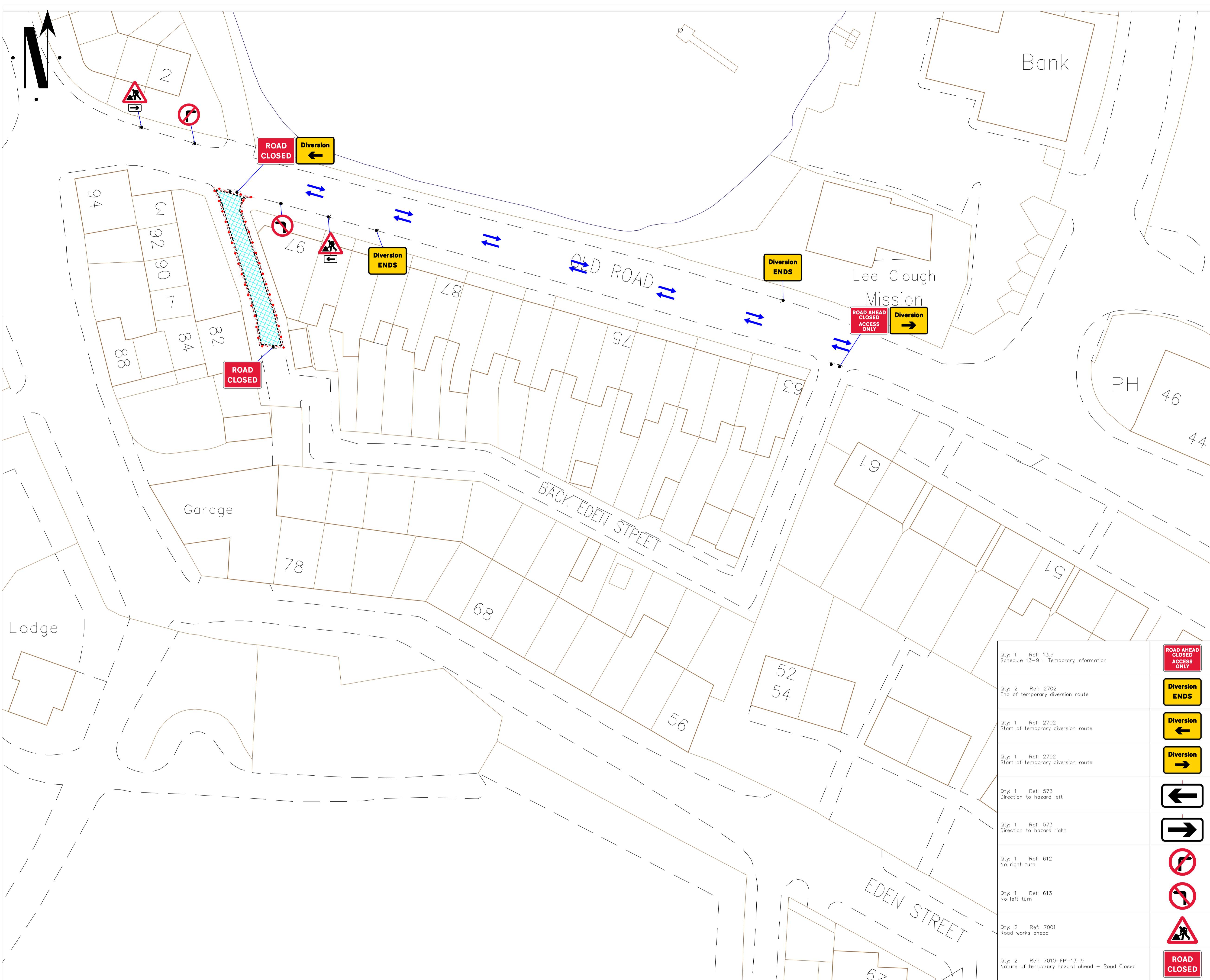

**Go Traffic Management**

This drawing has been produced for a specific client & project identified below and is not intended for use by any other person or for any other purpose. © Go Traffic Management

**Risks**

- Design completed from information provided + google maps desktop risk assessment
- Cone lamps must be used on all road with A speed limit of 40mph or more.

**Notes**

- All signs as per Chapter 8. Distances between cones to be 9m maximum unless otherwise noted.
- Distances between signs NOT to scale for purpose of clarity.
- All sign placement subject to available safe working space.
- The purpose of the Traffic Management Plan is for it to be used only as a guide and all traffic management equipment should be put out according to the 'Safety at Street Works and Road Works - Code of Practice', i.e. Red Book & the 'Traffic Signs Manual Chapter 8', i.e. Yellow Book.
- Signs must be placed in accordance with TSM and the scheme RAMS pack.
- Site conditions may have changed since the design of the drawing any changes which subsequently affect the design need to be reported by the Traffic Management Operative & any changes implemented must comply with Chapter 8.

**DETAIL B**

1. Signpost on temporary closure to read: '300m traffic cones, warning of the significant narrowing ahead' (see 'Traffic Signs Manual Chapter 8').  
 2. Signpost on temporary closure to read: '750m traffic cones, warning of the significant narrowing ahead' (see 'Traffic Signs Manual Chapter 8').  
 3. Signpost on temporary closure to read: '150m traffic cones, warning of the significant narrowing ahead' (see 'Traffic Signs Manual Chapter 8').  
 4. Signpost on temporary closure to read: '50m traffic cones, warning of the significant narrowing ahead' (see 'Traffic Signs Manual Chapter 8').  
 5. Signpost on temporary closure to read: '25m traffic cones, warning of the significant narrowing ahead' (see 'Traffic Signs Manual Chapter 8').  
 6. Signpost on temporary closure to read: '10m traffic cones, warning of the significant narrowing ahead' (see 'Traffic Signs Manual Chapter 8').  
 7. Signpost on temporary closure to read: '5m traffic cones, warning of the significant narrowing ahead' (see 'Traffic Signs Manual Chapter 8').  
 8. Signpost on temporary closure to read: '2.5m traffic cones, warning of the significant narrowing ahead' (see 'Traffic Signs Manual Chapter 8').  
 9. Signpost on temporary closure to read: '1.25m traffic cones, warning of the significant narrowing ahead' (see 'Traffic Signs Manual Chapter 8').  
 10. Signpost on temporary closure to read: '0.625m traffic cones, warning of the significant narrowing ahead' (see 'Traffic Signs Manual Chapter 8').

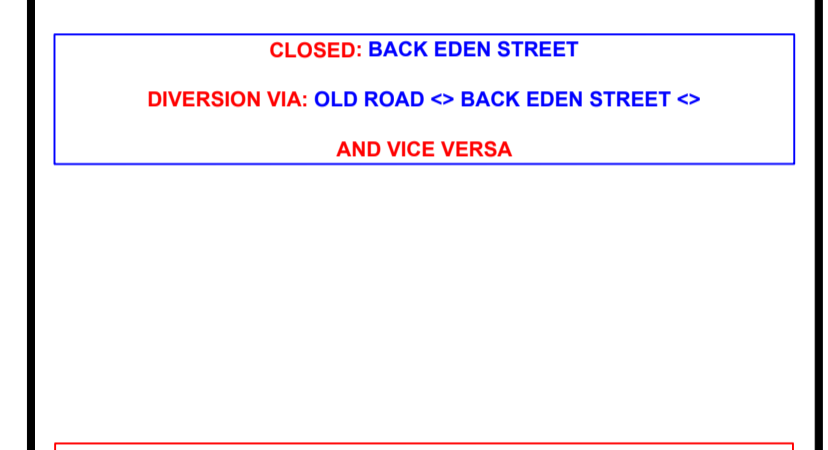
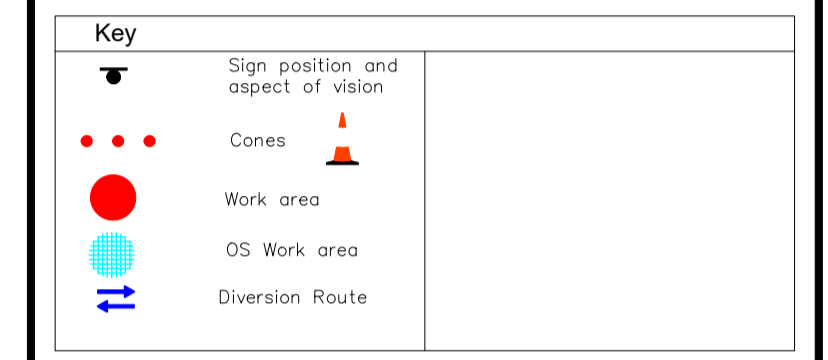

Traffic Management must comply with The Safety at Street Works and Road Works Code of Practice

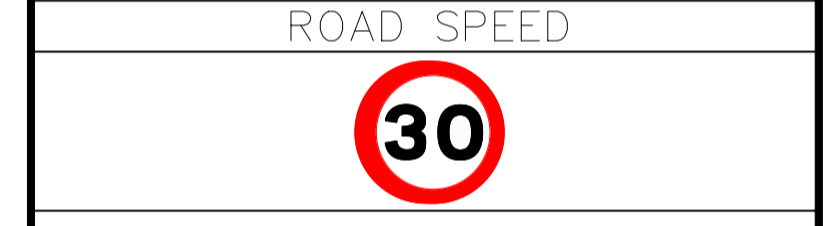

DO NOT SCALE FROM THIS DRAWING.

REV.	DATE	DESCRIPTION
A	18/03/26	AS DRAWN

**GTM**  
Go Traffic Management

Head Office: Go Traffic Management,  
Chaddock Lane, Worsley, Manchester, M28 1XW  
Tel: 0161 351 5370  
www.gtm.co.uk

**TRAFFIC MANAGEMENT PLAN**

Client: Network Plus

Drawing Number: 1723006.0001

Drawing Title: Back Eden Street, Bolton, BL1 6PU

Name:	Design:	Technical Officer:	REV:
	L. Whittingham	M. Gardiner	A
Signature:			
Date:	18/03/26	18/03/26	

Qty: 1 Ref: 13.9 Schedule 13-9 : Temporary Information	
Qty: 2 Ref: 2702 End of temporary diversion route	
Qty: 1 Ref: 2702 Start of temporary diversion route	
Qty: 1 Ref: 2702 Start of temporary diversion route	
Qty: 1 Ref: 573 Direction to hazard left	
Qty: 1 Ref: 573 Direction to hazard right	
Qty: 1 Ref: 612 No right turn	
Qty: 1 Ref: 613 No left turn	
Qty: 2 Ref: 7001 Road works ahead	
Qty: 2 Ref: 7010-FP-13-9 Nature of temporary hazard ahead - Road Closed	