

DEANE CHURCH LANE TEMPORARY CLOSURE

THE BOROUGH COUNCIL OF BOLTON
ROAD TRAFFIC REGULATION ACT 1984 S.14

The Council intends to make an order, operative from 18 June 2026 for 5 days approx, the effect of which will be to prohibit all traffic from proceeding Deane Church Lane from St Helens Rd to Back Jubilee St to allow water works to take place. Alternative route is via Hulton Lane, Wigan Rd. The Order will end after 18 months or on completion of the works whichever first occurs.

Bolton Council. 28 May 2026.
[bolton.gov.uk/trafficorders](https://www.bolton.gov.uk/trafficorders)

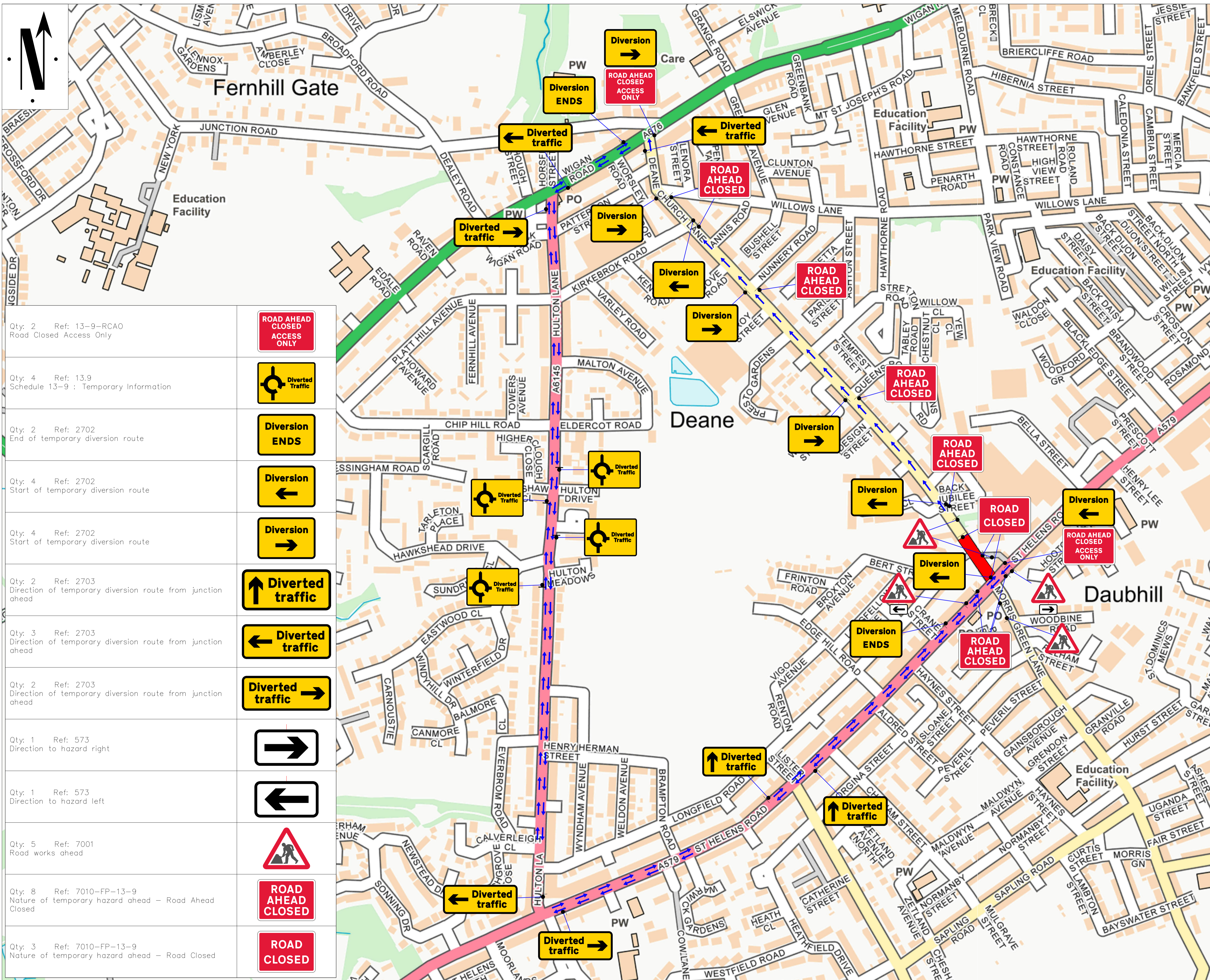

Qty: 2 Ref: 13-9-RCAO Road Closed Access Only	
Qty: 4 Ref: 13,9 Schedule 13-9 : Temporary Information	
Qty: 2 Ref: 2702 End of temporary diversion route	
Qty: 4 Ref: 2702 Start of temporary diversion route	
Qty: 4 Ref: 2702 Start of temporary diversion route	
Qty: 2 Ref: 2703 Direction of temporary diversion route from junction ahead	
Qty: 3 Ref: 2703 Direction of temporary diversion route from junction ahead	
Qty: 2 Ref: 2703 Direction of temporary diversion route from junction ahead	
Qty: 1 Ref: 573 Direction to hazard right	
Qty: 1 Ref: 573 Direction to hazard left	
Qty: 5 Ref: 7001 Road works ahead	
Qty: 8 Ref: 7010-FP-13-9 Nature of temporary hazard ahead - Road Ahead Closed	
Qty: 3 Ref: 7010-FP-13-9 Nature of temporary hazard ahead - Road Closed	

Go Traffic Management

This drawing has been produced for a specific client & project identified below and is not intended for use by any other person or for any other purpose. © Go Traffic Management

Risks:

- Design completed from information provided + google maps desktop risk assessment
- Cone lamps must be used on all road with A speed limit of 40mph or more.

Notes:

- All signs as per Chapter 8. Distances between cones to be 9m maximum unless otherwise noted.
- Distances between signs NOT to scale for purpose of clarity.
- All sign placement subject to available safe working space.
- The purpose of the Traffic Management Plan is for it to be used only as a guide and all traffic management equipment should be put out according to the 'Safety at Street Works and Road Works - Code of Practice', i.e. Red Book & the 'Traffic Signs Manual Chapter 8', i.e. Yellow Book.
- Signs must be placed in accordance with TSM and the scheme RAMS pack.
- Site conditions may have changed since the design of the drawing any changes which subsequently affect the design need to be reported by the Traffic Management Operative & any changes implemented must comply with Chapter 8.

Key

- Sign position and aspect of vision
- Work Space
- Diversion

Deane Church Lane Closed

Traffic to be diverted via:

A579 St Helens Road <-> A6145 Hulton Lane <-> A676 Wigan Road and vice versa

Minimum 0.5m Sideways & 0.5m Longways Safety Zone must be adhered to.

Traffic Management must comply with The Safety at Street Works and Road Works Code of Practice

ROAD SPEED

30

Road Closure

DO NOT SCALE FROM THIS DRAWING.	As Drawn
ORIGINAL 20-03-26	xxx
REV. A	xxx
REV. B	xxx

GTM

Go Traffic Management

Head Office: Go Traffic Management, Chaddock Lane, Worsley, Manchester, M28 1XW
Tel: 0161 351 5370
www.gtm.co.uk

CERTIFIED
 ISO 9001:2015
 01545 18001

TRAFFIC MANAGEMENT PLAN

Client: **Network Plus**

Drawing Number: 1725716.01

Drawing Title: Deane Church Lane, Bolton, BL3 4ED

Design:	Technical Officer:	REV:
Name: J.Bennett		
Signature:		
Date: 20-03-2026		