

## **HIGHER MARKET ST. FARNWORTH TEMPORARY CLOSURE**

THE BOROUGH COUNCIL OF BOLTON  
ROAD TRAFFIC REGULATION ACT 1984 S.14

The Council intends to make an order, operative from 11 June 2026 for 1 day approx, the effect of which will be to prohibit all traffic from proceeding on Higher Market Street from Frederick St to Mather St to allow manhole repairs to take place. Alternate route will be via Longcauseway, Albert Rd, Gladstone Rd. The Order will end after 18 months or on completion of the works whichever first occurs.

Bolton Council. 21 May 2026.  
**[bolton.gov.uk/trafficorders](https://bolton.gov.uk/trafficorders)**

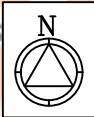

# PLEASE CLICK BELOW

<https://www.google.com/maps/d/edit?mid=16cckW47222YI1bk4dcuzJPHfNdWOP-Q&usp=sharing>

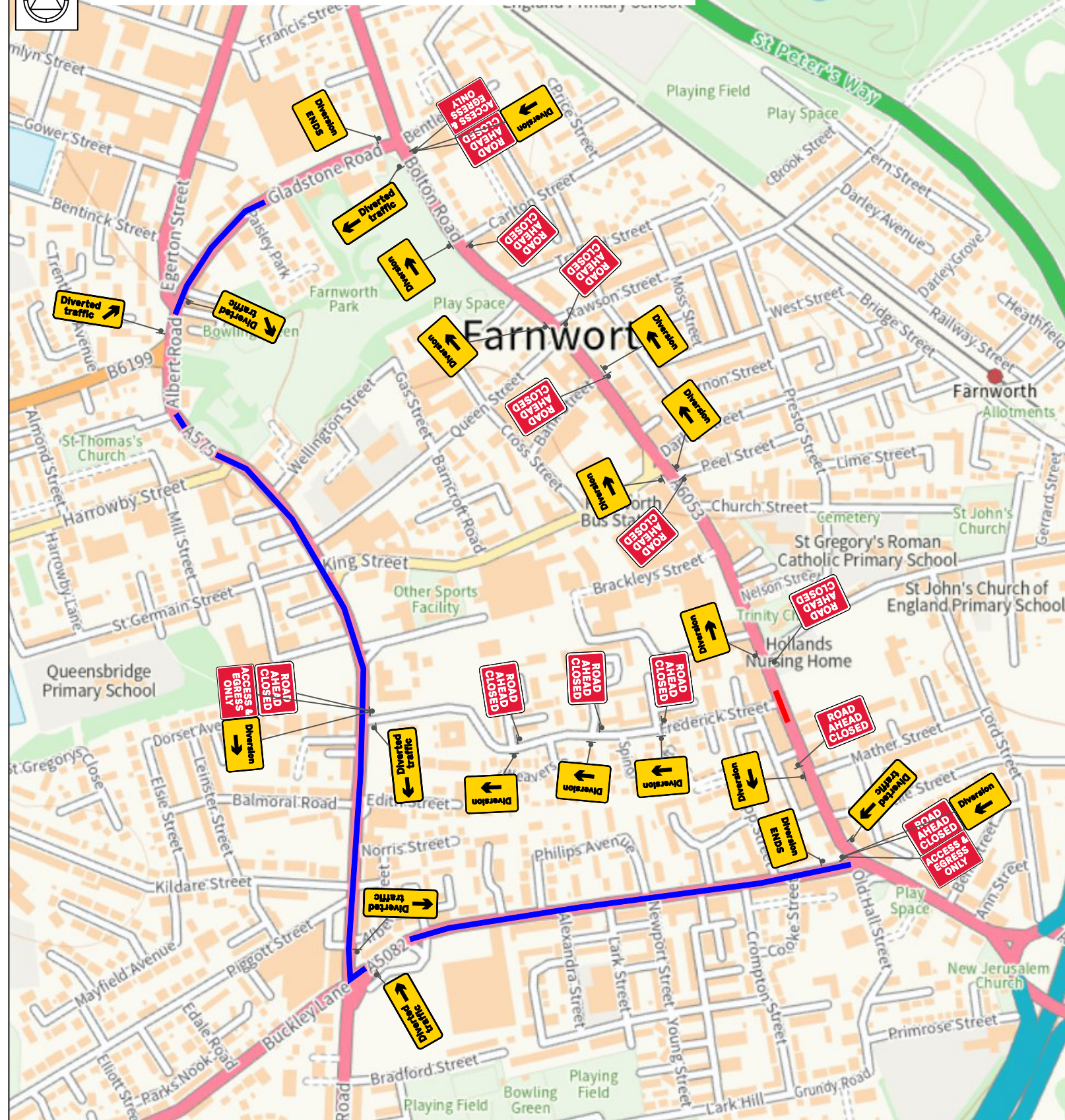

- NOTES:**
1. All signs and cones to be in accordance with Chapter 8 new roads and street works a code of practice (Red book)
  2. Works access and egress are indicative, exact locations to be agreed on site.
  3. Safety zones are to be installed as required as shown by the SAFETY ZONE DIMENSIONS BELOW
  4. All signs to be located so as not to obscure signs or objects and should be ballasted near to ground level using sand filled hessian bags or sign straps.
  5. All sign positions are indicative only and must be accurately positioned on site with good visibility and be clear of and obstructions or vegetation at all times.
  6. Drawing not to scale

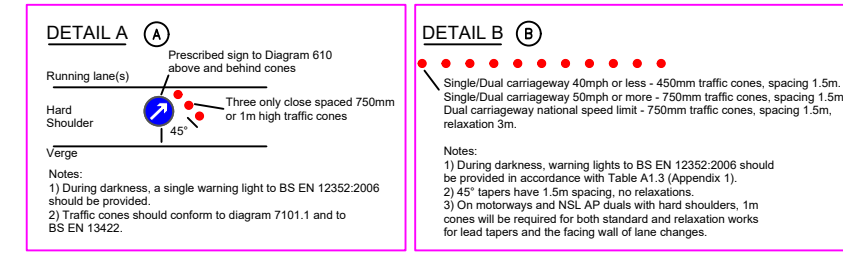

cadrequest@sus.co.uk tmbookings@sus.co.uk

|  |  |
|--|--|
| Qty: 3 Ref: 13-9<br>Schedule 13: Temporary Sign                                |  |
| Qty: 4 Ref: 2702<br>Start of temporary diversion route                         |  |
| Qty: 2 Ref: 2702<br>End of temporary diversion route                           |  |
| Qty: 9 Ref: 2702<br>Start of temporary diversion route                         |  |
| Qty: 2 Ref: 2703<br>Direction of temporary diversion route from junction ahead |  |
| Qty: 3 Ref: 2703<br>Direction of temporary diversion route from junction ahead |  |
| Qty: 1 Ref: 2703<br>Direction of temporary diversion route from junction ahead |  |
| Qty: 1 Ref: 2703<br>Direction of temporary diversion route from junction ahead |  |
| Qty: 3 Ref: 7001<br>Road works ahead   |  |
| Qty: 12 Ref: 7010.1<br>Nature of temporary hazard ahead - Road Ahead Closed    |  |
| Qty: 3 Ref: 7010.1<br>Nature of temporary hazard ahead - Road Closed           |  |

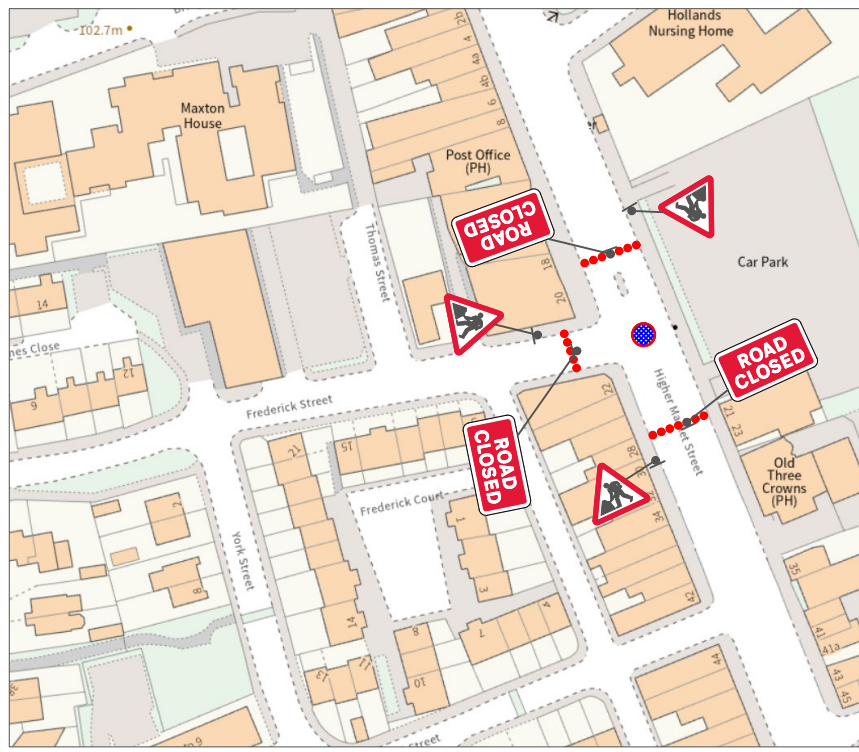

**NOTES:**

- Traffic sign
- Cone
- Work Area
- Safety Zone
- Diversion
- Diversion
- WORKS ACCESS
- WORKS EXIT

Works access/egress to be risk assessed on site for suitability of location

**SPEED OF ROAD:**

LONGWAYS: 0.5m

SIDEWAYS: 0.5m

**TRAFFIC MANAGEMENT NOTES**

**ROAD CLOSURE:**

**NOTES:**

- 1 All traffic signs shall comply with Chapter 8 of the Traffic Signs Manual
- 2 All traffic management equipment shall be provided by the Contractor, unless otherwise specified.
- 3 All signs shall be positioned so as not to be obscured by any other objects and shall not obscure any other signs, permanent or temporary as much as is reasonably practicable.
- 4 All traffic signs shall meet the reflectorisation requirements of BS 673: Part 5: 1993, Table 1.
- 5 Works Access/Egress to be positioned to suit ongoing works.

**Road Widths**

**SITE:**  
16 Higher Market St, Farnworth, Bolton BL4 9AJ

**TITLE:** ROAD CLOSURE

|                  |              |           |             |
|------------------|--------------|-----------|-------------|
| SCALE AT 13: NTS | DATE: APR 26 | DRAWN: JB | CHECKED: LS |
|------------------|--------------|-----------|-------------|

DWG NO: SUS15888

**CLIENT:**

**Water for the North West**