

RADCLIFFE ROAD TEMPORARY CLOSURE

THE BOROUGH COUNCIL OF BOLTON
ROAD TRAFFIC REGULATION ACT 1984 S.14

The Council intends to make an order, operative from 25 May 2026 for 4 weeks approx, the effect of which will be to prohibit all traffic from proceeding on Radcliffe Road from Bowstone Rise to Laurel Ave, to allow electricity works to take place. Alternative route is via Long Lane Bury New Rd, Radcliffe Moor Rd, Countess Lane, Stopes Road, High St, Market St, Ainsworth Rd, Victory Rd. The Order will end after 18 months or on completion of the works whichever first occurs.

Bolton Council. 18 May 2026.
[bolton.gov.uk/trafficorders](https://www.bolton.gov.uk/trafficorders)

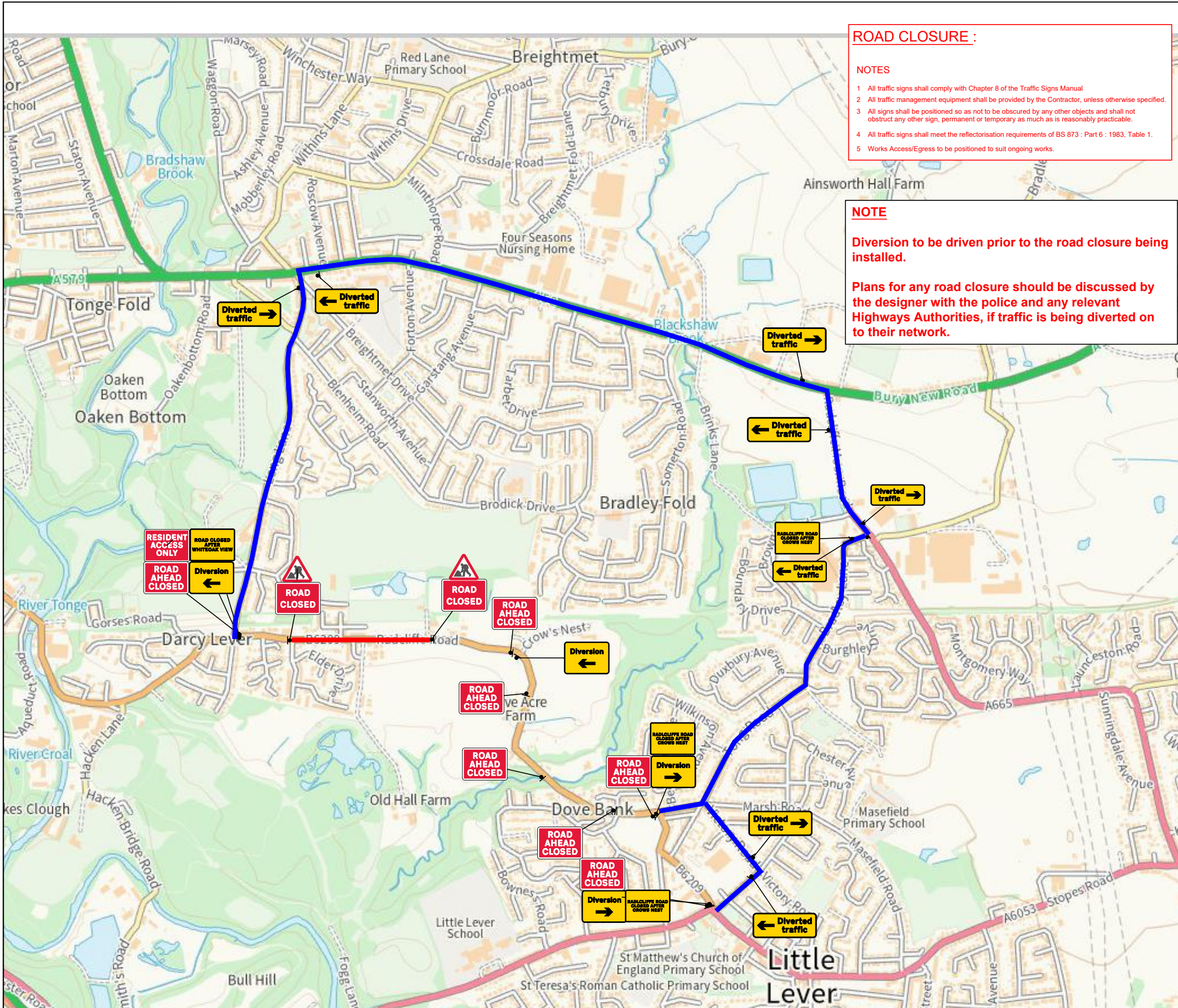

ROAD CLOSURE :

- NOTES**
- 1 All traffic signs shall comply with Chapter 8 of the Traffic Signs Manual
 - 2 All traffic management equipment shall be provided by the Contractor, unless otherwise specified.
 - 3 All signs shall be positioned so as not to be obscured by any other objects and shall not obstruct any other sign, permanent or temporary as much as is reasonably practicable.
 - 4 All traffic signs shall meet the reflectorisation requirements of BS 873 : Part 6 : 1983, Table 1.
 - 5 Works Access/Egress to be positioned to suit ongoing works.

NOTE

Diversion to be driven prior to the road closure being installed.

Plans for any road closure should be discussed by the designer with the police and any relevant Highways Authorities, if traffic is being diverted on to their network.

- NOTES**
- 1 All traffic signs shall comply with Chapter 8 of the Traffic Signs Manual
 - 2 Maximum distance between any two temporary traffic signals to be 240m. Minimum distance between any two temporary traffic signals to be 30m.
 - 3 Temporary traffic signals shall not occur within 150m of an existing level crossing. Pelican crossing or signalised junction without the consent of the Engineer. The Engineer shall consult with the authority responsible for any of these types of facility prior to traffic management being installed in adjacent areas.
 - 4 Coning shall be installed at 45° to the edge of carriageway, as generally indicated.

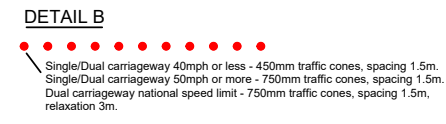

- Notes:**
- 1) During darkness, warning lights to BS EN 12352:2006 should be provided in accordance with Table A1.3 (Appendix 1).
 - 2) 45° tapers have 1.5m spacing, no relaxations.
 - 3) On motorways and NSL AP duals with hard shoulders, 1m cones will be required for both standard and relaxation works for lead tapers and the facing wall of lane changes.

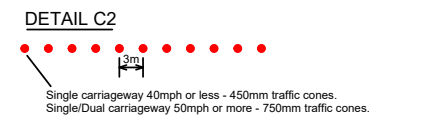

- Notes:**
- 1) During darkness, warning lights to BS EN 12352:2006 should be provided in accordance with Table A1.3.

KEY

- Cone
- ▨ Works Area
- ▨ Works Vehicle
- Sign
- Diversion Route
- Pedestrian Route
- Pedestrian Barriers

DWG 1 OF 1

Rev	Description	By	Chkd	Date



WORKS ACCESS **WORKS EXIT**

Works access/ works exit to be risk assessed on site for suitability of location

Project
 Radcliffe Road, The Haulgh, Little Lever, Bolton, Greater Manchester, BL3 1AN,

ROAD CLOSURE DIVERSION

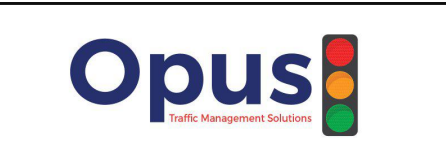

Design: MMC	Drawn: MMC	Chkd: NS
Date: 5 May 2026	Date: 5 May 2026	Date: 5 May 2026
Scale: 1:500 @ A3	Status: DRAFT	
Drawing No		Rev: