

BACK DIJON STRET TEMPORARY CLOSURE

THE BOROUGH COUNCIL OF BOLTON
ROAD TRAFFIC REGULATION ACT 1984 S.14

The Council intends to make an order, operative from 11 May 2026 for 3 days approx, the effect of which will be to prohibit all traffic from proceeding on Back Dijon Street (full length) to allow water works to take place. The Order will end after 18 months or on completion of the works whichever first occurs.

Bolton Council. 20 April 2026.
[bolton.gov.uk/trafficorders](https://www.bolton.gov.uk/trafficorders)

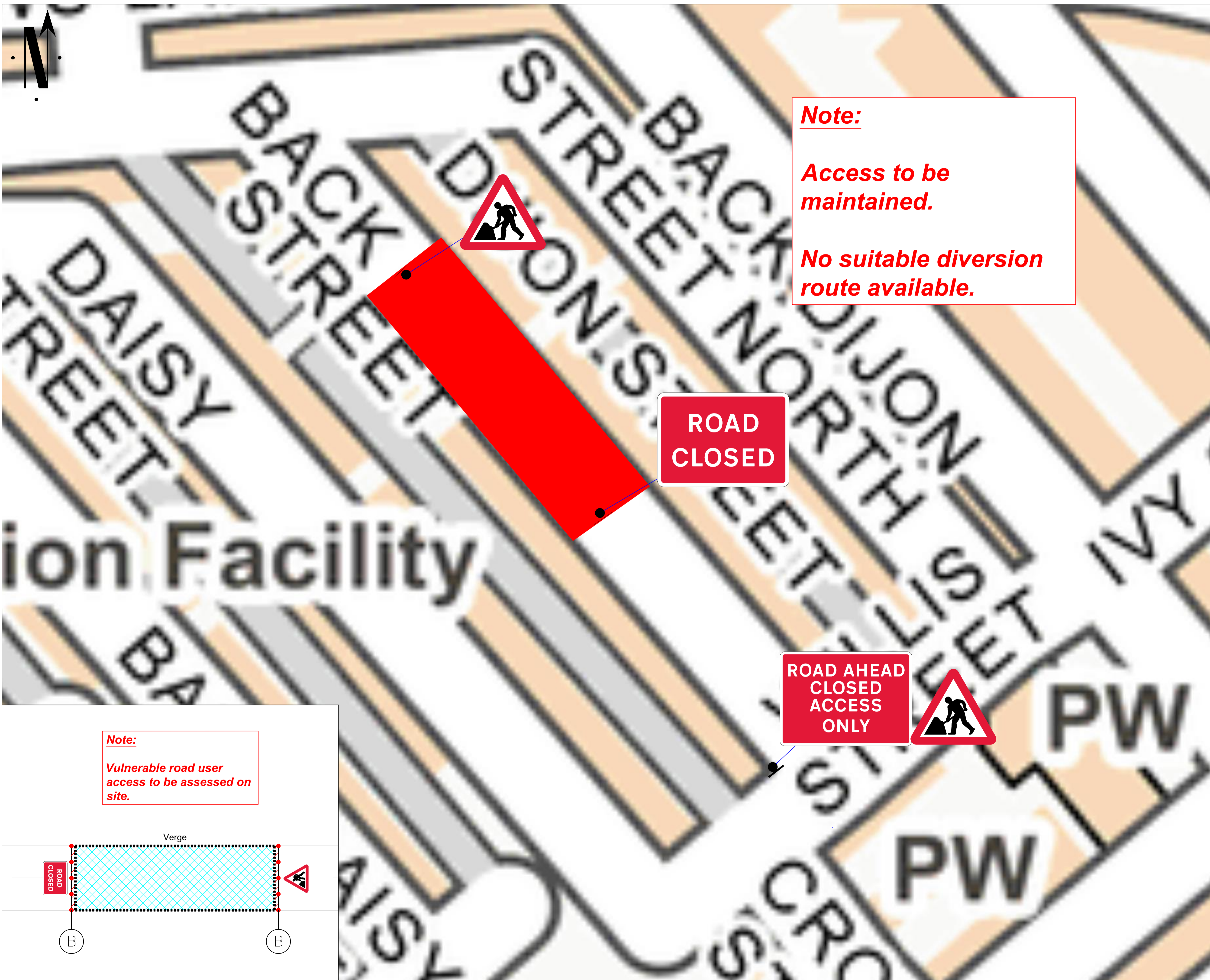

Note:
Access to be maintained.
No suitable diversion route available.

Note:
Vulnerable road user access to be assessed on site.

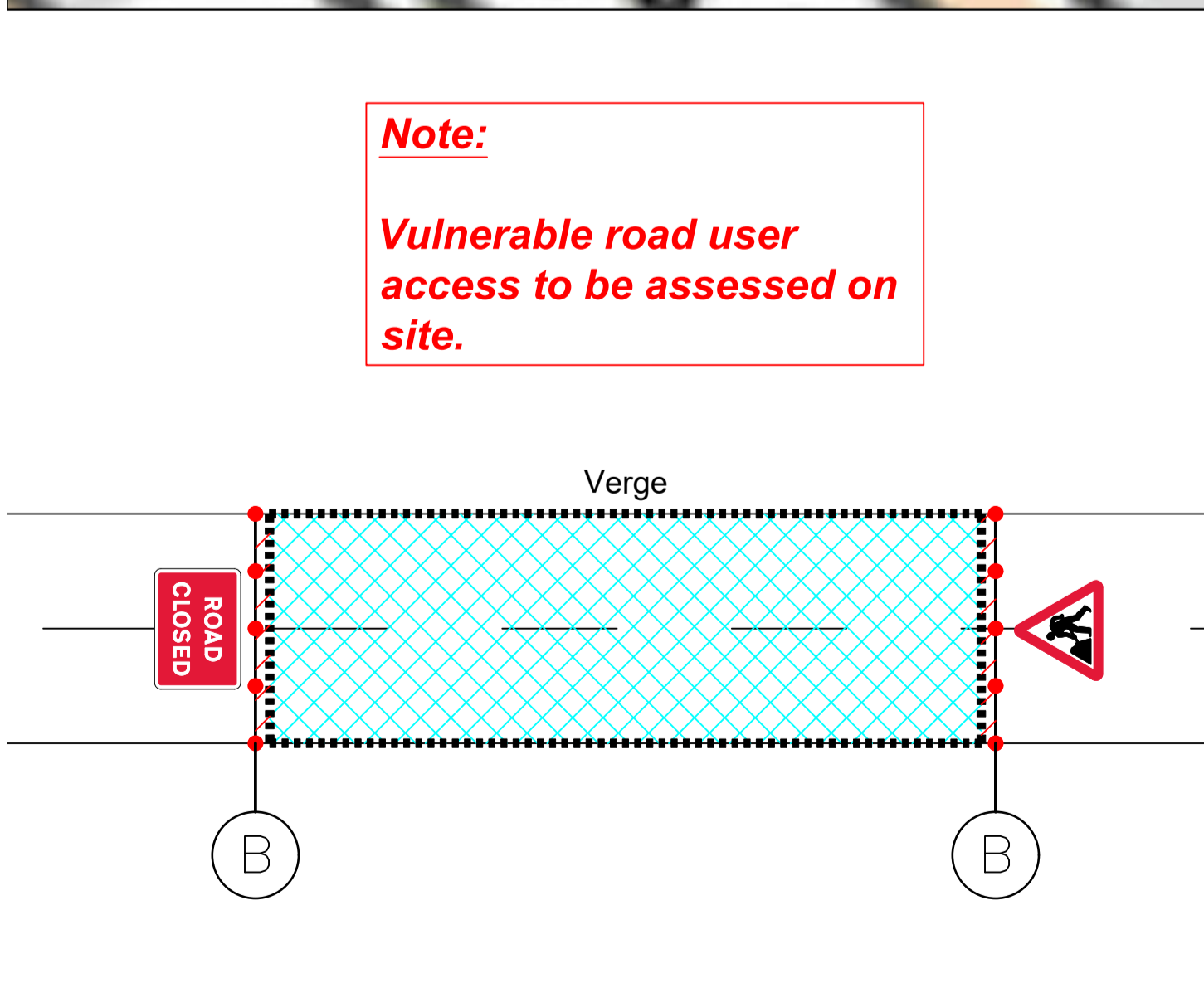

Go Traffic Management

This drawing has been produced for a specific client & project identified below and is not intended for use by any other person or for any other purpose. © Go Traffic Management

Risks

- Design completed from information provided + google maps desktop risk assessment
- Cone lamps must be used on all road with A speed limit of 40mph or more.

Notes

- All signs as per Chapter 8. Distances between cones to be 9m maximum unless otherwise noted.
- Distances between signs NOT to scale for purpose of clarity.
- All sign placement subject to available safe working space.
- The purpose of the Traffic Management Plan is for it to be used only as a guide and all traffic management equipment should be put out according to the 'Safety at Street Works and Road Works - Code of Practice', i.e. Red Book & the 'Traffic Signs Manual Chapter 8', i.e. Yellow Book.
- Signs must be placed in accordance with TSM and the scheme RAMS pack.
- Site conditions may have changed since the design of the drawing any changes which subsequently affect the design need to be reported by the Traffic Management Operative & any changes implemented must comply with Chapter 8.

Key

Sign position and aspect of vision	Work area
------------------------------------	-----------

Traffic Management must comply with The Safety at Street Works and Road Works Code of Practice

Step 1 - Ref: 133 Schedule 12-9: Temporary information	ROAD AHEAD CLOSED ACCESS ONLY
Step 2 - Ref: 700 Road works ahead	
Step 3 - Ref: 700-PP-13-9 Notice of temporary hazard ahead - Road Closed	ROAD CLOSED

ROAD SPEED

30

DO NOT SCALE FROM THIS DRAWING. **ROAD CLOSURE**

A	06/02/26	AS DRAWN
REV:	DATE	DESCRIPTION

GTM
Go Traffic Management

Head Office: Go Traffic Management,
 Chaddock Lane, Worsley, Manchester, M28 1XW
 Tel: 0161 351 5370
 www.gtm.co.uk

TRAFFIC MANAGEMENT PLAN

Client: **Network Plus**

Drawing Number: 1671841.0001

Drawing Title: Craston Street BL3 4BB

	Design:	Technical Officer:	REV:
Name:	A.Bolan	B.Greenwood	
Signature:			
Date:	06/02/26	06/02/26	