

BACK HAWTHORNE ROAD TEMPORARY CLOSURES

THE BOROUGH COUNCIL OF BOLTON
ROAD TRAFFIC REGULATION ACT 1984 S.14

The Council intends to make an order, operative from 11 May 2026 for 3 days approx, the effect of which will be to prohibit all traffic from proceeding on Back Hawthorne Road from Back Wigan Rd to Wigan Rd to allow water works to take place. The Order will end after 18 months or on completion of the works whichever first occurs.

Bolton Council. 20 April 2026.
[bolton.gov.uk/trafficorders](https://www.bolton.gov.uk/trafficorders)

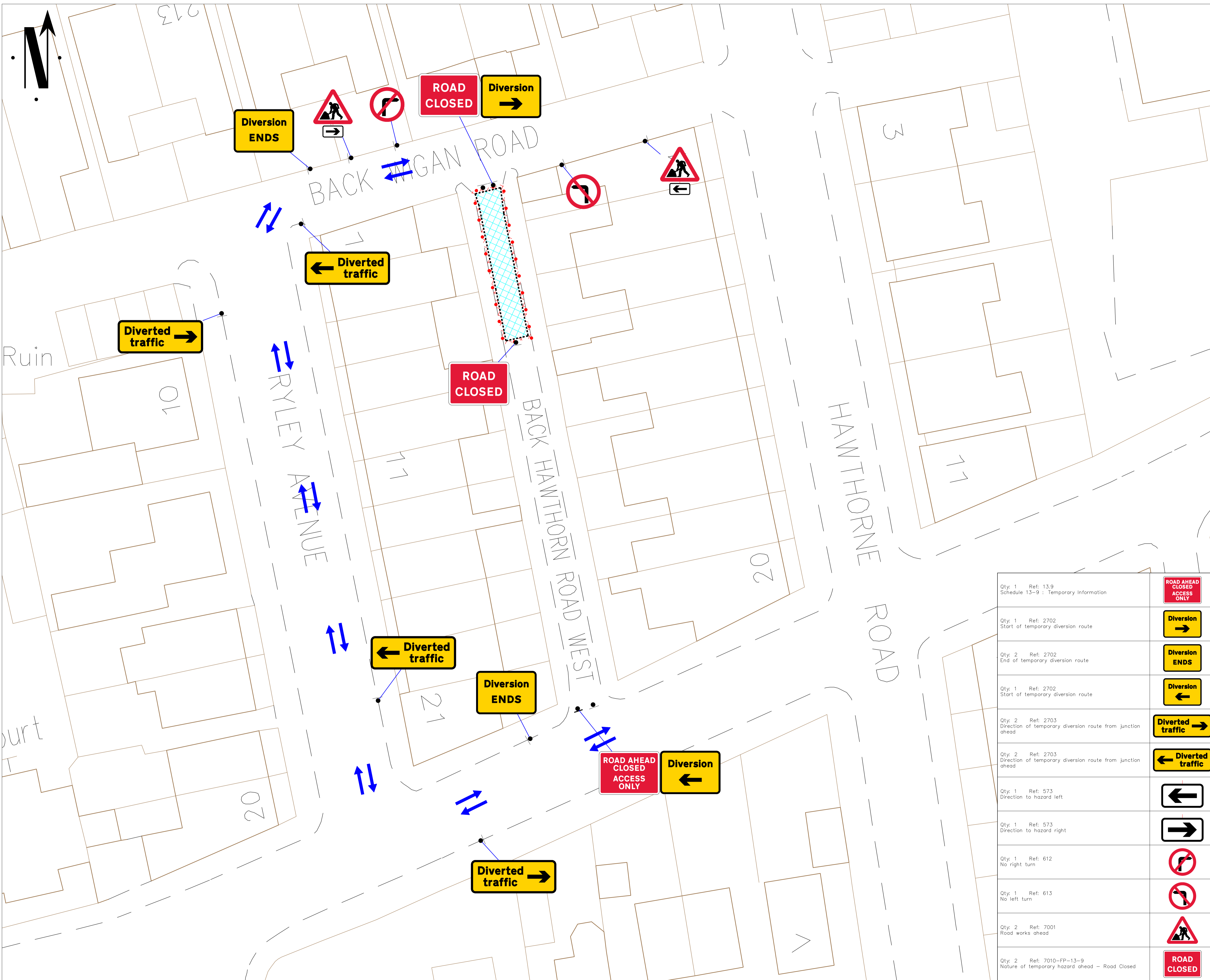

Go Traffic Management

This drawing has been produced for a specific client & project identified below and is not intended for use by any other person or for any other purpose. © Go Traffic Management

Risks

- Design completed from information provided + google maps desktop risk assessment
- Cone lamps must be used on all road with A speed limit of 40mph or more.

Notes

- All signs as per Chapter 8. Distances between cones to be 9m maximum unless otherwise noted.
- Distances between signs NOT to scale for purpose of clarity.
- All sign placement subject to available safe working space.
- The purpose of the Traffic Management Plan is for it to be used only as a guide and all traffic management equipment should be put out according to the 'Safety at Street Works and Road Works - Code of Practice', i.e. Red Book & the 'Traffic Signs Manual Chapter 8', i.e. Yellow Book.
- Signs must be placed in accordance with TSM and the scheme RAMS pack.
- Site conditions may have changed since the design of the drawing any changes which subsequently affect the design need to be reported by the Traffic Management Operative & any changes implemented must comply with Chapter 8.

DETAIL B

1. Signpost on temporary closure to read: 'ROAD AHEAD CLOSED, leaving 2 km'.

2. Signpost on temporary closure to read: 'ROAD AHEAD CLOSED, leaving 1 km'.

3. Signpost on temporary closure to read: 'ROAD AHEAD CLOSED, leaving 500m'.

4. Signpost on temporary closure to read: 'ROAD AHEAD CLOSED, leaving 250m'.

5. Signpost on temporary closure to read: 'ROAD AHEAD CLOSED, leaving 100m'.

6. Signpost on temporary closure to read: 'ROAD AHEAD CLOSED, leaving 50m'.

7. Signpost on temporary closure to read: 'ROAD AHEAD CLOSED, leaving 25m'.

8. Signpost on temporary closure to read: 'ROAD AHEAD CLOSED, leaving 10m'.

9. Signpost on temporary closure to read: 'ROAD AHEAD CLOSED, leaving 5m'.

10. Signpost on temporary closure to read: 'ROAD AHEAD CLOSED, leaving 2m'.

11. Signpost on temporary closure to read: 'ROAD AHEAD CLOSED, leaving 1m'.

12. Signpost on temporary closure to read: 'ROAD AHEAD CLOSED, leaving 500m'.

13. Signpost on temporary closure to read: 'ROAD AHEAD CLOSED, leaving 250m'.

14. Signpost on temporary closure to read: 'ROAD AHEAD CLOSED, leaving 100m'.

15. Signpost on temporary closure to read: 'ROAD AHEAD CLOSED, leaving 50m'.

16. Signpost on temporary closure to read: 'ROAD AHEAD CLOSED, leaving 25m'.

17. Signpost on temporary closure to read: 'ROAD AHEAD CLOSED, leaving 10m'.

18. Signpost on temporary closure to read: 'ROAD AHEAD CLOSED, leaving 5m'.

19. Signpost on temporary closure to read: 'ROAD AHEAD CLOSED, leaving 2m'.

20. Signpost on temporary closure to read: 'ROAD AHEAD CLOSED, leaving 1m'.

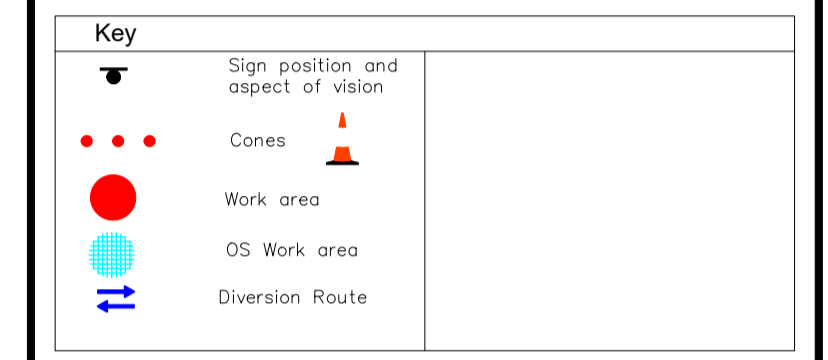

CLOSED: BACK HAWTHORN ROAD WEST

DIVERSION VIA: BACK HAWTHORN ROAD WEST -> MOUNT ST JOSEPHS ROAD -> RYLEY AVE -> BACK WIGAN ROAD -> AND VICE VERSA

Traffic Management must comply with The Safety at Street Works and Road Works Code of Practice

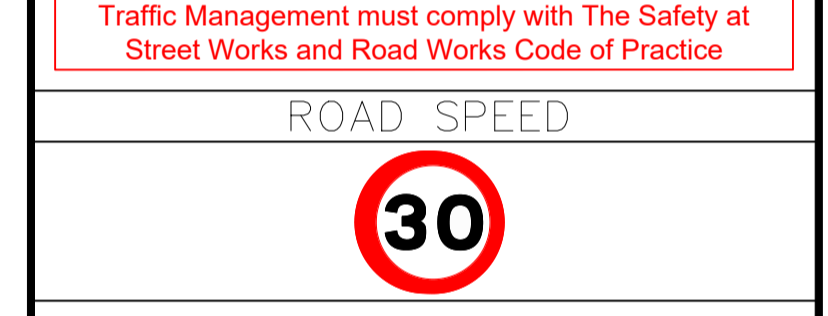

Qty: 1	Ref: 13.9	Schedule 13-9 : Temporary Information	
Qty: 1	Ref: 2702	Start of temporary diversion route	
Qty: 2	Ref: 2702	End of temporary diversion route	
Qty: 1	Ref: 2702	Start of temporary diversion route	
Qty: 2	Ref: 2703	Direction of temporary diversion route from junction ahead	
Qty: 2	Ref: 2703	Direction of temporary diversion route from junction ahead	
Qty: 1	Ref: 573	Direction to hazard left	
Qty: 1	Ref: 573	Direction to hazard right	
Qty: 1	Ref: 612	No right turn	
Qty: 1	Ref: 613	No left turn	
Qty: 2	Ref: 7001	Road works ahead	
Qty: 2	Ref: 7010-FP-13-9	Nature of temporary hazard ahead - Road Closed	

DO NOT SCALE FROM THIS DRAWING.

ROAD CLOSURE

A	06/02/26	AS DRAWN
REV:	DATE	DESCRIPTION

GTM
Go Traffic Management

Head Office: Go Traffic Management, Chaddock Lane, Worsley, Manchester, M28 1XW
Tel: 0161 351 5370
www.gtm.co.uk

CERTIFIED
R
ISO 9001: ISO 14001
OHASAS 18001

TRAFFIC MANAGEMENT PLAN

Client: **Network Plus**

Drawing Number: 1672059.0001

Drawing Title: Back Hawthorn Rd W, Bolton BL3 5RB

Design:	Technical Officer:	REV:
Name: L. Whittingham	M. Gardiner	A
Signature:	Date: 06/02/26	06/02/26