

LINACRE AVENUE TEMPORARY CLOSURE

THE BOROUGH COUNCIL OF BOLTON
ROAD TRAFFIC REGULATION ACT 1984 S.14

The Council intends to make an order, operative from 5 May 2026 for 1 day approx, the effect of which will be to prohibit all traffic from proceeding on Linacre Avenue between property numbers 21 and 27 due to telecoms works. Alternate route for traffic will be via Netherfield Rd, Freshfield Ave, Garswood Rd. The Order will end after 18 months or on completion of the works whichever first occurs.

Bolton Council. 14 April 2026.
[bolton.gov.uk/trafficorders](https://www.bolton.gov.uk/trafficorders)

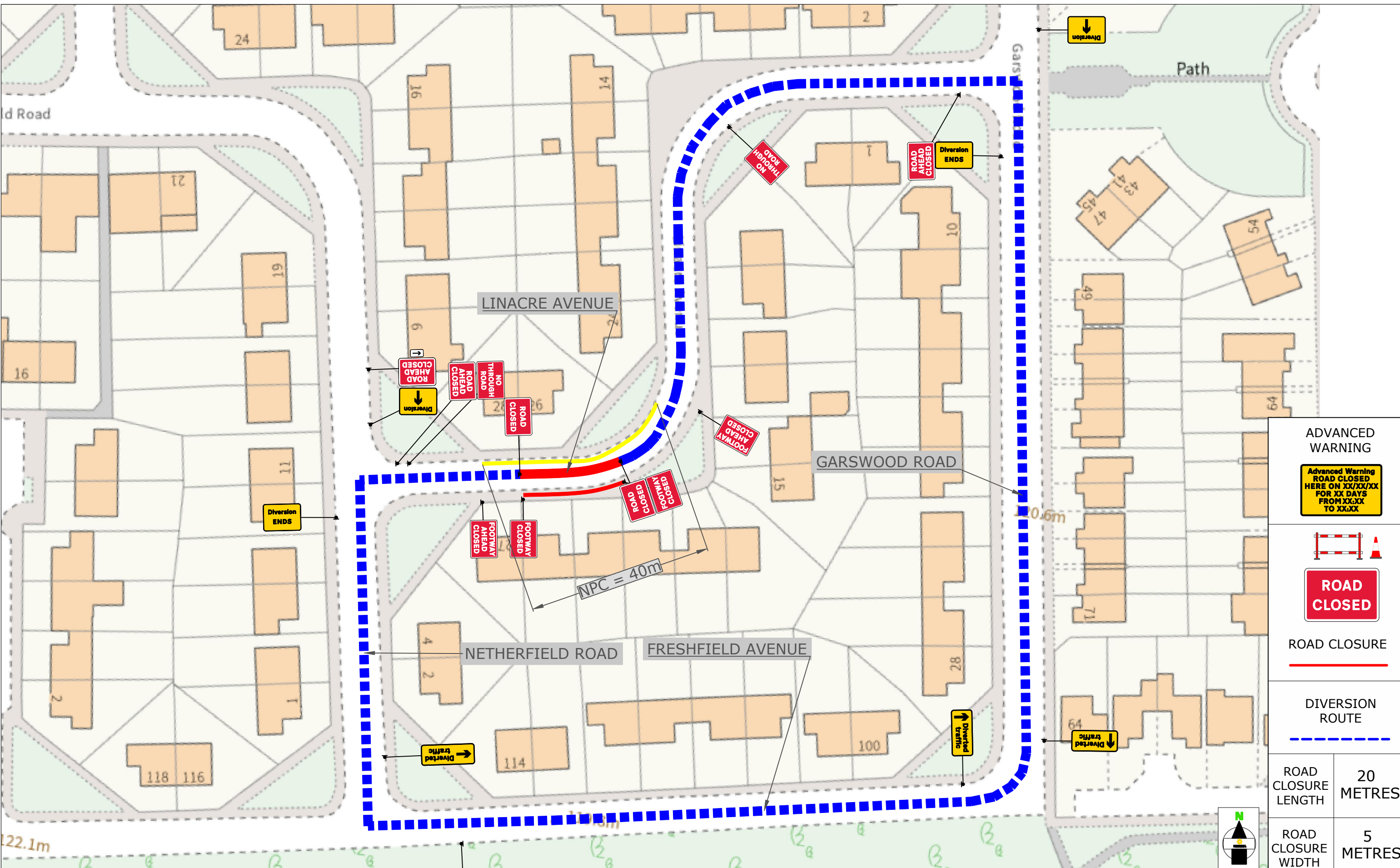

ADVANCED WARNING

Advanced Warning ROAD CLOSED HERE ON XX/XX/XX FOR XX DAYS FROM XX:XX TO XX:XX



ROAD CLOSURE

DIVERSION ROUTE

— — — — —

ROAD CLOSURE LENGTH	20 METRES
ROAD CLOSURE WIDTH	5 METRES

Contract No	209-S009988	Client: OPENREACH
Date	28/01/2026	Site Location / Drawing Title
Drawn by	GM/213	OUTSIDE 25 LINACRE AVENUE
Approved By	ND/209	BOLTON BL3 3EY
Purpose of works	TELECOM WORKS	
Version Number	01	
Amended By	XXXXXXXXXX	
Amendment Date	xx/xx/xxxx	Scale
Sheet No	1 of 1	NOT TO SCALE
	OS Licence No	000000000000

Note

- All equipment shall be approved and shall comply with the Department Of Transport specification MCE0111. This drawing does not show the normal road works signage that will be required as per Chapter 8.
- All signs to be in accordance with TSRGD 2016 and to minimum class retroreflective.
- Minimum height of lettering to be 60mm and sign boards to be 1000mm (750mm where appropriate).

The information in this drawing may not be copied or used by third parties without written consent from Sunbelt Rentals Ltd (Traffic Management).
 This layout is for installation by NRSWA, Lantra 12A,12B,12C,12D qualified persons.
 All works shall be in accordance with Safety at Street Works and Road Works, A Code of Practice 2013 & Chapter 8



THIS DOCUMENT IS UNCONTROLLED WHEN PRINTED

The electronic version of this document is the approved and most current. Any printed version is uncontrolled and may not be current.

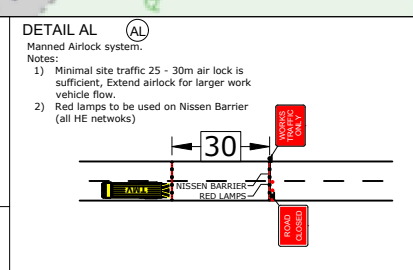

SUNBELT RENTALS

Sunbelt Rentals UK (Traffic Management)
 Kemble Airfield Enterprise Park, Cirencester Road,
 Kemble GL7 6BQ
 Telephone: 0370 050 0792