

WHITECROFT ROAD TEMPORARY CLOSURE

THE BOROUGH COUNCIL OF BOLTON
ROAD TRAFFIC REGULATION ACT 1984 S.14

The Council intends to make an order, operative from 26 January 2026 for 4 weeks approx, the effect of which will be to prohibit all traffic from proceeding on Whitecroft Road from Chorley Old Rd to Sherbourne Rd to allow construction works to take place. Alternative route will be via Markland Hill. The Order will end after 18 months or on completion of the works whichever first occurs.

Bolton Council. 9 January 2026
bolton.gov.uk/trafficorders

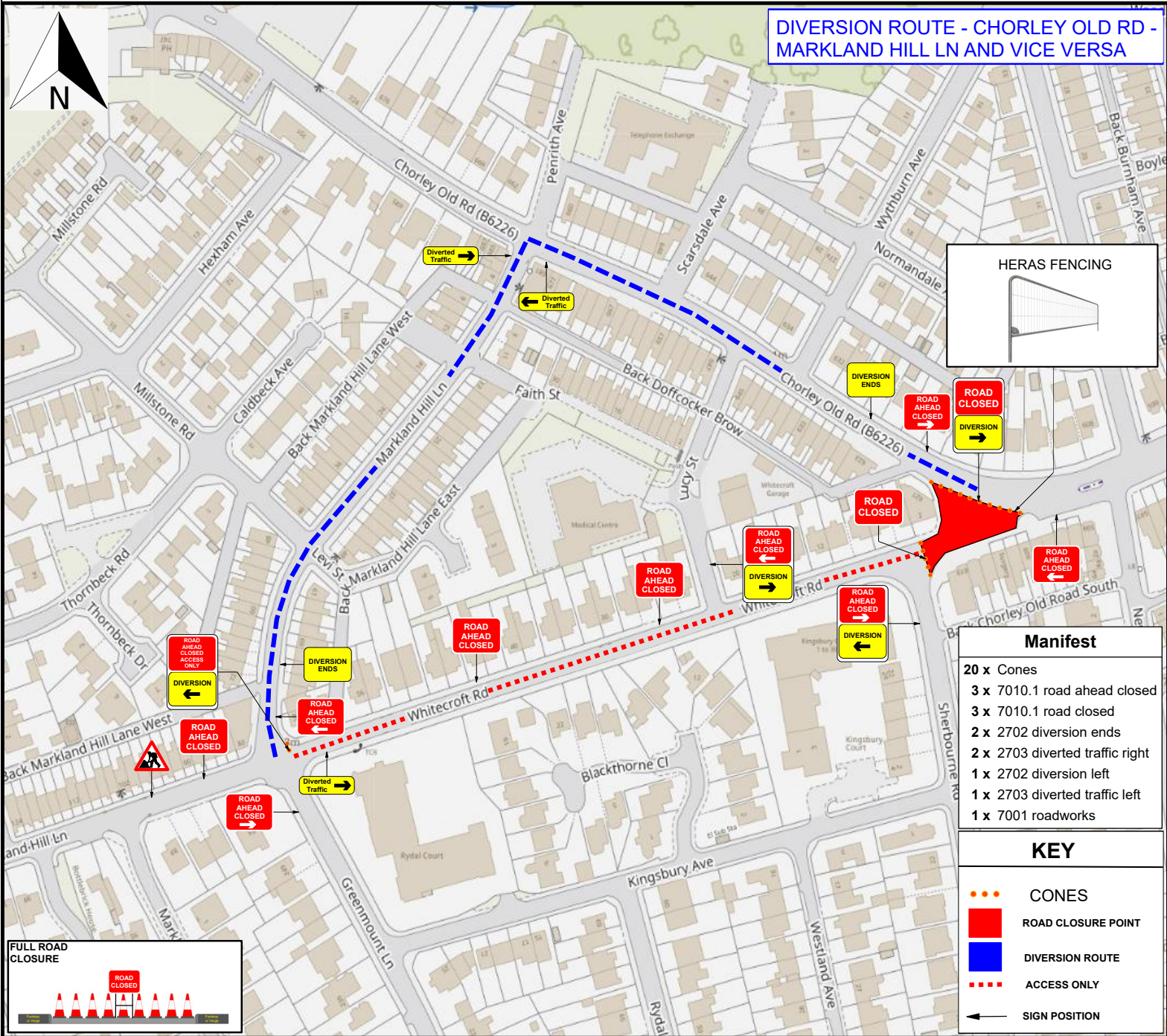

DRAWING NOT TO SCALE

ARGYLE
CIVIL ENGINEERING / SURFACING / CONSTRUCTION

ROAD SPEED

30

DRAWING DESCRIPTION
ROAD CLOSURE DIVERSION



COMMENTS -

DRAWN BY - SR	DATE - 09.12.25
CHECKED BY - JB	DATE - 09.12.25
APPROVED BY - JB	DATE - 09.12.25

Manifest

- 20 x Cones
- 3 x 7010.1 road ahead closed
- 3 x 7010.1 road closed
- 2 x 2702 diversion ends
- 2 x 2703 diverted traffic right
- 1 x 2702 diversion left
- 1 x 2703 diverted traffic left
- 1 x 7001 roadworks

MINIMUM SAFETY ZONE MUST BE ADHERED TO

MINIMUM SHUTTLE LANE WIDTHS MUST BE ADHERED TO

TRAFFIC MANAGEMENT MUST COMPLY WITH THE SAFETY AT STREET WORKS AND ROAD WORKS CODE OF PRACTICE

TRAFFIC MANAGEMENT PLAN

CLIENT -

Bolton Council

DRAWING NUMBER - SR167

SITE ADDRESS -

Whitecroft Road, Johnson Fold, BL1 5NT

WHAT3WORDS - film.earth.minus