

BACK BRANDWOOD STREET TEMPORARY CLOSURES

THE BOROUGH COUNCIL OF BOLTON
ROAD TRAFFIC REGULATION ACT 1984 S.14

The Council intends to make an order, operative from 13 January 2026 for 3 days approx, the effect of which will be to prohibit all traffic from proceeding on Back Brandwood Street from Farnworth St to Dane St to allow water works to take place. The Order will end after 18 months or on completion of the works whichever first occurs.

Bolton Council. 23 December 2025.
bolton.gov.uk/trafficorders

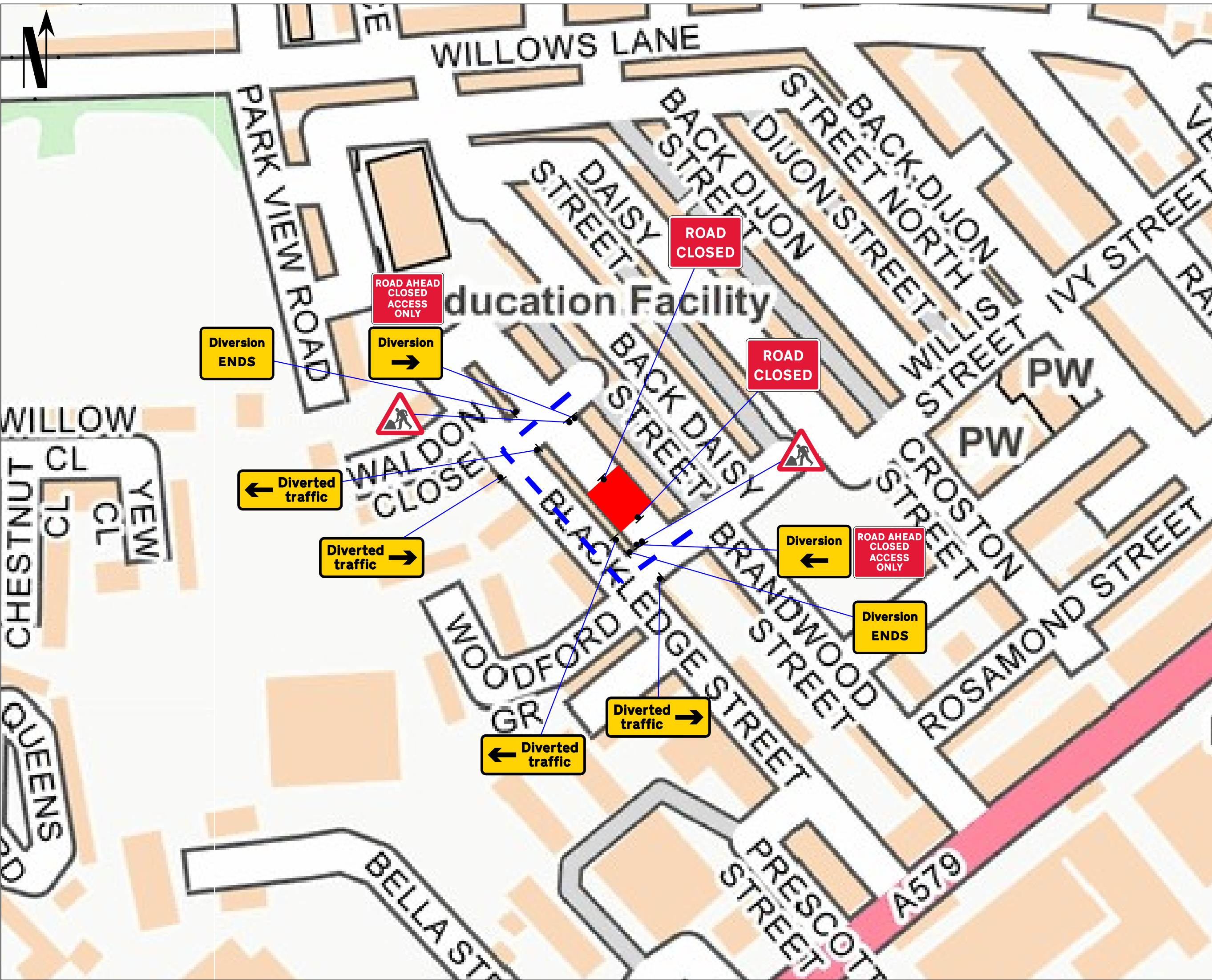

Go Traffic Management

This drawing has been produced for a specific client & project identified below and is not intended for use by any other person or for any other purpose. © Go Traffic Management

Risks

- Design completed from information provided + google maps desktop risk assessment
- Cone lamps must be used on all road with A speed limit of 40mph or more.

Notes

- All signs as per Chapter 8. Distances between cones to be 9m maximum unless otherwise noted.
- Distances between signs NOT to scale for purpose of clarity.
- All sign placement subject to available safe working space.
- The purpose of the Traffic Management Plan is for it to be used only as a guide and all traffic management equipment should be put out according to the 'Safety at Street Works and Road Works - Code of Practice', i.e. Red Book & the 'Traffic Signs Manual Chapter 8', i.e. Yellow Book.
- Signs must be placed in accordance with TSM and the scheme RAMS pack.
- Site conditions may have changed since the design of the drawing any changes which subsequently affect the design need to be reported by the Traffic Management Operative & any changes implemented must comply with Chapter 8.

Key

	Sign position and aspect of vision		Work area
			Diversion Route 1

DANE ST ↔ BLACKLEDGE ST ↔ FARNWORTH ST

Traffic Management must comply with The Safety at Street Works and Road Works Code of Practice

ROAD SPEED

30

CROSS SECTION

DO NOT SCALE FROM THIS DRAWING.		Road Closure	
A	16/10/2025	AS DRAWN	
REV.	DATE	DESCRIPTION	

GTM

Go Traffic Management

Head Office: Go Traffic Management,
Chaddock Lane, Worsley, Manchester, M28 1XW
Tel: 0161 351 5370
www.gtm.co.uk

ISO 9001:2015 ISO 14001:2015
OHSAS 18001

TRAFFIC MANAGEMENT PLAN

Client: Network Plus

Drawing Number: 1545673

Drawing Title: rear of 79 Brandwood St, Bolton BL3 4BG

	Design:	Technical Officer:	REV:
Name:	B.Greenwood	L.Carcoran	
Signature:			A
Date:	16/10/2025	16/10/2025	