

ALL SAINTS ST / BOW ST / KAY ST. TEMPORARY CLOSURES

THE BOROUGH COUNCIL OF BOLTON
ROAD TRAFFIC REGULATION ACT 1984 S.14

The Council intends to make an order, operative from 10 December 2025 for 2 weeks approx, the effect of which will be to implement the following restrictions to allow electricity works to take place. The works will be undertaken in consecutive phases.

PHASE 1 - ALL SAINTS ST / BOW ST.

ROAD CLOSURE - All Saints Street from Bow St to Bark St East.

ONE WAY TRAFFIC - Bow Street from Bridge St to All Saints St.

Alternate route: Bridge St, St Georges St, Kay St.

PHASE 2 – KAY STREET

LEFT TURN ONLY - Kay Street at its junction with Bow St.

Alternate route: Folds Rd, Bury New Rd, Castle St, Bradford St, Lower Bridgeman St, Bradshawgate, Bank St, Manor St.

The Order will end after 18 months or on completion of the works whichever first occurs.

Bolton Council. 1 December 2025.

bolton.gov.uk/trafficorders

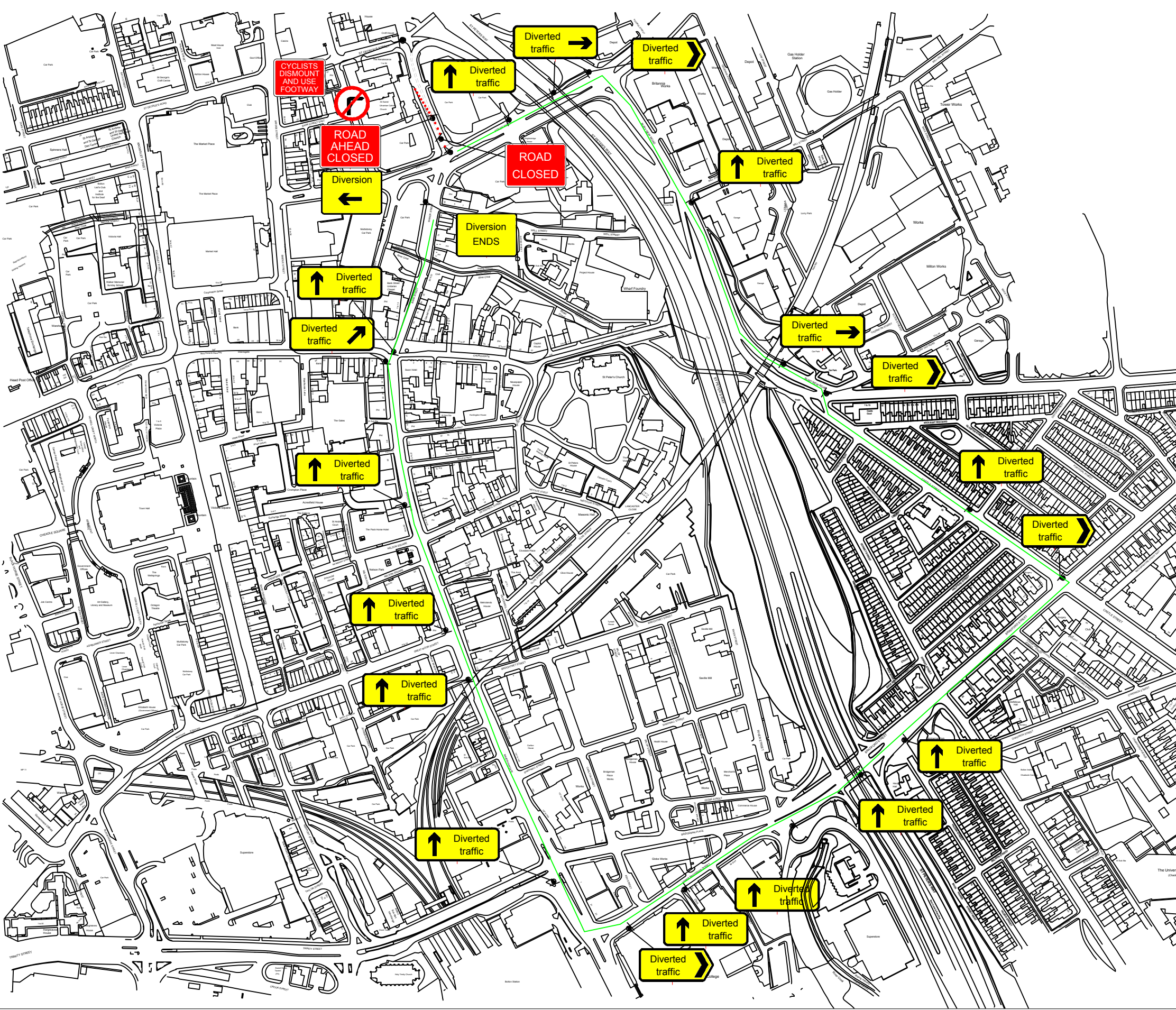

DETAIL B (B)

Single/Dual carriageway 40mph or less - 450mm traffic cones, spacing 1.5m.
Single/Dual carriageway 50mph or more - 750mm traffic cones, spacing 1.5m.
Dual carriageway national speed limit - 750mm traffic cones, spacing 1.5m, relaxation 3m.

Notes:
1) During darkness, warning lights to BS EN 12352:2006 should be provided in accordance with Table A1.3 (Appendix 1).
2) 45° tapers have 1.5m spacing, no relaxations.
3) On motorways and NSL AP duals with hard shoulders, 1m cones will be required for both standard and relaxation works for lead tapers and the facing wall of lane changes.

DETAIL D (D)

Single/Dual carriageway 40mph or less - 450mm traffic cones.
Single/Dual carriageway 50mph or more - 750mm traffic cones.

Notes:
1) During darkness, warning lights to BS EN 12352:2006 should be provided in accordance with Table A1.3 (Appendix 1).
2) Detail D applies only to relaxation cases.

	Standard: Normal traffic including buses and HGVs	Restricted: Cars and light vehicles only
Two-way working	6.75 m minimum	5.5 m minimum
Shuttle working	3.25-3.50 m desirable width range 3.0 m absolute minimum	3.25 m desirable minimum width 2.5 m absolute minimum

Specials -



Notes -

DIVERSION ROUTE - FOLDS RD,BURY NEW RD,CASTLE ST,BRADFORD ST,BRADSHAWGATE,BANK ST

KEY

	Traffic sign
	Traffic cone
	Traffic signals to Diagram 3000.1
	Working Space
	Pedestrian Barrier

TEMPORARY
TRAFFIC MANAGEMENT
30 MPH

Issue	Date
1	17.07.25
Drawn By	MM

NO RIGHT TURN & DIVERSION
KAY STREET BL1 2DT

Original drawing size A3 - NTS

Drawing Ref: T.B.C