

## **BACK BURY NEW RD TEMPORARY CLOSURE**

THE BOROUGH COUNCIL OF BOLTON  
ROAD TRAFFIC REGULATION ACT 1984 S.14

The Council intends to make an order, operative from 7 November 2025 for 3 days approx, the effect of which will be to prohibit all traffic from proceeding on Back Bury New Road from Gloster St to Devon St, to allow water works to take place. The Order will end after 18 months or on completion of the works whichever first occurs.

Bolton Council. 13 October 2025.  
**[bolton.gov.uk/trafficorders](https://bolton.gov.uk/trafficorders)**

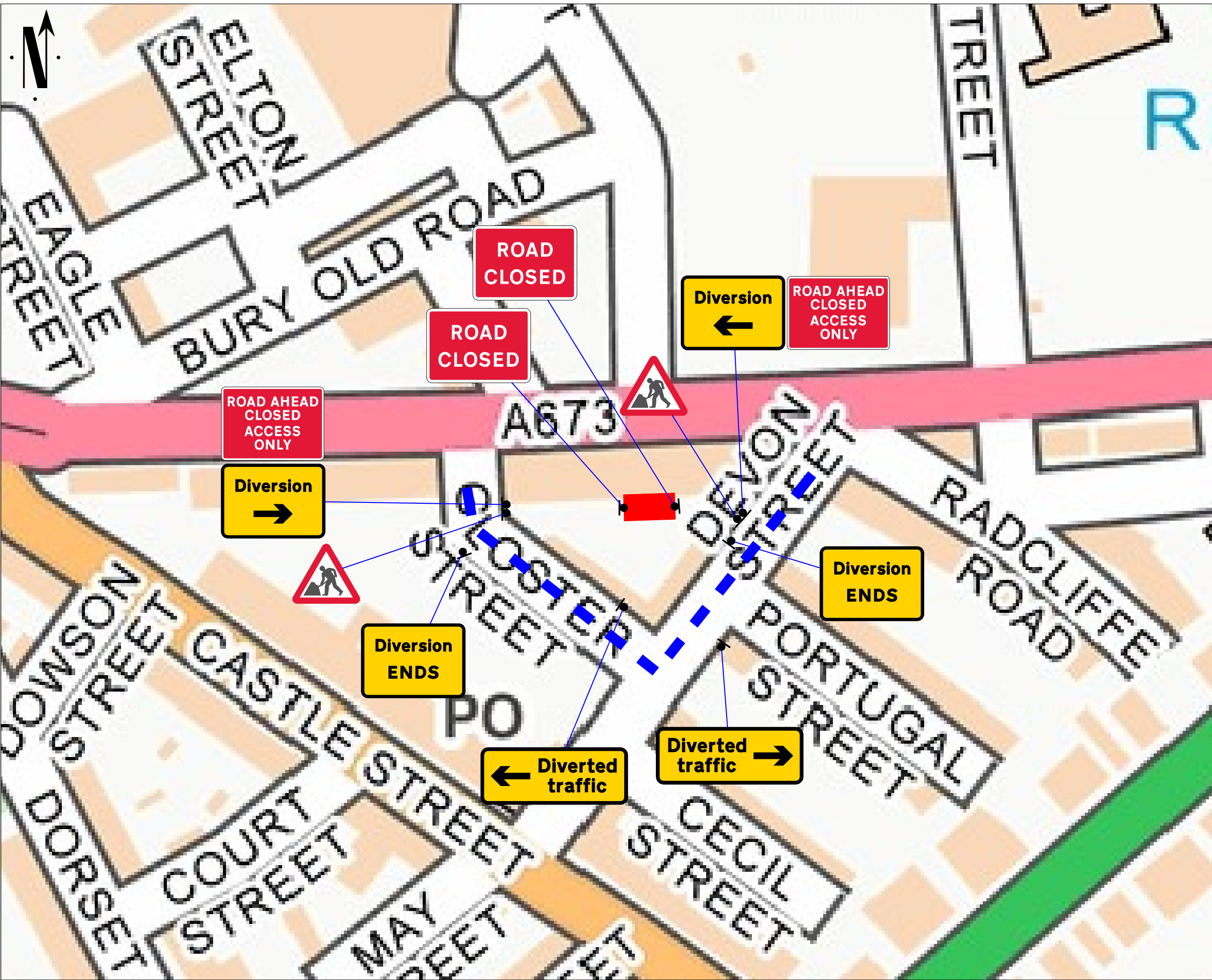

### Go Traffic Management

This drawing has been produced for a specific client & project identified below and is not intended for use by any other person or for any other purpose. © Go Traffic Management

**Risks**

- Design completed from information provided + google maps desktop risk assessment
- Cone lamps must be used on all road with A speed limit of 40mph or more.

**Notes**

- All signs as per Chapter 8. Distances between cones to be 9m maximum unless otherwise noted.
- Distances between signs NOT to scale for purpose of clarity.
- All sign placement subject to available safe working space.
- The purpose of the Traffic Management Plan is for it to be used only as a guide and all traffic management equipment should be put out according to the 'Safety at Street Works and Road Works - Code of Practice', i.e. Red Book & the 'Traffic Signs Manual Chapter 8', i.e. Yellow Book.
- Signs must be placed in accordance with TSM and the scheme RAMS pack.
- Site conditions may have changed since the design of the drawing any changes which subsequently affect the design need to be reported by the Traffic Management Operative & any changes implemented must comply with Chapter 8.

**Key**

	Sign position and aspect of vision		Work area
			Diversion Route 1

**CLOSTER ST <-> DEVON ST**

Traffic Management must comply with The Safety at Street Works and Road Works Code of Practice

**ROAD SPEED**

**30**

**CROSS SECTION**

DO NOT SCALE FROM THIS DRAWING.		Road Closure	
A	31/07/2025	AS DRAWN	
REV.	DATE	DESCRIPTION	

**GTM**

**Go Traffic Management**

Head Office: Go Traffic Management,  
Chaddock Lane, Worsley, Manchester, M28 1XW  
Tel: 0161 351 5370  
[www.gtm.co.uk](http://www.gtm.co.uk)

**TRAFFIC MANAGEMENT PLAN**

**Client:**

**Network Plus**

**Drawing Number:** 1463801

**Drawing Title:**  
rear 68 Bury New Rd, Haulgh,  
Bolton BL2 2BG

	<b>Design:</b>	<b>Technical Officer:</b>	<b>REV:</b>
<b>Name:</b>	B.Greenwood	L.Carcoran	
<b>Signature:</b>			<b>A</b>
<b>Date:</b>	31/07/2025	31/07/2025	