

PUBLIC NOTICE



THE BOROUGH COUNCIL OF BOLTON ROAD TRAFFIC REGULATION ACT 1984 S14 BACK DAISY STREET TEMPORARY TRAFFIC REGULATION NOTICE 2025

The Borough Council of Bolton hereby enacts the temporary closure of Back Daisy Street from Brandwood street to Dane Street, on 30th September 2025 for 3 days, in exercise of its powers under Section 14 of The Road Traffic Regulation Act 1984.

The effect of this Notice will be to prohibit all vehicular and pedestrian traffic from entering, proceeding and/or standing, waiting, loading and or unloading in this street.

The closure is necessary because water works are being, or are proposed to being, executed on or near the road.

30 September 2025

Assistant Director of Highways & Planning
Town Hall, Bolton BL1 1RU

bolton.gov.uk/highways

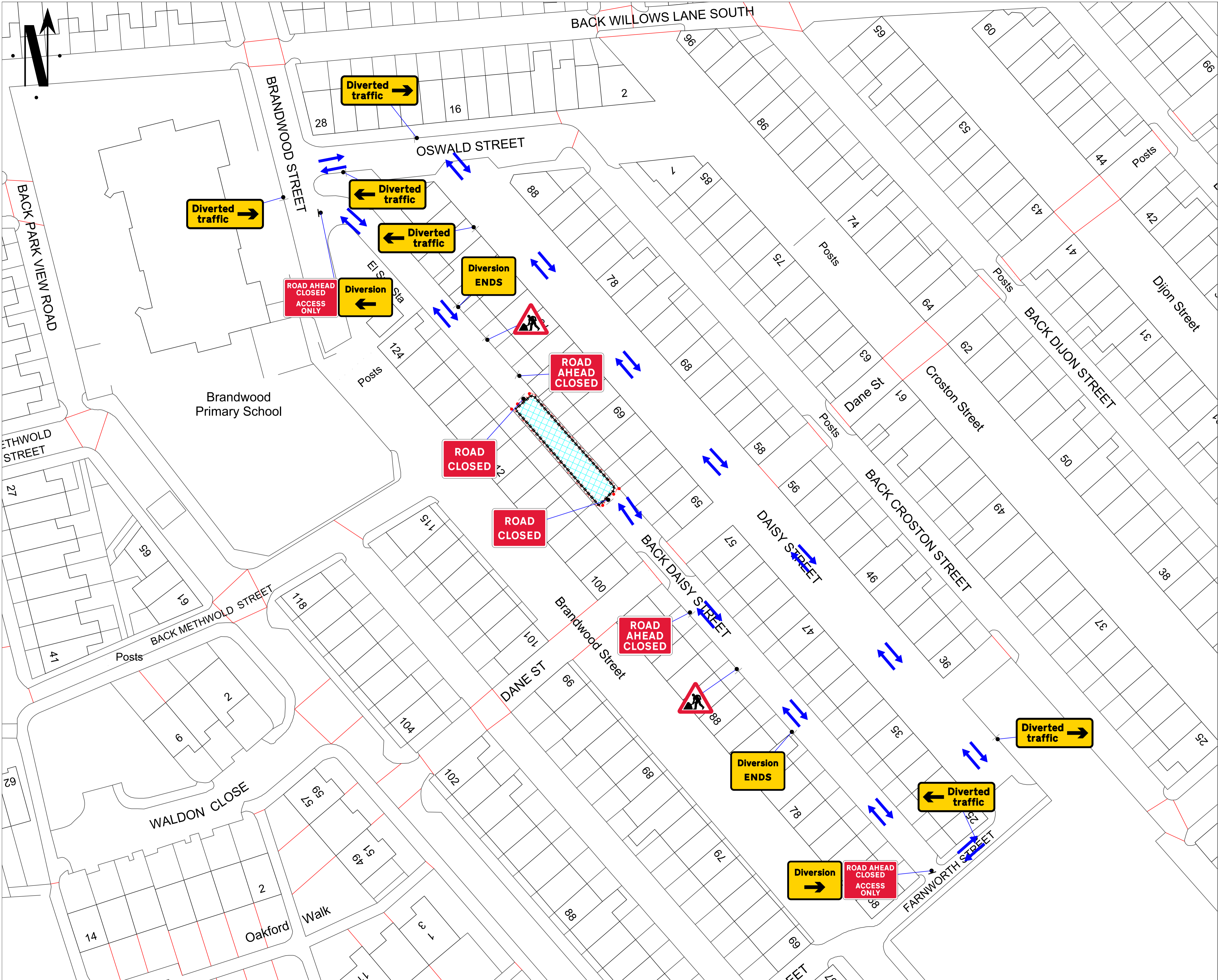

Go Traffic Management

This drawing has been produced for a specific client & project identified below and is not intended for use by any other person or for any other purpose. © Go Traffic Management

Risks

- Design completed from information provided + google maps desktop risk assessment
- Cone lamps must be used on all road with A speed limit of 40mph or more.

Notes

- All signs as per Chapter 8. Distances between cones to be 9m maximum unless otherwise noted.
- Distances between signs NOT to scale for purpose of clarity.
- All sign placement subject to available safe working space.
- The purpose of the Traffic Management Plan is for it to be used only as a guide and all traffic management equipment should be put out according to the 'Safety at Street Works and Road Works - Code of Practice', i.e. Red Book & the 'Traffic Signs Manual Chapter 8', i.e. Yellow Book.
- Signs must be placed in accordance with TSM and the scheme RAMS pack.
- Site conditions may have changed since the design of the drawing any changes which subsequently affect the design need to be reported by the Traffic Management Operative & any changes implemented must comply with Chapter 5.

DETAIL B

1. Single cones on temporary closed road - 10m - 100m traffic cones, spacing 10m.
2. Single cones on temporary closed road - 100m - 200m traffic cones, spacing 10m.
3. Single cones on temporary closed road - 200m - 300m traffic cones, spacing 10m.
4. Single cones on temporary closed road - 300m - 400m traffic cones, spacing 10m.
5. Single cones on temporary closed road - 400m - 500m traffic cones, spacing 10m.
6. Single cones on temporary closed road - 500m - 600m traffic cones, spacing 10m.
7. Single cones on temporary closed road - 600m - 700m traffic cones, spacing 10m.
8. Single cones on temporary closed road - 700m - 800m traffic cones, spacing 10m.
9. Single cones on temporary closed road - 800m - 900m traffic cones, spacing 10m.
10. Single cones on temporary closed road - 900m - 1000m traffic cones, spacing 10m.

Notes

1. Closing down the road, working from the start of the road to the end of the road.
2. All signs must be placed in accordance with the 'Safety at Street Works and Road Works - Code of Practice', i.e. Red Book & the 'Traffic Signs Manual Chapter 8', i.e. Yellow Book.
3. All signs must be placed in accordance with the 'Safety at Street Works and Road Works - Code of Practice', i.e. Red Book & the 'Traffic Signs Manual Chapter 8', i.e. Yellow Book.
4. All signs must be placed in accordance with the 'Safety at Street Works and Road Works - Code of Practice', i.e. Red Book & the 'Traffic Signs Manual Chapter 8', i.e. Yellow Book.
5. All signs must be placed in accordance with the 'Safety at Street Works and Road Works - Code of Practice', i.e. Red Book & the 'Traffic Signs Manual Chapter 8', i.e. Yellow Book.
6. All signs must be placed in accordance with the 'Safety at Street Works and Road Works - Code of Practice', i.e. Red Book & the 'Traffic Signs Manual Chapter 8', i.e. Yellow Book.
7. All signs must be placed in accordance with the 'Safety at Street Works and Road Works - Code of Practice', i.e. Red Book & the 'Traffic Signs Manual Chapter 8', i.e. Yellow Book.
8. All signs must be placed in accordance with the 'Safety at Street Works and Road Works - Code of Practice', i.e. Red Book & the 'Traffic Signs Manual Chapter 8', i.e. Yellow Book.
9. All signs must be placed in accordance with the 'Safety at Street Works and Road Works - Code of Practice', i.e. Red Book & the 'Traffic Signs Manual Chapter 8', i.e. Yellow Book.
10. All signs must be placed in accordance with the 'Safety at Street Works and Road Works - Code of Practice', i.e. Red Book & the 'Traffic Signs Manual Chapter 8', i.e. Yellow Book.

Key

Sign position and aspect of vision
Cones
Work area
Work area
Barriers

Diversion Route

Road closed from the start of Back Daisy St to the end of Back Daisy St.

Diversion Route via: BACK DAISSY ST <-> BRANDWOOD ST <-> OSWALD ST <-> DAISSY ST <-> FARNWORTH ST and vice versa.

MINIMUM S/L SAFETY ZONE OF 0.5 MUST BE ADHERED TO

WORK AREA LESS THAN 0.5 MILES

Traffic Management must comply with The Safety at Street Works and Road Works Code of Practice

ROAD SPEED

30

DO NOT SCALE FROM THIS DRAWING.

ROAD CLOSURE

REV	DATE	DESCRIPTION
A	09/09/25	AS DRAWN

GTM

Go Traffic Management

Head Office: Go Traffic Management,
Chaddock Lane, Worsley, Manchester, M28 1XW

Tel: 0161 351 5370

www.gtm.co.uk

CERTIFIED

ISO 9001:2015

ISO 14001:2015

01545 38901

Client:

Network Plus

Drawing Number: 1497194.0001

Drawing Title:
Dane St,
Bolton BL3 4BD

	Design:	Technical Officer:	REV:
Name:	L. Quinn	L. Corcoran	
Signature:			A
Date:	09/09/25	09/09/25	

BASED UPON THE ORDNANCE SURVEY MAP WITH THE PERMISSION OF THE CONTROLLER OF H.M. STATIONERY OFFICE.