

BACK ALBERTA STREET TEMPORARY CLOSURE

THE BOROUGH COUNCIL OF BOLTON
ROAD TRAFFIC REGULATION ACT 1984 S.14

The Council intends to make an order, operative from 13 October 2025 for 3 days approx, the effect of which will be to prohibit all traffic from proceeding on Back Alberta Street from Northfield St to Hove St, to allow water works to take place. The Order will end after 18 months or on completion of the works whichever first occurs.

Bolton Council. 22 September 2025.
bolton.gov.uk/trafficorders

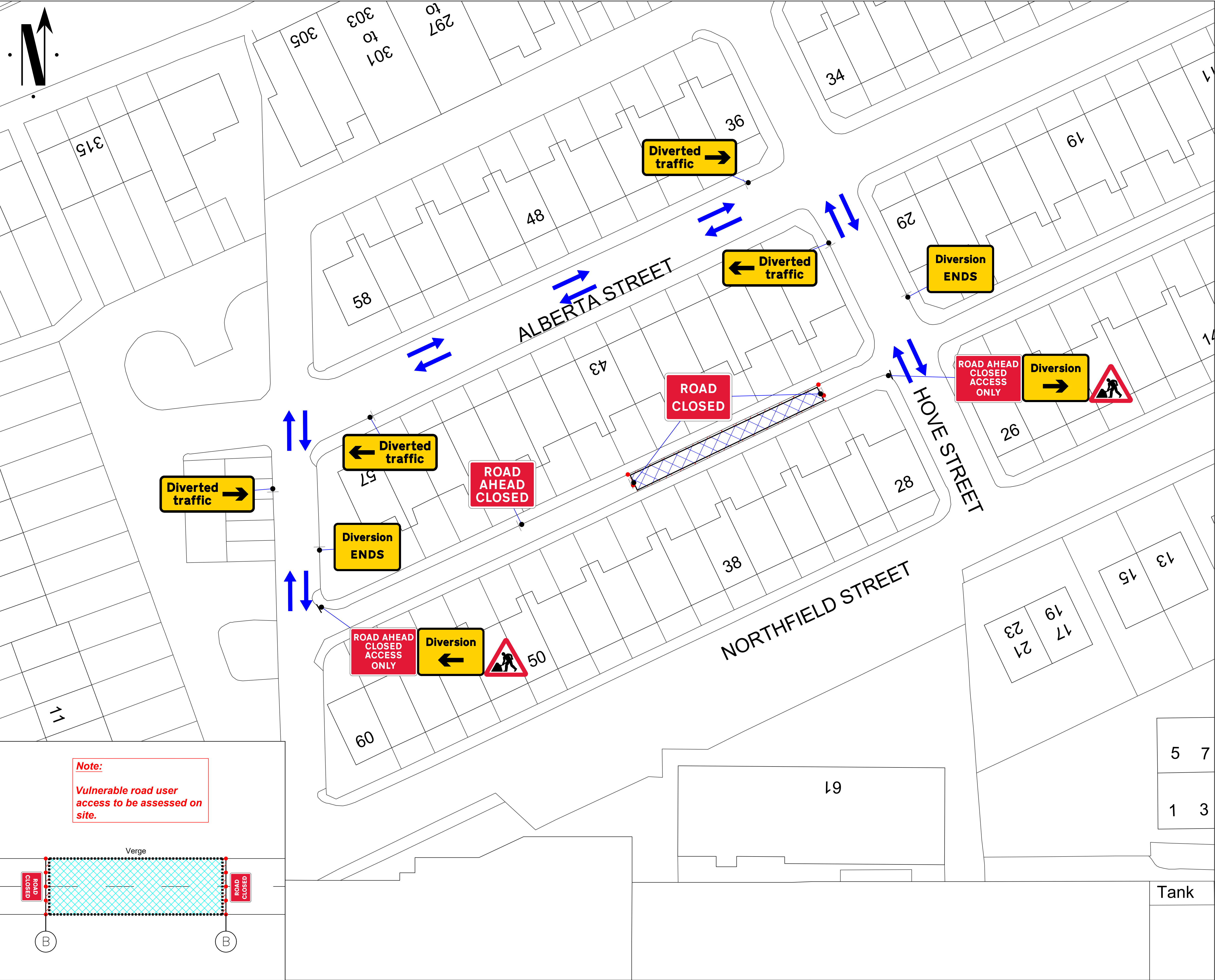

Go Traffic Management

This drawing has been produced for a specific client & project identified below and is not intended for use by any other person or for any other purpose. © Go Traffic Management

Risks

- Design completed from information provided + google maps desktop risk assessment
- Cone lamps must be used on all road with A speed limit of 40mph or more.

Notes

- All signs as per Chapter 8. Distances between cones to be 9m maximum unless otherwise noted.
- Distances between signs NOT to scale for purpose of clarity.
- All sign placement subject to available safe working space.
- The purpose of the Traffic Management Plan is for it to be used only as a guide and all traffic management equipment should be put out according to the 'Safety at Street Works and Road Works - Code of Practice', i.e. Red Book & the 'Traffic Signs Manual Chapter 8', i.e. Yellow Book.
- Signs must be placed in accordance with TSM and the scheme RAMS pack.
- Site conditions may have changed since the design of the drawing; any changes which subsequently affect the design need to be reported by the Traffic Management Operative & any changes implemented must comply with Chapter 8.

Key

●

Sign position and aspect of vision

●

Work area

Diversion Route 1

Traffic Management must comply with The Safety at Street Works and Road Works Code of Practice

Rear Of 37 Alberta Street Closed

Traffic to be diverted via:
Hove Street <-> Alberta Street <-> Northfield Street

ROAD SPEED

30

CROSS SECTION

DO NOT SCALE FROM THIS DRAWING.

ROAD CLOSURE

A

08/07/25

AS DRAWN

REV.

DATE

DESCRIPTION

GTM

Go Traffic Management

Head Office: Go Traffic Management,
Chaddock Lane, Worsley, Manchester, M28 1XW

Tel: 0161 351 5370

www.gtm.co.uk

CERTIFIED

R

ISO 9001: ISO 14001
01545 18901

TRAFFIC MANAGEMENT PLAN

Client: Network Plus

Drawing Number: 1439491.0001

Drawing Title: Alberta Street BL3 5JD

Design:

Technical Officer:

REV:

Name:

A.Bolan

B.Greenwood

Signature:

Date:

08/07/25

08/07/25

BASED UPON THE ORDNANCE SURVEY MAP WITH THE PERMISSION OF THE CONTROLLER OF H.M. STATIONERY OFFICE.