

**PUBLIC PATH DIVERSION AND DEFINITIVE MAP AND STATEMENT**  
**MODIFICATION ORDER**  
**HIGHWAYS ACT 1980**  
**WILDLIFE AND COUNTRYSIDE ACT 1981**

**THE BOROUGH COUNCIL OF BOLTON (PUBLIC FOOTPATH NO. 060 TURTON BRADSHAW 060**  
**(PART) PUBLIC PATH DIVERSION ORDER AND DEFINITIVE MAP AND STATEMENT**  
**MODIFICATION ORDER 2025**

This Order is made by the Borough Council of Bolton ("the Authority") under Section 119 of the Highways Act 1980 ("the 1980 Act") because it appears to the Authority that in the interests of the owner of the land crossed by the footpath described in paragraph 1 of this Order that it is expedient that the line of the path should be diverted.

This Order is also made under Section 53A(2) of the Wildlife and Countryside Act 1981 ("the 1981 Act") because it appears to the Authority that the Definitive Map and Statement of the Public Rights of Way for the Borough Council of Bolton require modification in consequence of the occurrence of an event specified in Section 53(3)(a)(i) of the 1981 Act, namely, the diversion (as authorised by this Order) of a highway shown or required to be shown in the Map and Statement.

Mrs Wright has agreed to defray any compensation which becomes payable in consequence of the coming into force of this order and any expenses which are incurred in bringing the new site of the path and ways into a fit condition for use by the public.

**BY THIS ORDER:**

1. The public right of way over the land which is situated to the west of Asmus Farm, Bradshaw, Bolton, BL2 4LT and shown by the bold black continuous line on the map contained in this order and described in Part 1 of the Schedule to this order, shall be stopped up as from the date the Authority certifies that all necessary works to bring the footpath as described in Part 2 of the schedule into a fit condition for use have been completed and thereupon the Borough Council of Bolton definitive map shall be modified by deleting from it that public right of way.
2. Notwithstanding this Order all statutory undertakers shall continue to have existing rights of access to and egress from any apparatus equipment and plant accessible over the land referred to in Part 1 of the Schedule.
3. There shall at the end of 21 days from the date of confirmation of this Order be a footpath over the land situated to the west of Asmus Farm, Bradshaw, Bolton, BL2 4LT, described in Part 2 of the Schedule and shown by the bold black broken line on the map contained in this Order, and thereupon the Borough Council of Bolton definitive map shall be modified by adding that path to it.
4. The rights conferred on the public under this Order shall be subject to the limitations and conditions set out in Part 3 of the Schedule.
5. The Definitive Statement of the Public Rights of Way for the Borough Council of Bolton shall be modified as described in Part 4 of the Schedule to this order.

**THE COMMON SEAL** of  
**THE BOROUGH COUNCIL** of **BOLTON**  
was hereunto affixed on  
the 11<sup>th</sup> March 2025  
in the presence of:-



## **Schedule**

### **Part 1**

#### **Description of site of existing path or way**

**Public Footpath No. Turton Bradshaw North 060** situated to the west of Asmus Farm, Bradshaw, Bolton, BL2 4LT, commencing from point A at grid reference SD75256 12310 in a generally south south-westerly direction to point B at grid reference SD75238 12271 for a distance of approximately 44 metres then curving in a generally south by easterly direction to point C at grid reference SD75239 12202 for a distance of approximately 69 metres then running in a generally southwest by south direction to point D at grid reference SD75215 12161 for a distance of approximately 47 metres then curving in a generally south south-westerly direction to point E at grid reference SD75200 12109 for a distance of approximately 53 metres as shown by the continuous bold line between points A-B-C-D-E on the Order Plan over a total distance of approximately 213 metres and of a width of 1.5 metres throughout over a natural and stone surface.

### **Part 2**

#### **Description of site of new path or way**

**Public Footpath No. Turton Bradshaw North 060** commencing from a new line from point A at grid reference SD75256 12310 in a generally south south-westerly direction to point H at grid reference SD75202 12206 for a distance of approximately 116 metres then running in a generally south by easterly direction to point I at grid reference SD75202 12193 for a distance approximately 14 metres then running in a generally south south-westerly direction to point J at grid reference SD75195 12172 for a distance of approximately 22 metres then running in a generally southerly direction to point K at grid reference SD75194 12140 for a distance of approximately 31 metres then running in a generally south by easterly direction to point E at grid reference SD75200 12109 for a distance of approximately 31 metres as shown by the bold black broken line between points A-F-G-H-1-J-K-E on the order plan over a total distance of approximately 214 metres. The width between points A-F & G-H-1-J & J-K-E will be 2.0 metres over a natural surface and between points K-E a stone surface. The width between points F-G over a distance of approximately 17 metres will be 1.5 metres over a natural surface.

### **Part 3**

#### **Limitations and Conditions**

A gap of 1.4 metres conforming to BS 5709:2018 at point J on the Order Plan at grid reference SD75195 12172.

**Part 4**  
**Modification of the definitive statement**  
**Variation of particulars of path or way**

**District: Bolton      Path/Way Number: Public Footpath Turton Bradshaw North 060**

**Amend the existing statement entry with the following: Insert after "Tottington Road (west of New House) via Castle Farm." with "continuing from SD75256 12310 between fences in a generally south south-westerly direction to SD75202 12206 for approximately 116 metres then running in a generally south by easterly direction to SD75202 12193 for approximately 14 metres then running in a generally south south-westerly direction to SD75195 12172 for approximately 22 metres then running in a generally southerly direction with horse exercise area to the south east to SD75194 12140 for approximately 31 metres then running through stable yard in a generally south by easterly direction to SD75200 12109 for approximately 31 metres (to junction with path No. 62 Isherwood Fold)."**

**Total Length:** 709 metres

**Width:** Between SD75256 12310 & SD75200 12109 2.0 metres throughout except between SD75219 12240 & SD75211 12224 1.5 metres.

**Surface Type:** Natural between SD75256 12310 & SD75194 12140 & stone between SD75194 12140 & SD75200 12109.

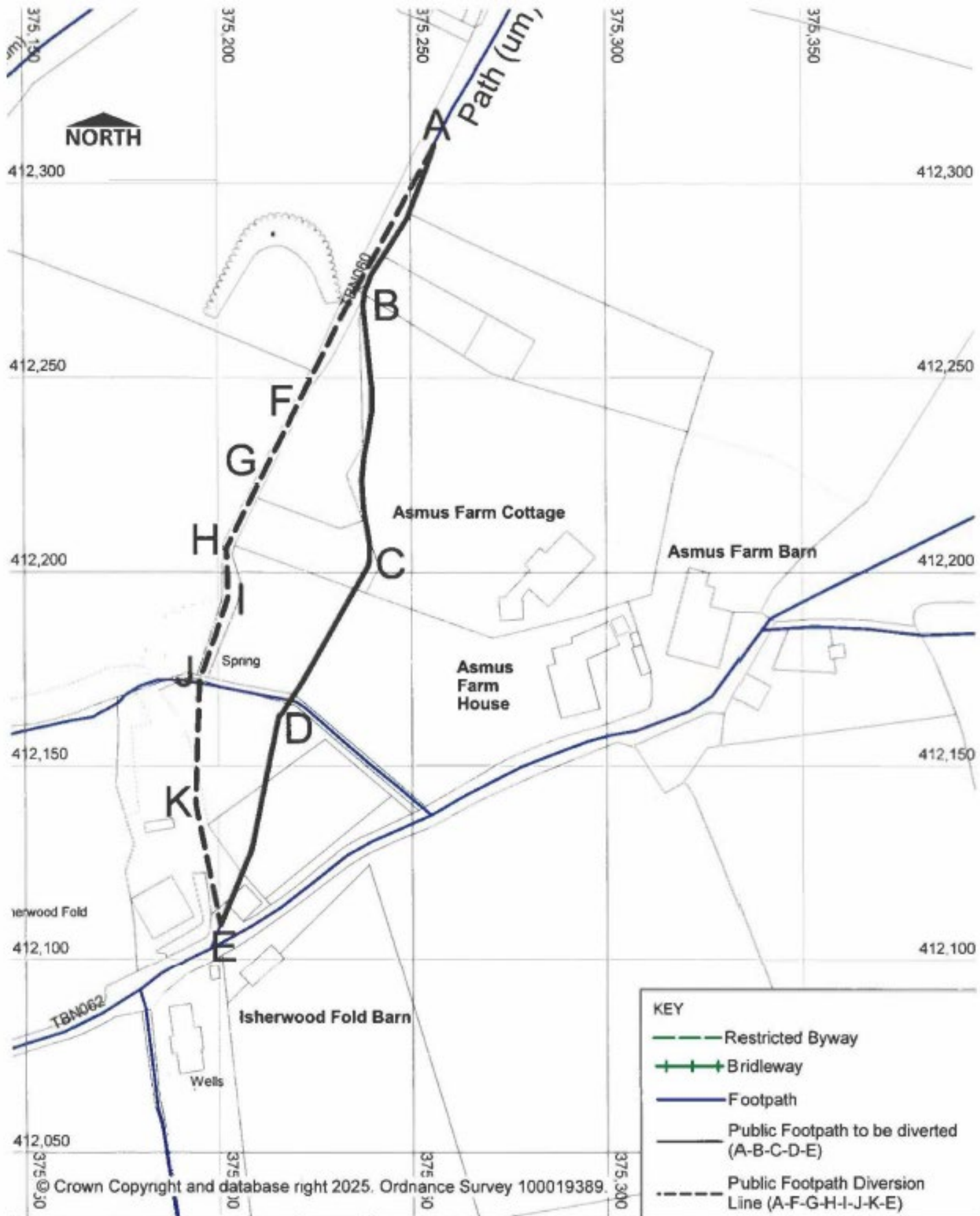

HIGHWAY AND ENGINEERING  
DIVISION  
PUBLIC RIGHTS OF WAY

THE BOROUGH COUNCIL OF BOLTON  
Public Footpath Turton Bradshaw North 060 (part) Diversion Order and  
Definitive Map Modification Order HA 1980 & WCA 1981

**DIRECTORATE OF PLACE**  
Jon Dyson  
Director of Place  
Town Hall, Victoria Square, Bolton, BL1 1RU

Date	Scale	Drawn	Drg. No.
03/03/2025	1:1250	AS	1TBN060 The Plan

© Crown Copyright and database right 2025. Ordnance Survey 100019389.

**PUBLIC PATH DIVERSION AND DEFINITIVE MAP AND STATEMENT  
MODIFICATION ORDER  
HIGHWAYS ACT 1980  
WILDLIFE AND COUNTRYSIDE ACT 1981**

**THE BOROUGH COUNCIL OF BOLTON (PUBLIC FOOTPATH NO. 060 TURTON  
BRADSHAW 060 (PART) PUBLIC PATH DIVERSION ORDER AND DEFINITIVE MAP  
AND STATEMENT MODIFICATION ORDER 2025**

Confirmed as an unopposed order on 16<sup>th</sup> May 2025.

THE COMMON SEAL of THE  
BOROUGH COUNCIL OF BOLTON  
was hereunto affixed on the 16<sup>th</sup> May 2025  
in the presence of:

*Aileen Gorman*

Authorised Sealing Officer



Sealing No.  
**23851**

**THE BOROUGH COUNCIL OF BOLTON**

**TOWN AND COUNTRY PLANNING ACT 1990 AND WILDLIFE AND COUNTRYSIDE ACT  
1981**

**NOTICE OF OPERATION**

**THE BOROUGH COUNCIL OF BOLTON (PUBLIC FOOTPATH NO. 060 TURTON  
BRADSHAW 060 (PART) PUBLIC PATH DIVERSION ORDER AND DEFINITIVE  
MAP AND STATEMENT MODIFICATION ORDER 2025**

The Borough Council of Bolton declared the above-mentioned Order operative on the 5<sup>th</sup> August 2025.

H Gorman  
Borough Solicitor  
Town Hall  
Bolton, BL1 1RU (LS/RST/096618)

*Helen Gorman*



Sealing No. 24000
----------------------