

BACK HIGH STREET TEMPORARY CLOSURE

THE BOROUGH COUNCIL OF BOLTON
ROAD TRAFFIC REGULATION ACT 1984 S.14

The Council intends to make an order, operative from 7 August 2025 for 4 weeks approx, the effect of which will be to prohibit all traffic from proceeding on Back High Street North from Bridgeman St to Back Bridgeman St, and on Back High Street South from Back High St West to Bridgeman St to allow gas works to take place. The Order will end after 18 months or on completion of the works whichever first occurs.

Bolton Council. 31 July 2025.
bolton.gov.uk/trafficorders

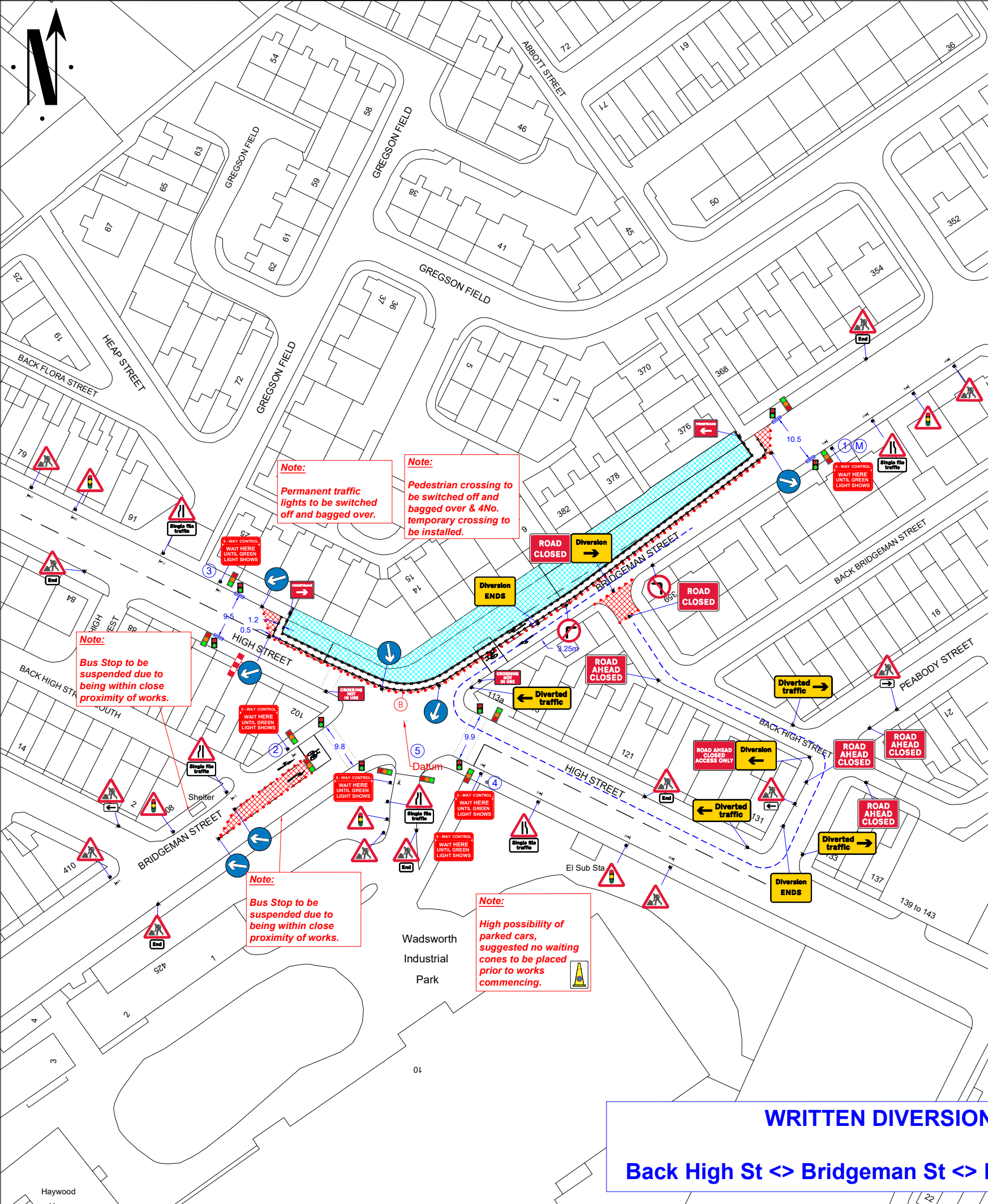

Phasing Diagrams:

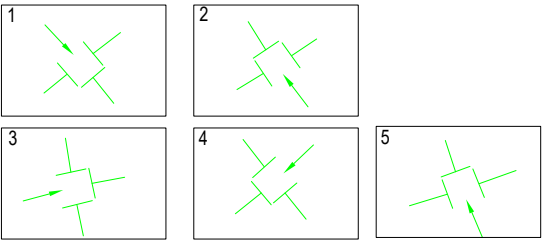

Initial Green Timings:

Phase 1	45	seconds
Phase 2	45	seconds
Phase 3	45	seconds
Phase 4	45	seconds
Phase 5	15	seconds

Distance from Datum Point to 'WHUGLS' Signs:

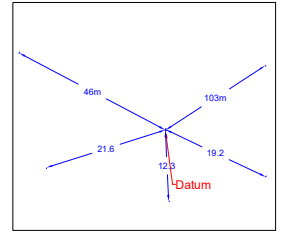

All Red Matrix (seconds):

		To Phase				
From Phase		1	2	3	4	5
	1		15	15	15	15
	2	15		15	15	15
	3	15	15		15	15
	4	15	15	15		15
	5	15	15	15	15	

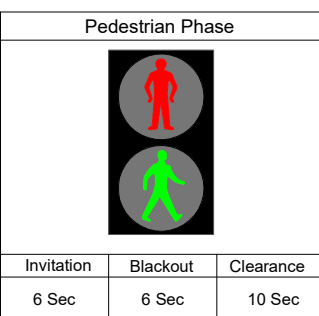

Layout P2
Footway closed, pedestrians in carriageway

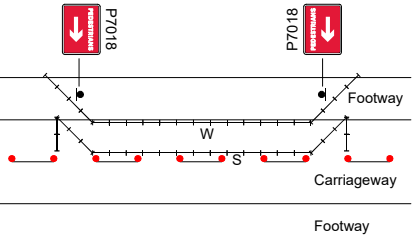

Qty 2 Ref: 13-9 Schedule 13: Temporary Sign	ROAD AHEAD CLOSED
Qty 1 Ref: 2702 Start of temporary diversion route	Diversion
Qty 1 Ref: 2702 End of temporary diversion route	Diversion
Qty 2 Ref: 2703 Direction of temporary diversion route from junction ahead	Diverted traffic
Qty 2 Ref: 2703 Direction of temporary diversion route from junction ahead	Diverted traffic
Qty 3 Ref: 517 Road narrows on one side only ahead - left	Single file traffic
Qty 2 Ref: 517 Road narrows on one side only ahead - right	Single file traffic
Qty 5 Ref: 518 Single file traffic	Single file traffic
Qty 5 Ref: 543 Traffic signals ahead	ROAD AHEAD CLOSED
Qty 2 Ref: 573 Direction to hazard left	Diversion
Qty 1 Ref: 573 Direction to hazard right	Diversion
Qty 7 Ref: 610 Keep right	Diversion
Qty 1 Ref: 612 No right turn	Diversion
Qty 1 Ref: 613 No left turn	Diversion
Qty 5 Ref: 645 End panel	End
Qty 13 Ref: 7001 Road works ahead	ROAD CLOSED
Qty 2 Ref: 7010-PP-13-9 Nature of temporary hazard ahead - Road Closed	ROAD AHEAD CLOSED
Qty 4 Ref: 7010-PP-13-9 Nature of temporary hazard ahead - Road ahead closed	ROAD AHEAD CLOSED
Qty 1 Ref: 7011 When Red Light Shows Wait Here	CROSSING NOT IN USE
Qty 2 Ref: 7016 Creating out to use [sign for pedestrians]	CROSSING NOT IN USE
Qty 1 Ref: 7018 Pedestrian diversion right	Diversion
Qty 1 Ref: 7018 Pedestrian diversion left	Diversion
Qty 1 Ref: 7105 Lane closure barrier	Diversion

Go Traffic Management

This drawing has been produced for a specific client & project identified below and is not intended for use by any other person or for any other purpose. © Go Traffic Management

Risks

- Design completed from information provided + google maps desktop risk assessment
- Cone lamps must be used on all road with A speed limit of 40mph or more.

Notes

- All signs as per Chapter 8. Distances between cones to be 9m maximum unless otherwise noted.
- Distances between signs NOT to scale for purpose of clarity.
- All sign placement subject to available safe working space.
- The purpose of the Traffic Management Plan is for it to be used only as a guide and all traffic management equipment should be put out according to the 'Safety at Street Works and Road Works - Code of Practice', i.e. Red Book & the 'Traffic Signs Manual Chapter 8', i.e. Yellow Book.
- Lane width past the works to be 3.5m maximum, 3.25m desirable minimum and 3.0m absolute minimum.
- Stop & Go boards must be available and utilised in the event of permanent signal failure in accordance with Code of Practice.
- Signs must be placed in accordance with TSM and the scheme RAMS pack.
- Site conditions may have changed since the design of the drawing any changes which subsequently affect the design need to be reported by the Traffic Management Operative & any changes implemented must comply with Chapter 8.

DETAIL B

DETAIL C

Key

- Sign position and aspect of vision
- Position of signal head
- Position of pedestrian crossing
- Cones
- Work area
- Barriers
- No Parking Cones
- Pedestrian diversion Route
- Pedestrian Ramp

Note:

ARTSM GUPS 14.3 You shall use 2 traffic signals for each approach where a pedestrian facility is used. If you only use one traffic signal per approach your risk assessment must clearly state how you mitigate the risks presented by only using one signal on an approach to a pedestrian crossing.

MINIMUM SAFETY ZONE 0.5m

SIDEWAYS SAFETY ZONE 0.5m

Traffic Management must comply with The Safety at Street Works and Road Works Code of Practice

ROAD SPEED

30

CROSS SECTION

Lane 2 Closure or Shuttle Lane With Ped Walkway

DO NOT SCALE FROM THIS DRAWING.

5 Way Lights

B 25/06/25 Added RC & diversion route

A 07/02/25 AS DRAWN

REV. DATE DESCRIPTION

GTM Go Traffic Management

Head Office: Go Traffic Management, Chaddock Lane, Worsley, Manchester, M28 1XW

Tel: 0161 351 5370

www.gtm.co.uk

TRAFFIC MANAGEMENT PLAN

Client:

Cadent Your Gas Network

Drawing Number: 1295357.001

Drawing Title:

Bridgeman St jct of High St, Bolton, BL3 6SR

Design:	Technical Officer:	REV:
Name: Prince Ndlovu		
Signature: P.Ndlovu		B
Date: 07/02/25	07/02/25	