

PUBLIC NOTICE



THE BOROUGH COUNCIL OF BOLTON ROAD TRAFFIC REGULATION ACT 1984 S14 BACK TONGE MOOR ROAD TEMPORARY TRAFFIC REGULATION NOTICE 2025

The Borough Council of Bolton hereby enacts the temporary closure of Back Tonge Moor Road from Ripley Street to Colmore Street, from this date and for approximately 3 days, in exercise of its powers under Section 14 of The Road Traffic Regulation Act 1984.

The effect of this Notice will be to prohibit all vehicular and pedestrian traffic from entering, proceeding and/or standing, waiting, loading and or unloading in this street.

The closure is necessary because water works are being, or are proposed to being, executed on or near the road.

15 July 2025

Assistant Director of Highways & Planning
Town Hall, Bolton BL1 1RU

bolton.gov.uk/highways

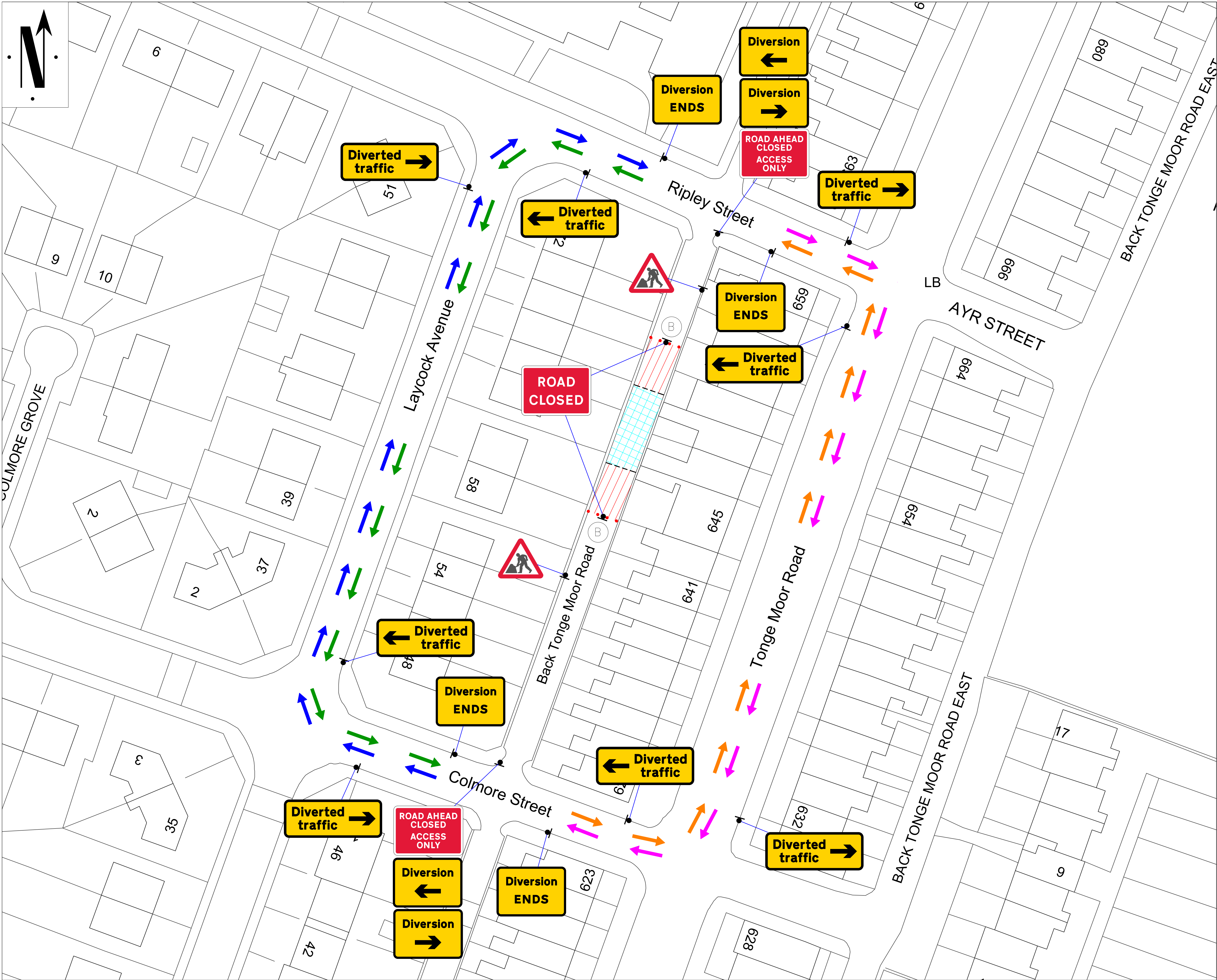

Go Traffic Management

This drawing has been produced for a specific client & project identified below and is not intended for use by any other person or for any other purpose. © Go Traffic Management

Risks

- Design completed from information provided + google maps desktop risk assessment
- Cone lamps must be used on all road with A speed limit of 40mph or more.

Notes

- All signs as per Chapter 8. Distances between cones to be 9m maximum unless otherwise noted.
- Distances between signs NOT to scale for purpose of clarity.
- All sign placement subject to available safe working space.
- The purpose of the Traffic Management Plan is for it to be used only as a guide and all traffic management equipment should be put out according to the 'Safety at Street Works and Road Works - Code of Practice', i.e. Red Book & the 'Traffic Signs Manual Chapter 8', i.e. Yellow Book.
- Signs must be placed in accordance with TSM and the scheme RAMS pack.
- Site conditions may have changed since the design of the drawing any changes which subsequently affect the design need to be reported by the Traffic Management Operative & any changes implemented must comply with Chapter 8.

DETAIL B

1. Traffic cones must be placed in line with the traffic cones, leaving a 1m gap between the cones and the road edge. 2. Traffic cones must be placed in line with the traffic cones, leaving a 1m gap between the cones and the road edge. 3. Traffic cones must be placed in line with the traffic cones, leaving a 1m gap between the cones and the road edge.

Key

●	Sign position and aspect of vision	Work Space
●	Cones	Safety Zone
→	Diversion 1	Barriers
→	Diversion 2	
→	Diversion 3	
→	Diversion 4	

Rear of 62 Laycock Avenue, Back Tonge Moor Road, Closed

Traffic to be diverted via:

- Diversion 1**
Colmore Street > Laycock Avenue > Ripley Street
- Diversion 2**
Ripley Street > Laycock Avenue > Colmore Street
- Diversion 3**
Colmore Street > Tonge Moor Road > Ripley Street
- Diversion 4**
Ripley Street > Tonge Moor Road > Colmore Street

Traffic Management must comply with The Safety at Street Works and Road Works Code of Practice

ROAD SPEED

20

DO NOT SCALE FROM THIS DRAWING.

ORIGINAL	13-04-25	As Drawn
REV. A	xxx	xxx
REV. B	xxx	xxx

GTM
Go Traffic Management

Head Office: Go Traffic Management, Chaddock Lane, Worsley, Manchester, M28 1XW
Tel: 0161 351 5370
www.gtm.co.uk

CERTIFIED
ISO 9001: ISO 14001
OHSAS 18001

TRAFFIC MANAGEMENT PLAN

Client: **Network Plus**

Drawing Number: 1361993.01

Drawing Title: Rear of 62 Laycock Avenue, Bolton, BL2 3AL

	Design:	Technical Officer:	REV:
Name:	J.Bennett	A.Bolan	
Signature:			
Date:	13-04-2025	14-04-2025	