

CHORLEY NEW ROAD / DE HAVILLAND WAY, HORWICH (BEEHIVE ROUNDABOUT) TEMPORARY CLOSURES

THE BOROUGH COUNCIL OF BOLTON
ROAD TRAFFIC REGULATION ACT 1984 S.14

The Council intends to make an order, operative from 14 July 2025 for 2 weeks approx. between the hours of 7pm and 5am, the effect of which will be to close sections of 'The Beehive Roundabout' to allow resurfacing works to take place in the phases listed below.

Phase A

Vehicles travelling eastbound (Chorley New Road - from Horwich towards Bolton) will be unable to access the roundabout.

Alternate route will be via Scholes Bank, Bolton Rd, Westhoughton Rd, Chorley Rd, Blackrod Bypass, Chorley Road.

Phase B

Vehicles travelling eastbound on Chorley New Road from Horwich towards Middlebrook will be unable to use the eastern sector of the roundabout. A short diversion (50m) will be created using the access slip south of Austins Lane.

Phase C

Closure of De Havilland Way (Southbound traffic) from Chorley New Rd to Mansell Way.

Vehicles travelling on Chorley New Road (eastbound) towards Bolton will be unable to turn right onto De Havilland Way.

Vehicles travelling on Chorley New Road (westbound) towards Horwich will be unable to turn left onto De Havilland Way.

Alternate route will be Chorley New Road, Beaumont Rd, Wigan Rd, Snydale Way, Chorley Rd.

The Order will end after 18 months or on completion of the works whichever first occurs.

Bolton Council. 23 June 2025.

bolton.gov.uk/trafficorders

Bethell - C076.25 - De Havilland Way
Phase 3A Example

A 673 Chorley New Rd
Closed At
De Havilland Way
No Through Route
Follow Diversion



Client.

bethell Civils • Utilities

KEY.

Qty: 6		Qty: 2	
Qty: 3		Qty: 2	
Qty: 2		Qty: 3	
Qty: 4		Qty: 1	
Qty: 1		Qty: 4	
Qty: 17		Qty: 2	
Qty: 3		Qty: 6	
Qty: 1		Qty: 1	
Qty: 1		Qty: 1	
Qty: 2		Qty: 1	
Qty: 1			

- CONES
- WORKS AREA
- PEDESTRIAN BARRIER
- DIVERSION
- LOCAL DIVERSION

Bethell - C076.25 De Havilland Way,
Beehive Roundabout, Lostock, BL6 4BA
Road Closure Diversion

Drg No. **KHW200225GH**

Drawn By **G Hargreaves**
Checked By **S Hargreaves**
Date. **20/02/25**

A3
Not to scale
Dimensions: Metres

- Notes.
- This drawing has been produced for the client displayed and therefore not for use by any other company or persons for any other requirement.
- All signs follow chapter 8 requirements
 - Distances are NOT to scale due to drawing purposes
 - All placement of the TM equipment as stated per traffic management plan is to be adjusted to the layout and safety of the site aligning with the 'Safety at Street Works and Road Works - Code of Practice' & the 'Traffic Signs Manual Chapter 8.

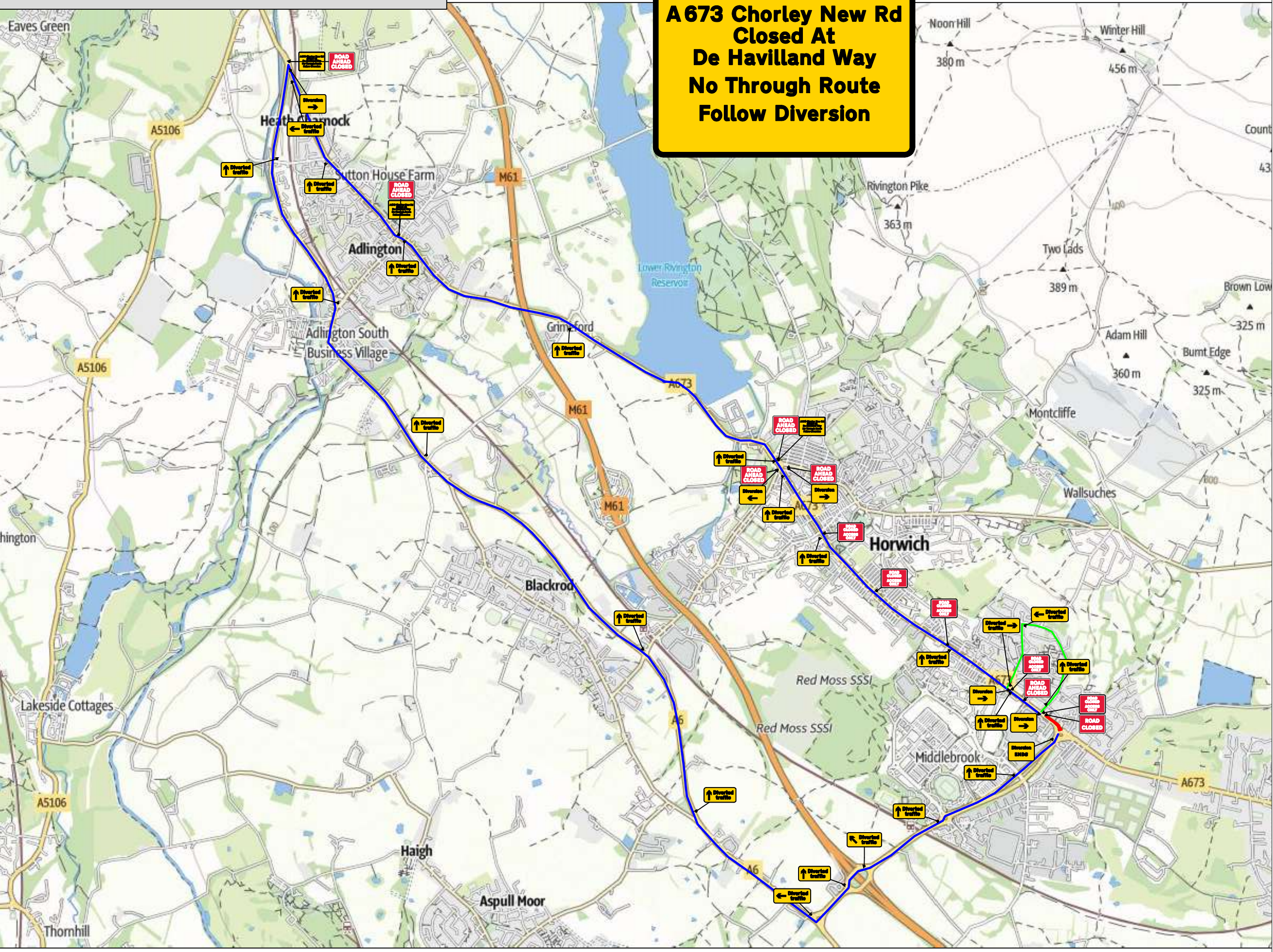

Bethell - C076.25 - De Havilland Way
Phase 3B Example

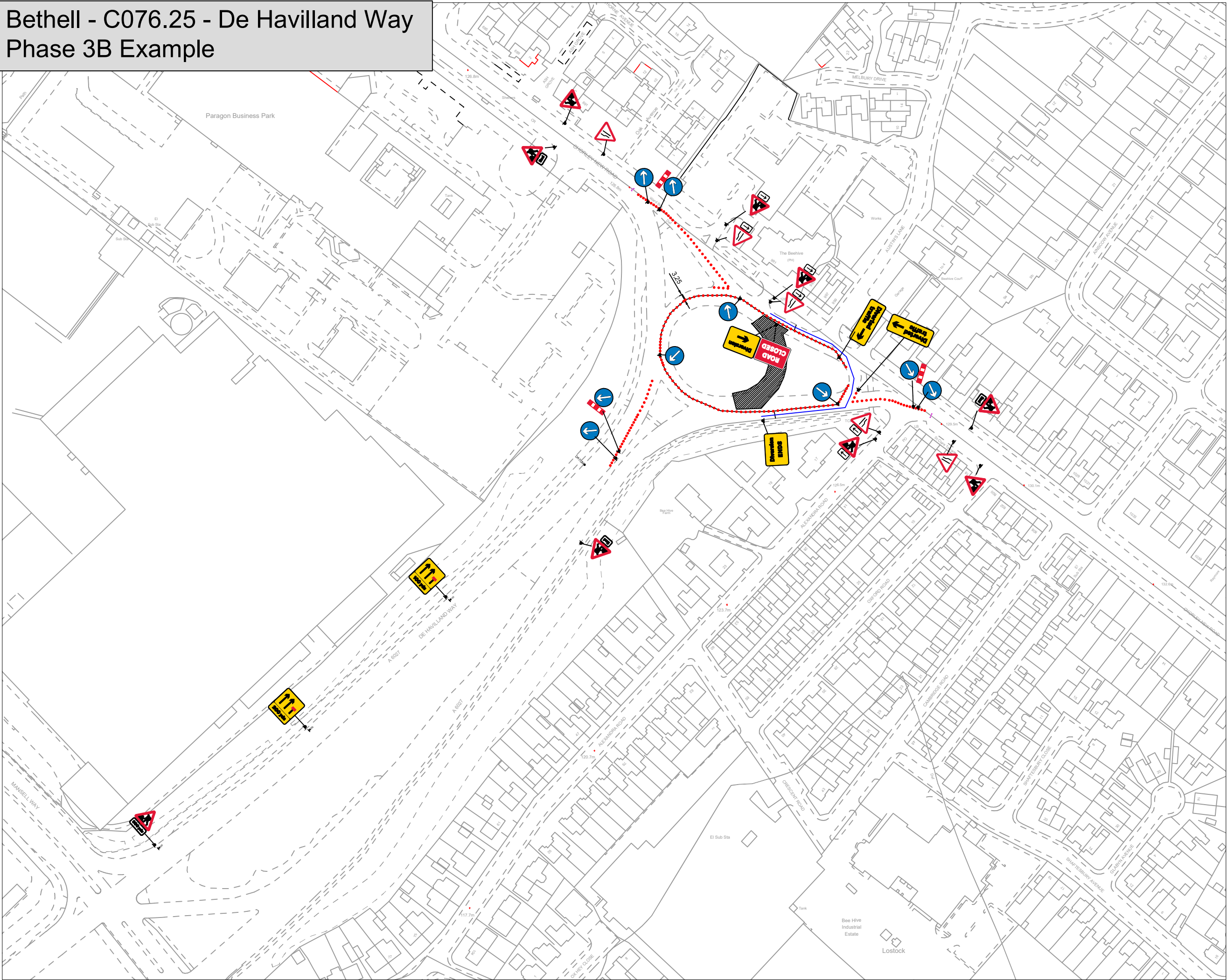

Client.



KEY.

Qty: 1	
Qty: 1	
Qty: 2	
Qty: 5	
Qty: 1	
Qty: 6	
Qty: 9	
Qty: 3	
Qty: 9	
Qty: 1	
Qty: 3	
Qty: 1	
Qty: 1	

- CONES
- WORKS AREA
- PEDESTRIAN BARRIER
- DIVERSION

Bethell - C076.25 De Havilland Way,
Beehive Roundabout, Lostock, BL6 4BA
Road Closure Diversion

Drg No.
KHW200225GH

Drawn By. G Hargreaves	A3 <small>Not to scale Dimensions: Metres</small>
Checked By S Hargreaves	
Date. 20/02/25	

- Notes.
- This drawing has been produced for the client displayed and therefore not for use by any other company or persons for any other requirement.
- All signs follow chapter 8 requirments
 - Distances are NOT to scale due to drawing purposes
 - All placement of the TM equipment as stated per traffic management plan is to be adjusted to the layout and safety of the site aligning with the 'Safety at Street Works and Road Works - Code of Practice' & the 'Traffic Signs Manual Chapter 8.

Bethell - C076.25 - De Havilland Way
Phase 3C Example



Client.



KEY.

Qty: 2		Qty: 2	
Qty: 1		Qty: 2	
Qty: 1		Qty: 1	
Qty: 15		Qty: 1	
Qty: 6		Qty: 2	
Qty: 1		Qty: 6	
Qty: 3		Qty: 1	
Qty: 1		Qty: 3	
Qty: 2		Qty: 2	
Qty: 2			

	CONES
	WORKS AREA
	PEDESTRIAN BARRIER
	DIVERSION

Bethell - C076.25 De Havilland Way,
Beehive Roundabout, Lostock, BL6 4BA
Road Closure Diversion

Drg No.
KHW200225GH

Drawn By **G Hargreaves**
Checked By **S Hargreaves**

Date.
20/02/25

A3
Not to scale
Dimensions: Metres

Notes.

This drawing has been produced for the client displayed and therefore not for use by any other company or persons for any other requirement.

- All signs follow chapter 8 requirements
- Distances are NOT to scale due to drawing purposes
- All placement of the TM equipment as stated per traffic management plan is to be adjusted to the layout and safety of the site aligning with the 'Safety at Street Works and Road Works - Code of Practice' & the 'Traffic Signs Manual Chapter 8.

