

BOSWORTH STREET TEMPORARY CLOSURE

THE BOROUGH COUNCIL OF BOLTON
ROAD TRAFFIC REGULATION ACT 1984 S.14

The Council intends to make an order, operative from 10 June 2025 between 9.30am and 3pm approx, the effect of which will be to prohibit all traffic from proceeding on Bosworth Street from Chorley New Rd to Back Chorley New Rd, to allow manhole repairs to take place. Alternate route will be via Herbert St. The Order will end after 18 months or on completion of the works whichever first occurs.

Bolton Council. 20 May 2025.
bolton.gov.uk/trafficorders

Phasing Diagrams:

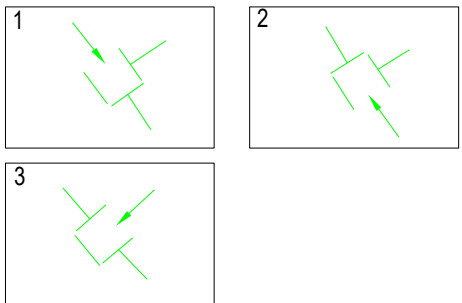

Initial Green Timings:

Phase 135..... seconds
Phase 235..... seconds
Phase 320..... seconds

Distance from Datum Point to 'WHUGLS' Signs:

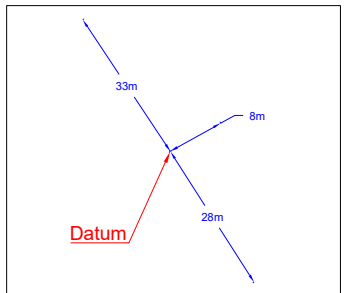

All Red Matrix (seconds):

		To Phase		
From Phase		1	2	3
1			10	10
2		10		10
3		10	10	

Layout P1
Footway unobstructed

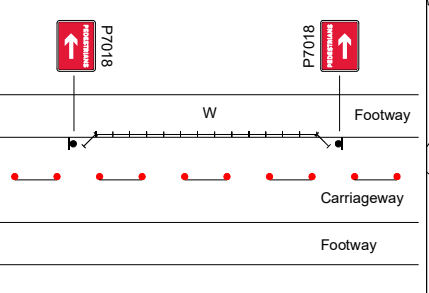

Written diversion route:

Chorley New Rd, Herbert St E,
Unnamed road, Bosworth St

NOTES:
1. All signs and cones to be in accordance with Chapter 8 new roads and street works a code of practice (Red book)
2. Works access and egress are indicative, exact locations to be agreed on site.
3. Safety zones are to be installed as required as shown by the SAFETY ZONE DIMENSIONS BELOW
4. All signs to be located so as not to obscure signs or objects and should be ballasted near to ground level using sand filled hessian bags or sign straps.
5. All sign positions are indicative only and must be accurately positioned on site with good visibility and be clear of and obstructions or vegetation at all times.
6. Drawing not to scale



cadrequest@sus.co.uk tmbookings@sus.co.uk

Drawn By: P.Ndlovu
Drawing No: SUS11475
Approved: P.Ndlovu
Date: 17/04/2025
Scale: NTS

Traffic Management Type:
STREET ADDRESS:
WORKS ACCESS WORKS EXIT
Works access/ works exit to be risk assessed on site for suitability of location
Traffic sign Cone Diversion Ramp Work Area Safety Zone MH Location

Safety Zones:
Longways-0.5m
Sideways-0.5m



MULTI - PHASE TRAFFIC SIGNALS :

- NOTES
- All traffic signs shall comply with Chapter 8 of the Traffic Signs Manual
 - Maximum distance between any two temporary traffic signals to be 249m. Minimum distance between any two temporary traffic signals to be 30m.
 - Temporary traffic signals shall not occur within 150m of an existing level crossing. Pelican crossing or signalised junction without the consent of the Engineer. The Engineer shall consult with the authority responsible for any of these types of facility prior to traffic management being installed in adjacent areas.
 - Coning shall be installed at 45° to the edge of carriageway, as generally indicated.
 - Multi-phase portable traffic signals shall operate in vehicle actuated (VA) mode at all times unless otherwise directed by the Engineer.
 - Multi-phase portable traffic signals shall only be installed with the written permission of the local highway authority whose roads they are installed on.
 - Cable crossing protectors and P7010/P7013 signs shall be provided whenever control cables cross a section of carriageway open to traffic.
 - The signal control mechanism shall normally be placed in a location from which it is possible to view all approaches to the site.
 - Duplicate primary signal to be installed as instructed.
 - Lane width past the works to be 3.7m maximum, 3.25m desirable minimum, 3.0m absolute minimum.

Lane 2 Closure or Shuttle Lane

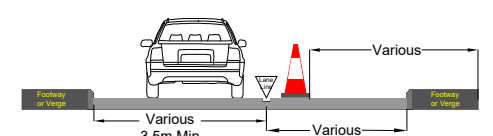

Qty: 1 Ref: 13-9-RCAO Road Closed Access Only	ROAD CLOSED
Qty: 1 Ref: 2702 Start of temporary diversion route	Diversion
Qty: 1 Ref: 2702 Start of temporary diversion route	Diversion
Qty: 2 Ref: 2702 End of temporary diversion route	Diversion ENDS
Qty: 2 Ref: 2703 Direction of temporary diversion route from junction ahead	Diversion
Qty: 2 Ref: 2703 Direction of temporary diversion route from junction ahead	Diversion
Qty: 1 Ref: 517 Road narrow on one side only ahead - left	
Qty: 1 Ref: 517 Road narrow on one side only ahead - right	
Qty: 3 Ref: 518 Single file traffic	Single file traffic
Qty: 4 Ref: 543 Traffic signs ahead	
Qty: 4 Ref: 573 Direction to hazard left	
Qty: 2 Ref: 573 Direction to hazard right	
Qty: 3 Ref: 610 Keep right	
Qty: 1 Ref: 612 No right turn	
Qty: 1 Ref: 613 No left turn	
Qty: 3 Ref: 645 End panel	End
Qty: 11 Ref: 7009 Road works ahead	
Qty: 2 Ref: 7010-EP-13-9 Nature of temporary hazard ahead - Road Closed	ROAD CLOSED
Qty: 2 Ref: 7010-EP-13-9 Nature of temporary hazard ahead - Road Ahead Closed	ROAD AHEAD CLOSED
Qty: 3 Ref: 7011 3 Way Control - Wait here until green light shows	WAIT HERE UNTIL GREEN LIGHT SHOWS
Qty: 2 Ref: 7016 Crossing not in use (for pedestrians)	CROSSING NOT IN USE
Qty: 1 Ref: 7018 Pedestrian diversion Right	Pedestrian
Qty: 1 Ref: 7018 Pedestrian diversion Left	Pedestrian
Qty: 1 Ref: 7105 Lane closure barrier	

3 Way Lights

98 Chorley New Rd,
Horwich,
Bolton
BL6 5QJ