

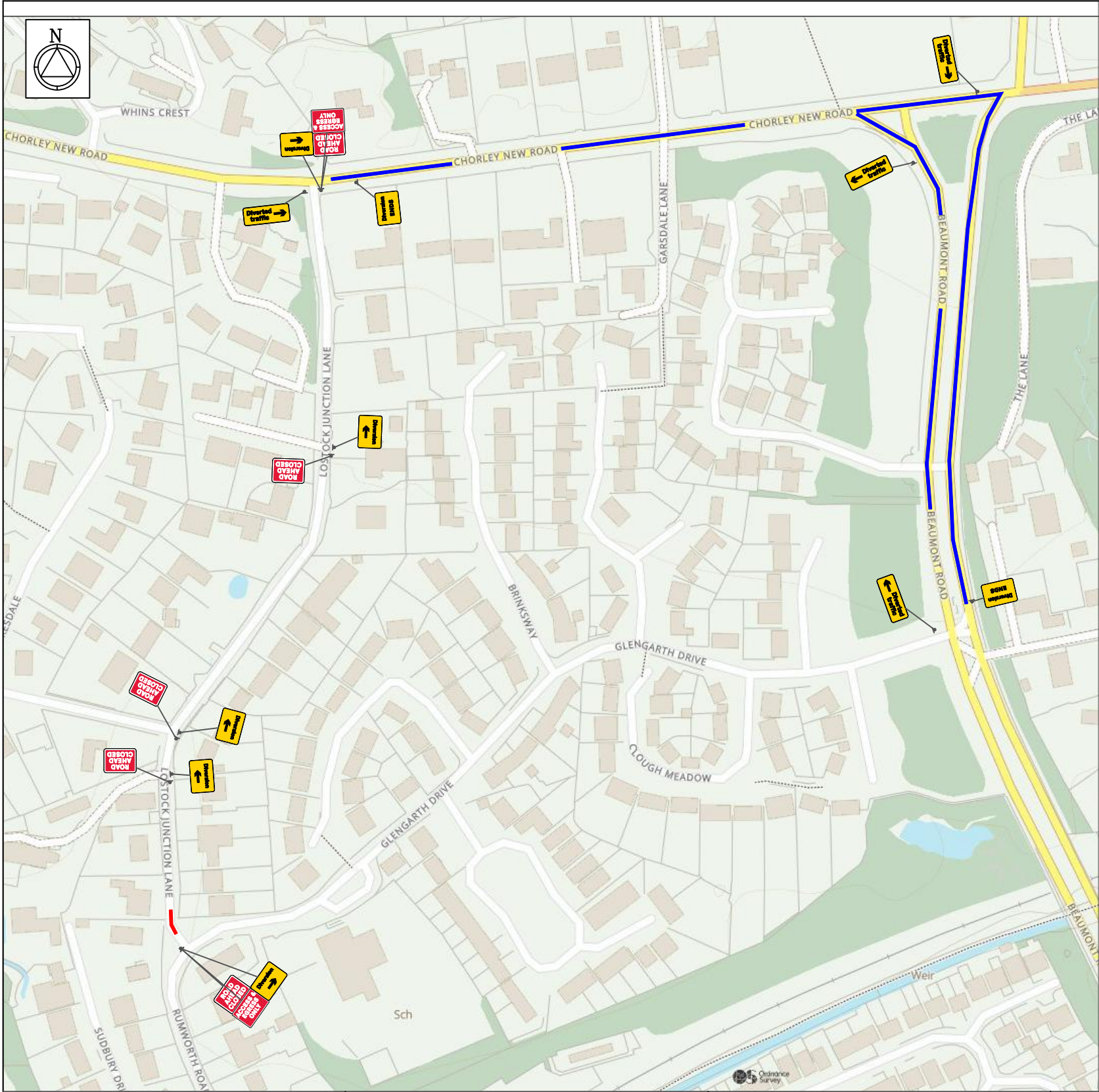





LOSTOCK JUNCTION LANE TEMPORARY CLOSURE

THE BOROUGH COUNCIL OF BOLTON
ROAD TRAFFIC REGULATION ACT 1984 S.14

The Council intends to make an order, operative from 6 June 2025 between 9.30am and 3pm approx, the effect of which will be to prohibit all traffic from proceeding on Lostock Junction Lane from Glengarth Drive to Briksdal Way, to allow manhole repair works to take place. The Order will end after 18 months or on completion of the works whichever first occurs.

Bolton Council. 16 May 2025.
bolton.gov.uk/trafficorders



KEY		Client			
	Traffic sign				
	Cone				
	Diversion				
	Closure				
	Work Area				
	Safety Zone				
Rev	Description	By	Chkd	Date	
				<div>WORKS ACCESS</div> <div>WORKS EXIT</div> <p>Works access/ works exit to be risk assessed on site for suitability of location</p>	

Additional information:	
1) Is a Switch off required?: Yes/No	Type?:
2) Is a TTRO required?: Yes/No	Type?:
3) Any Bus Stops to be suspended?: Yes/No	How Many?:
4) Do we need off-peak Working?: Yes/No	Reason Why?:
5) Parking bay suspension needed?: Yes/No	How many Bays?:

NOTES	
1 All traffic signs shall comply with Chapter 8 of the Traffic Signs Manual	
2 Maximum distance between any two temporary traffic signals to be 249m. Minimum distance between any two temporary traffic signals to be 30m.	
3 Temporary traffic signals shall not occur within 150m of an existing level crossing, Pelican crossing or signalised junction without the consent of the Engineer. The Engineer shall consult with the authority responsible for any of these types of facility prior to traffic management being installed in adjacent areas.	
4 Coning shall be installed at 45° to the edge of carriageway, as generally indicated.	
Address	
Lostock Junction Lane Bolton BL6 4JW	
TM Type	
ROAD CLOSURE	

Safety Zones:

Longways-0.5m
Sideways-0.5m

TRAFFIC MANAGEMENT NOTES

ROAD CLOSURE :

NOTES

- 1 All traffic signs shall comply with Chapter 8 of the Traffic Signs Manual
- 2 All traffic management equipment shall be provided by the Contractor, unless otherwise specified.
- 3 All signs shall be positioned so as not to be obscured by any other objects and shall not obstruct any other sign, permanent or temporary as much as is reasonably practicable.
- 4 All traffic signs shall meet the reflectorisation requirements of BS 873 : Part 6 : 1983, Table 1.
- 5 Works Access/Egress to be positioned to suit ongoing works.

Notes:

Traffic Marshal to help access to houses

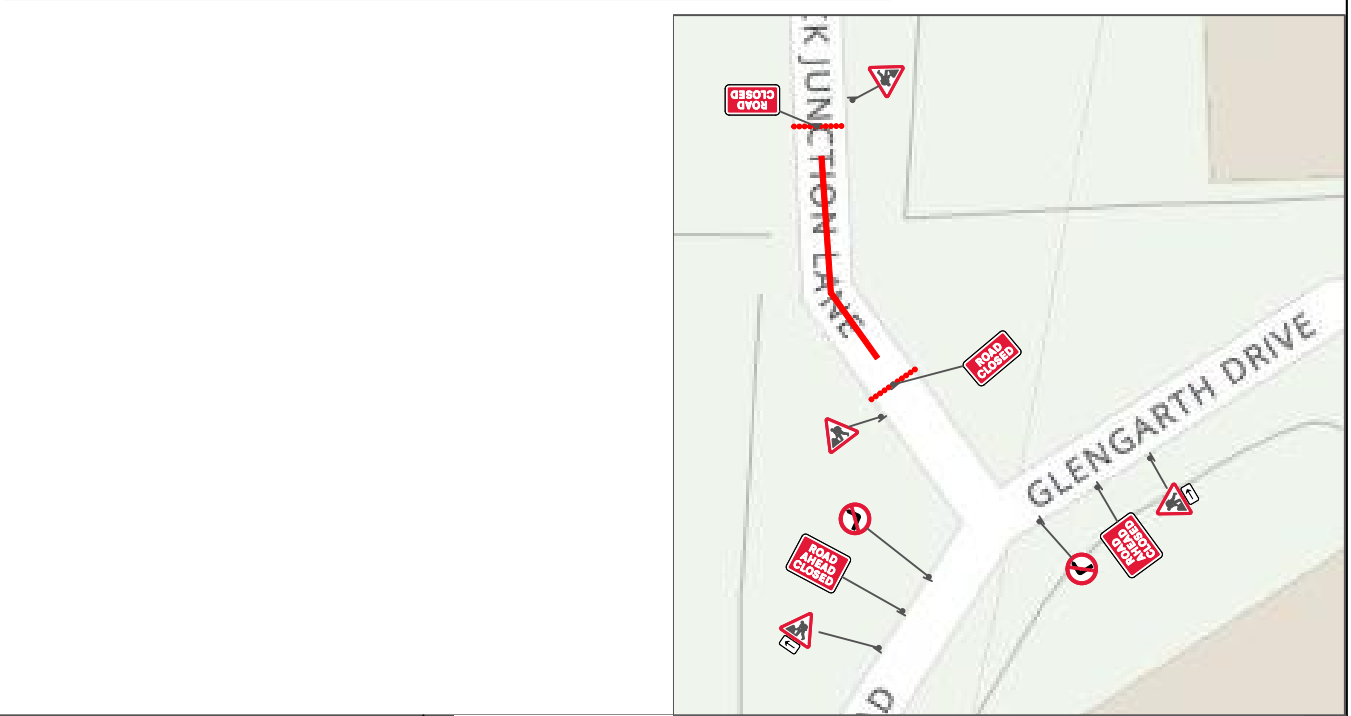

Design: xxx	Drawn: J.BRADLEY	Chkd: L.SIMPSON
Date: xxx	Date: xxx	Date: 17.02.2023
Scale: NTS @ A3	Status: FOR-ISSUE	
Drawing No SUS3808		Rev: 1