

ROAD CLOSURE

**Bolton
Council**

NOTIFICATION OF TEMPORARY ROAD CLOSURE ROAD TRAFFIC REGULATION ACT 1984

STREET

Park Road, Westhoughton

DATES

26 MAY 2025 for 1 week approx

(end date and duration are subject to change)

REASON / WORKS

Sewer works

**Advertised public notice below
Diversion plans (if available) are attached**

THE BOROUGH COUNCIL OF BOLTON
ROAD TRAFFIC REGULATION ACT 1984 S.14

The Council intends to make an order, operative from 26 May 2025 for 1 week approx, the effect of which will be to prohibit all traffic proceeding on Park Road from Captain Lees Rd to Forest Drive, to allow sewer works to take place. Alternate route is via Manchester Rd, Bolton Rd. The Order will end after 18 months or on completion of the works whichever first occurs.

Bolton Council. 5 May 2025.



If your waste or recycling bins are due to be emptied during road or resurfacing works, please present them at the nearest accessible point. This will ensure that your bins can be emptied on the usual collection day.

closures online at bolton.gov.uk/trafficorders

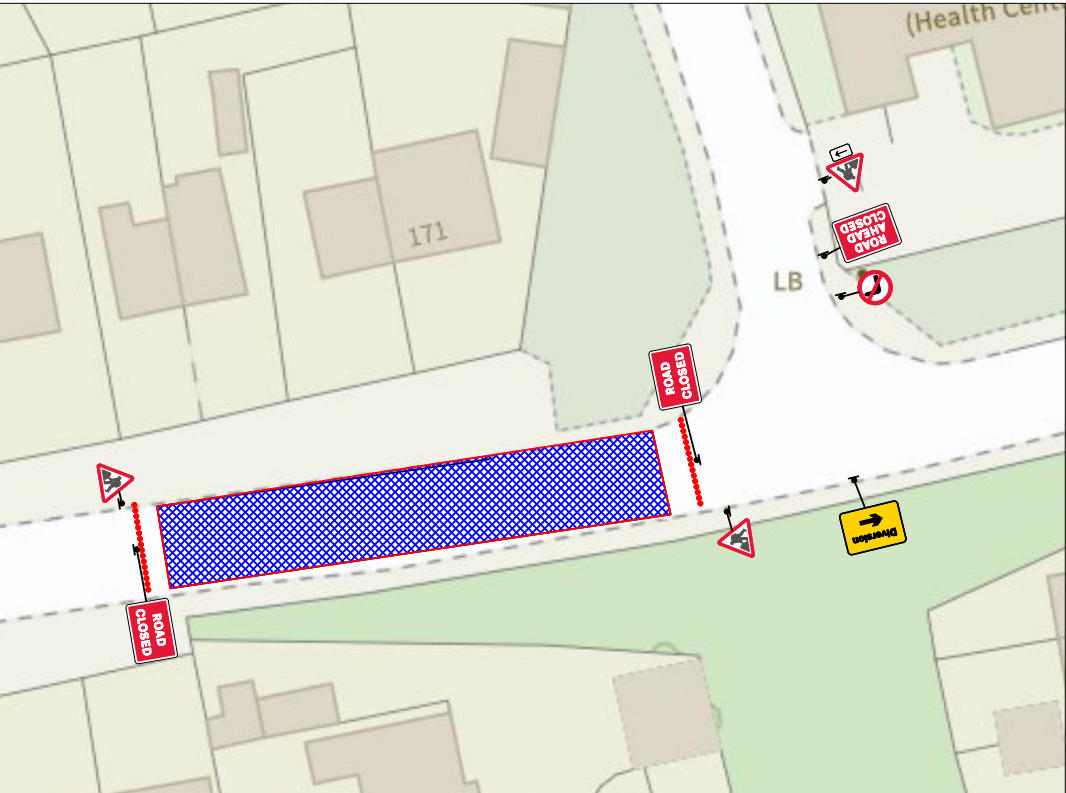
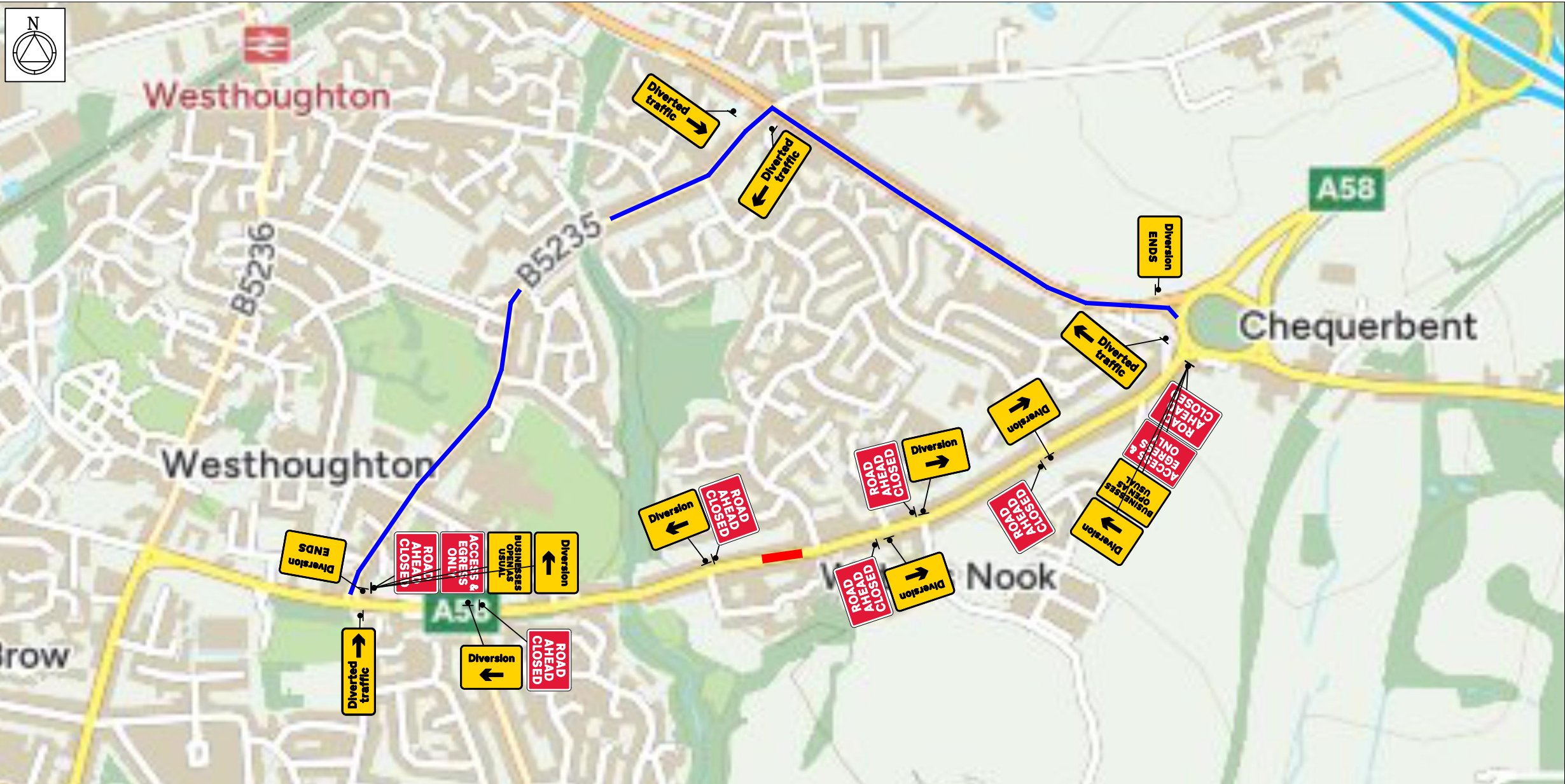

DETAIL A (A)
Prescribed sign to Diagram 610 above and behind cones
Running lane(s)
Hard Shoulder
Verge
Notes:
1) During darkness, a single warning light to BS EN 12352:2006 should be provided.
2) Traffic cones should conform to diagram 7101.1 and to BS EN 13422.

DETAIL B (B)
Single/Dual carriageway 40mph or less - 450mm traffic cones, spacing 1.5m.
Single/Dual carriageway 50mph or more - 750mm traffic cones, spacing 1.5m.
Dual carriageway national speed limit - 750mm traffic cones, spacing 1.5m, relaxation 3m.
Notes:
1) During darkness, warning lights to BS EN 12352:2006 should be provided in accordance with Table A1.3 (Appendix 1).
2) 45° tapers have 1.5m spacing, no relaxations.
3) On motorways and NSL AP duals with hard shoulders, 1m cones will be required for both standard and relaxation works for lead tapers and the facing wall of lane changes.

NOTES:
1. All signs and cones to be in accordance with Chapter 8 new roads and street works a code of practice (Red book)
2. Works access and egress are indicative, exact locations to be agreed on site.
3. Safety zones are to be installed as required as shown by the SAFETY ZONE DIMENSIONS BELOW
4. All signs to be located so as not to obscure signs or objects and should be ballasted near to ground level using sand filled hessian bags or sign straps.
5. All sign positions are indicative only and must be accurately positioned on site with good visibility and be clear of and obstructions or vegetation at all times.
6. Drawing not to scale

DIVERSION ROUTE:
B5235
A6



cadrequest@sus.co.uk tmbookings@sus.co.uk

NOTES:

- Traffic sign
- Cone
- Work Area
- Safety Zone
- Diversion
- WORKS ACCESS
- WORKS EXIT

TRAFFIC MANAGEMENT NOTES

ROAD CLOSURE :

- NOTES**
- All traffic signs shall comply with Chapter 8 of the Traffic Signs Manual
 - All traffic management equipment shall be provided by the Contractor, unless otherwise specified.
 - All signs shall be positioned so as not to be obscured by any other objects and shall not obstruct any other sign, permanent or temporary as much as is reasonably practicable.
 - All traffic signs shall meet the reflectorisation requirements of BS 673 - Part 6 : 1983, Table 1.
 - Works Access/Egress to be positioned to suit ongoing works.



SPEED OF ROAD:		30
LONGWAYS:	0.5	
SIDEWAYS:	0.5	

A		A	
B		B	
C		C	
D		D	

CLIENT:



SITE:

171 PARK ROAD WESTHOUGHTON BOLTON BL5 3DB
GRID REF: -----

TITLE: ROAD CLOSURE

SCALE AT A3: NTS	DATE: 27/02/2025	DRAWN: JD	CHECKED: JB
DWG NO: SUS10892		REV NO:	001