

# ROAD CLOSURE

**Bolton  
Council**

## NOTIFICATION OF TEMPORARY ROAD CLOSURE ROAD TRAFFIC REGULATION ACT 1984

### STREET

**Richelieu Street**

### DATES

**29 APR 2025 for 1 day approx**

(end date and duration are subject to change)

### REASON / WORKS

**Manhole repairs**

**Advertised public notice below**  
**Diversion plans (if available) are attached**

THE BOROUGH COUNCIL OF BOLTON  
ROAD TRAFFIC REGULATION ACT 1984 S.14

The Council intends to make an order, operative from 29 April 2025 between 9.30am and 3pm approx, the effect of which will be to prohibit all traffic from proceeding on Richelieu Street from Holmes St to Newport Rd to allow for manhole repairs. Alternate route for traffic will be via Blackwood St. The Order will end after 18 months or on completion of the works whichever first occurs.

Bolton Council. 8 April 2025.



If your waste or recycling bins are due to be emptied during road or resurfacing works, please present them at the nearest accessible point. This will ensure that your bins can be emptied on the usual collection day.

**closures online at [bolton.gov.uk/trafficorders](https://bolton.gov.uk/trafficorders)**



S

SAFETY ZONE DIMENSIONS  
Permanent speed limit 30mph or less  
Sideways safety zone 0.5m  
Longways safety zone 0.5m  
(Dimensions are minima)

SPECIALS -

DETAIL B B

Single/Dual carriageway 40mph or less - 450mm traffic cones, spacing 1.5m.  
Single/Dual carriageway 50mph or more - 750mm traffic cones, spacing 1.5m.  
Dual carriageway national speed limit - 750mm traffic cones, spacing 1.5m, relaxation 3m.

Notes:  
1) During darkness, warning lights to BS EN 12352:2006 should be provided in accordance with Table A1.3 (Appendix 1).  
2) 45° tapers have 1.5m spacing, no relaxations.  
3) On motorways and NSL AP duals with hard shoulders, 1m cones will be required for both standard and relaxation works for lead tapers and the facing wall of lane changes.

DETAIL D D

Single/Dual carriageway 40mph or less - 450mm traffic cones, spacing 1.5m.  
Single/Dual carriageway 50mph or more - 750mm traffic cones, spacing 1.5m.

Notes:  
1) During darkness, warning lights to BS EN 12352:2006 should be provided in accordance with Table A1.3 (Appendix 1).  
2) Detail D applies only to relaxation cases.

|                 | Standard: Normal traffic including buses and HGVs           | Restricted: Cars and light vehicles only                 |
|-----------------|---|--|
| Two-way working | 6.75 m minimum  | 5.5 m minimum  |
| Shuttle working | 3.25-3.50 m desirable width range<br>3.0 m absolute minimum | 3.25 m desirable minimum width<br>2.5 m absolute minimum |

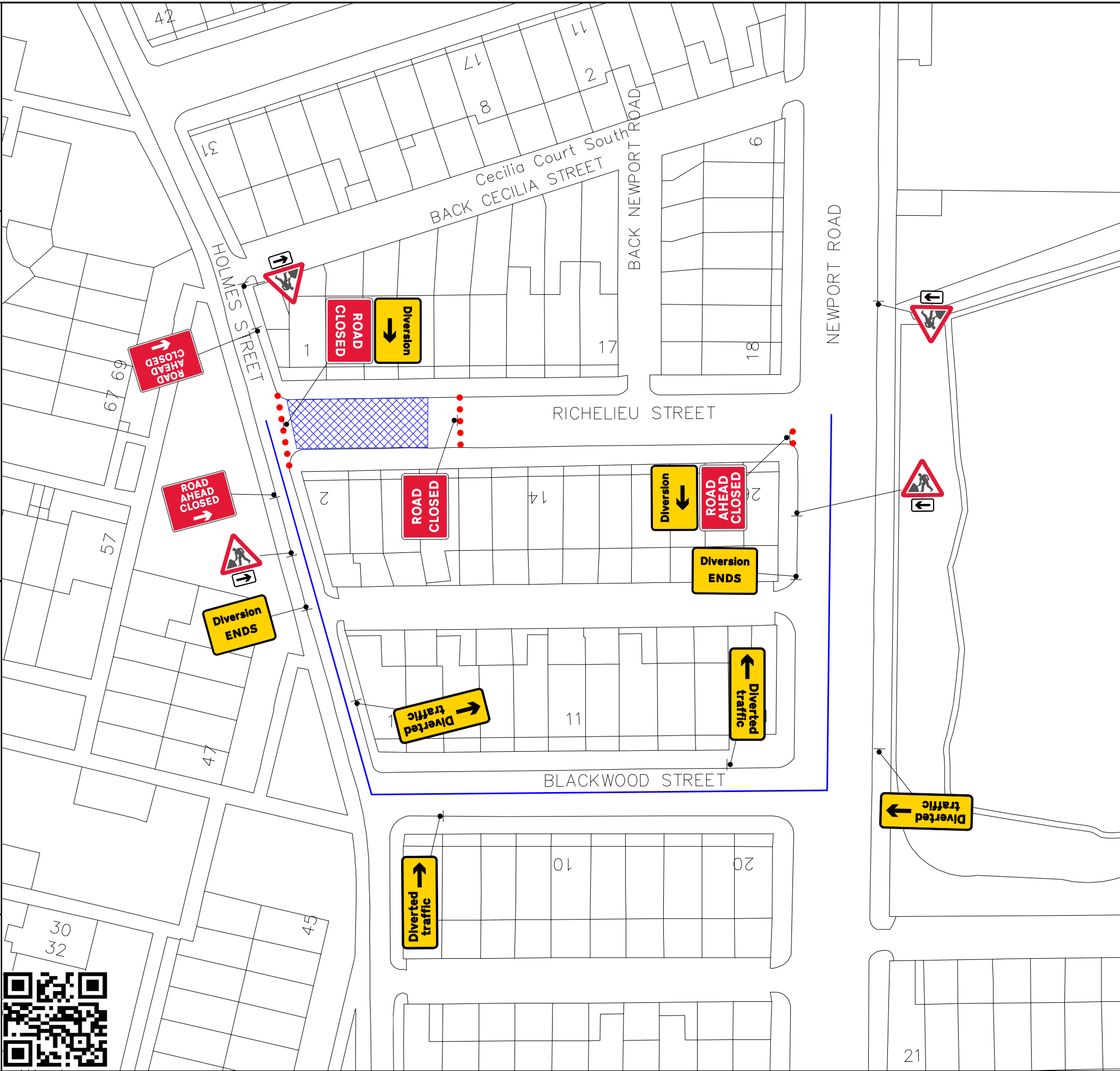
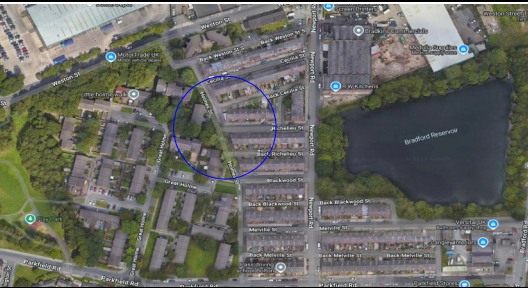

|  |  |
|--|--|
| Qty: 1 Ref: 13.9<br>Schedule 13-9 : Temporary Information                        |  |
| Qty: 1 Ref: 13.9<br>Schedule 13-9 : Temporary Information                        |  |
| Qty: 1 Ref: 2702<br>Start of temporary diversion route                           |  |
| Qty: 1 Ref: 2702<br>Start of temporary diversion route                           |  |
| Qty: 2 Ref: 2702<br>End of temporary diversion route                             |  |
| Qty: 2 Ref: 2703<br>Direction of temporary diversion route from junction ahead   |  |
| Qty: 2 Ref: 2703<br>Direction of temporary diversion route from junction ahead   |  |
| Qty: 2 Ref: 573<br>Direction to hazard right                                     |  |
| Qty: 2 Ref: 573<br>Direction to hazard left                                      |  |
| Qty: 4 Ref: 7001<br>Road works ahead   |  |
| Qty: 1 Ref: 7010-FP-13-9<br>Nature of temporary hazard ahead - Road Ahead Closed |  |
| Qty: 2 Ref: 7010-FP-13-9<br>Nature of temporary hazard ahead - Road Closed       |  |

KEY

- Traffic sign
- Traffic cone
- Traffic signals to Diagram 3000.1
- Working Space
- Pedestrian Barrier



TEMPORARY  
TRAFFIC MANAGEMENT  
PLAN

|          |          |
|----------|----------|
| Issue    | 1        |
| Date     | 12/12/24 |
| Drawn by | CT011    |

ROAD CLOSURE + DIVERSION  
RICHELIEU STREET  
BOLTON , BL3 2AY

Drawing No - SUS9841

SAPPHIRE

Original drawing size A3 - NTS