

ROAD CLOSURE

**Bolton
Council**

NOTIFICATION OF TEMPORARY ROAD CLOSURE ROAD TRAFFIC REGULATION ACT 1984

STREET

Back Sofa Street

DATES

14 MAY 2024 for 3 days approx

(end date and duration are subject to change)

REASON / WORKS

Water

Advertised public notice below

Diversion plans (if available) are attached

THE BOROUGH COUNCIL OF BOLTON
ROAD TRAFFIC REGULATION ACT 1984 S.14
BACK SOFA STREET - TEMPORARY CLOSURE

The Council intends to make an order, operative from 14 May 2024 for 3 days approx, the effect of which will be to prohibit all traffic proceeding on Back Sofa Street from Shipton St to Bentinck St, to allow water works to take place. The Order will end after 18 months or on completion of the works whichever first occurs.

Bolton Council. 23 April 2024.



If your waste or recycling bins are due to be emptied during road or resurfacing works, please present them at the nearest accessible point. This will ensure that your bins can be emptied on the usual collection day.

closures online at **bolton.gov.uk/trafficorders**

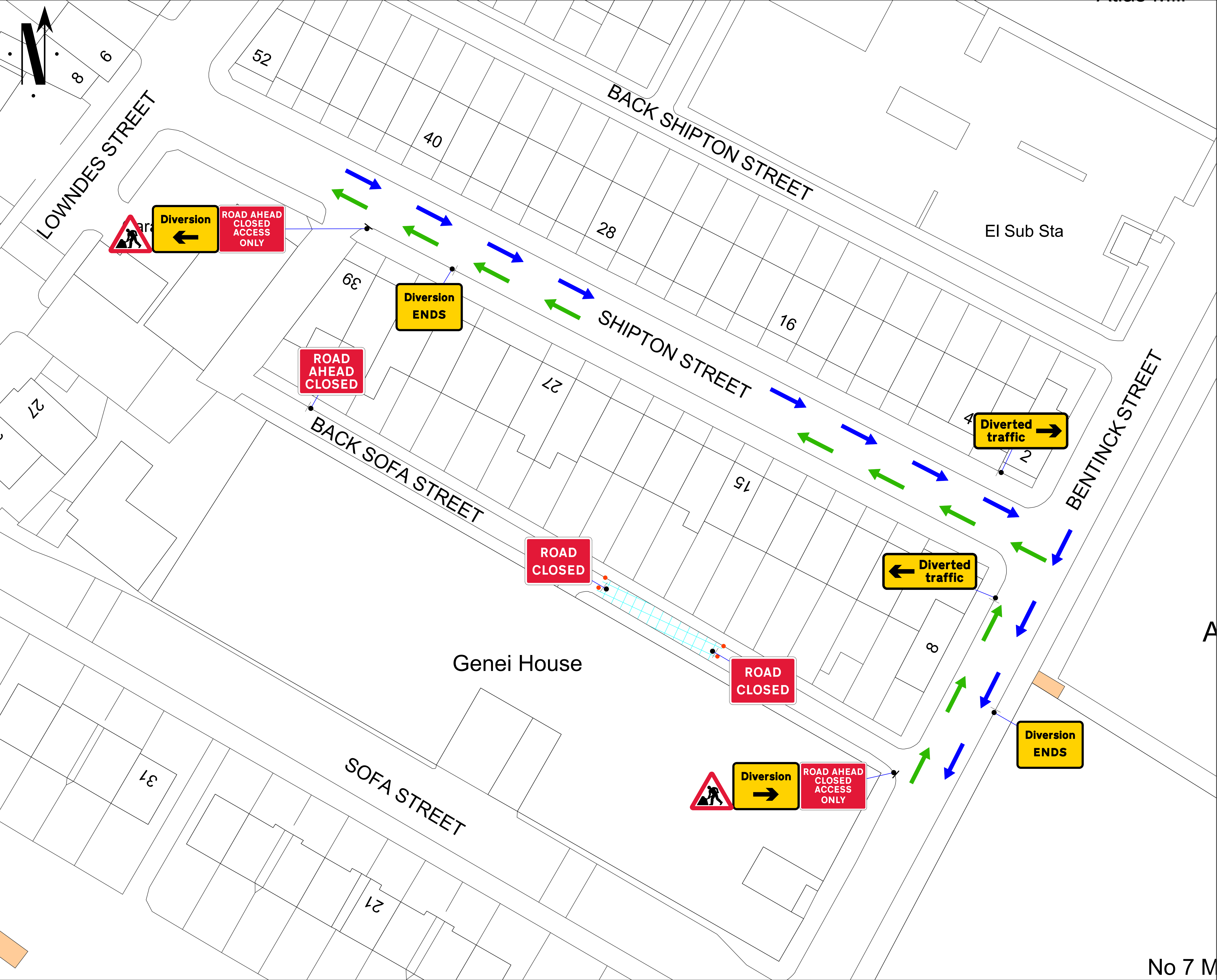

Go Traffic Management

This drawing has been produced for a specific client & project identified below and is not intended for use by any other person or for any other purpose. © Go Traffic Management

Risks

- Design completed from information provided + google maps desktop risk assessment
- Cone lamps must be used on all road with A speed limit of 40mph or more.

Notes

- All signs as per Chapter 8. Distances between cones to be 9m maximum unless otherwise noted.
- Distances between signs NOT to scale for purpose of clarity.
- All sign placement subject to available safe working space.
- The purpose of the Traffic Management Plan is for it to be used only as a guide and all traffic management equipment should be put out according to the 'Safety at Street Works and Road Works - Code of Practice', i.e. Red Book & the 'Traffic Signs Manual Chapter 8', i.e. Yellow Book.
- Signs must be placed in accordance with TSM and the scheme RAMS pack.
- Site conditions may have changed since the design of the drawing; any changes which subsequently affect the design need to be reported by the Traffic Management Operative & any changes implemented must comply with Chapter 8.

Key

Sign position and aspect of vision

Cones

Work area

Diversion Route 1

Diversion Route 2

Traffic Management must comply with The Safety at Street Works and Road Works Code of Practice

WRITTEN DIVERSION ROUTE.
Back Sofa Street Closed. Traffic Diverted Via Bentinck Street and Shipton Street.

WRITTEN DIVERSION ROUTE.
Back Sofa Street Closed. Traffic Diverted Via Shipton Street and Bentinck Street.

ROAD SPEED

30

CROSS SECTION

End of Work Area

Work Area

End of Work Area

DO NOT SCALE FROM THIS DRAWING.

ROAD CLOSURE

A

21/03/24

AS DRAWN

REV.

DATE

DESCRIPTION

GTM

Go Traffic Management

Head Office: Go Traffic Management,
Chaddock Lane, Worsley, Manchester, M28 1XW

Tel: 0161 351 5370

www.gtm.co.uk

CERTIFIED

R

ISO 9001:2015
01545 18901

TRAFFIC MANAGEMENT PLAN

Client:

Network Plus

Drawing Number:

931210

Drawing Title:

17 Shipton Street, Bolton, BL1 4QD

Design:

Technical Officer:

REV:

Name:

A.Bolan

L.Corcoran

Signature:

Date:

21/03/24

21/03/24

BASED UPON THE ORDNANCE SURVEY MAP WITH THE PERMISSION OF THE CONTROLLER OF H.M. STATIONERY OFFICE.