



Road Closures

**Bolton
Council**

NOTIFICATION OF TEMPORARY ROAD CLOSURE ROAD TRAFFIC REGULATION ACT 1984

STREET

Halliwell Various Streets (see below)

DATES

24 AUG 2020 for 6 weeks approx

(end date and duration are subject to change)

REASON

Resurfacing

Public notice and diversion plan (if available) are attached.

THE BOROUGH COUNCIL OF BOLTON
ROAD TRAFFIC REGULATION ACT 1984 S.14
HALLIWELL AREA STREETS - TEMPORARY CLOSURES

The Council intends to make an order, operative from 24 August 2020 for 6 weeks approx, the effect of which will be to prohibit all traffic from proceeding on the following streets to enable resurfacing works to take place:

Kirkhope Drive: 24-28 Aug.

Clarke Street, Beverley Road & Park Street: 28 Sep - 9 Oct.

The Order will end after 18 months or on completion of the works whichever first occurs.

Bolton Council. 3 August 2020.



If your waste or recycling bins are due to be emptied during road or resurfacing works, please present them at the nearest accessible point. This will ensure that your bins can be emptied on the usual collection day.

www.bolton.gov.uk/trafficorders

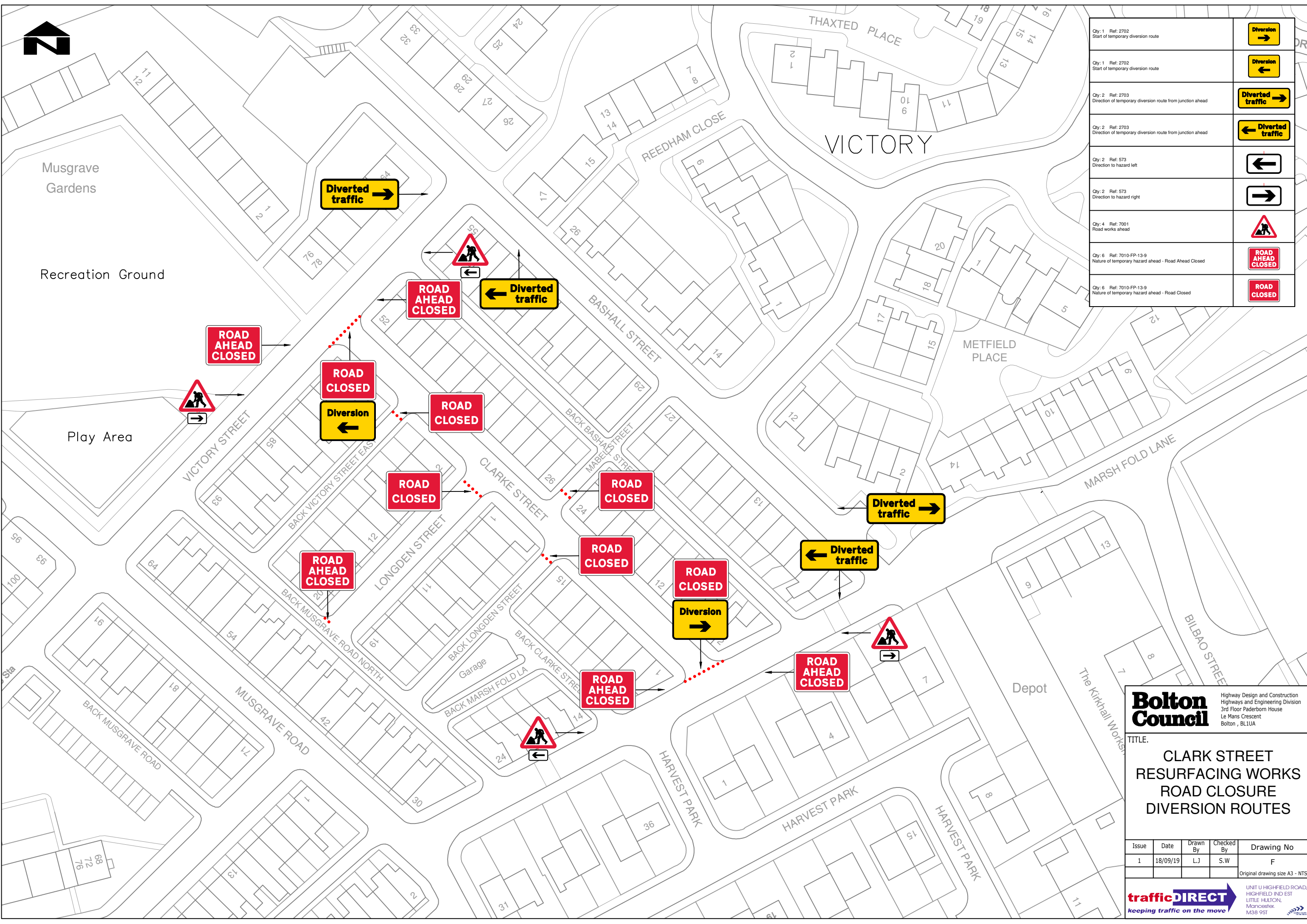

Qty: 1 Ref: 2702 Start of temporary diversion route	
Qty: 1 Ref: 2702 Start of temporary diversion route	
Qty: 2 Ref: 2703 Direction of temporary diversion route from junction ahead	
Qty: 2 Ref: 2703 Direction of temporary diversion route from junction ahead	
Qty: 2 Ref: 573 Direction to hazard left	
Qty: 2 Ref: 573 Direction to hazard right	
Qty: 4 Ref: 7001 Road works ahead	
Qty: 6 Ref: 7010-FP-13-9 Nature of temporary hazard ahead - Road Ahead Closed	
Qty: 6 Ref: 7010-FP-13-9 Nature of temporary hazard ahead - Road Closed	

Bolton Council
 Highway Design and Construction
 Highways and Engineering Division
 3rd Floor Paderborn House
 Le Mans Crescent
 Bolton, BL1UA

TITLE:
**CLARK STREET
 RESURFACING WORKS
 ROAD CLOSURE
 DIVERSION ROUTES**

Issue	Date	Drawn By	Checked By	Drawing No
1	18/09/19	LJ	S.W	F

Original drawing size A3 - NTS

trafficDIRECT
 keeping traffic on the move

UNIT 1 HIGHFIELD ROAD,
 HIGHFIELD IND EST
 LITTLE HULTON,
 Manchester,
 M38 9ST

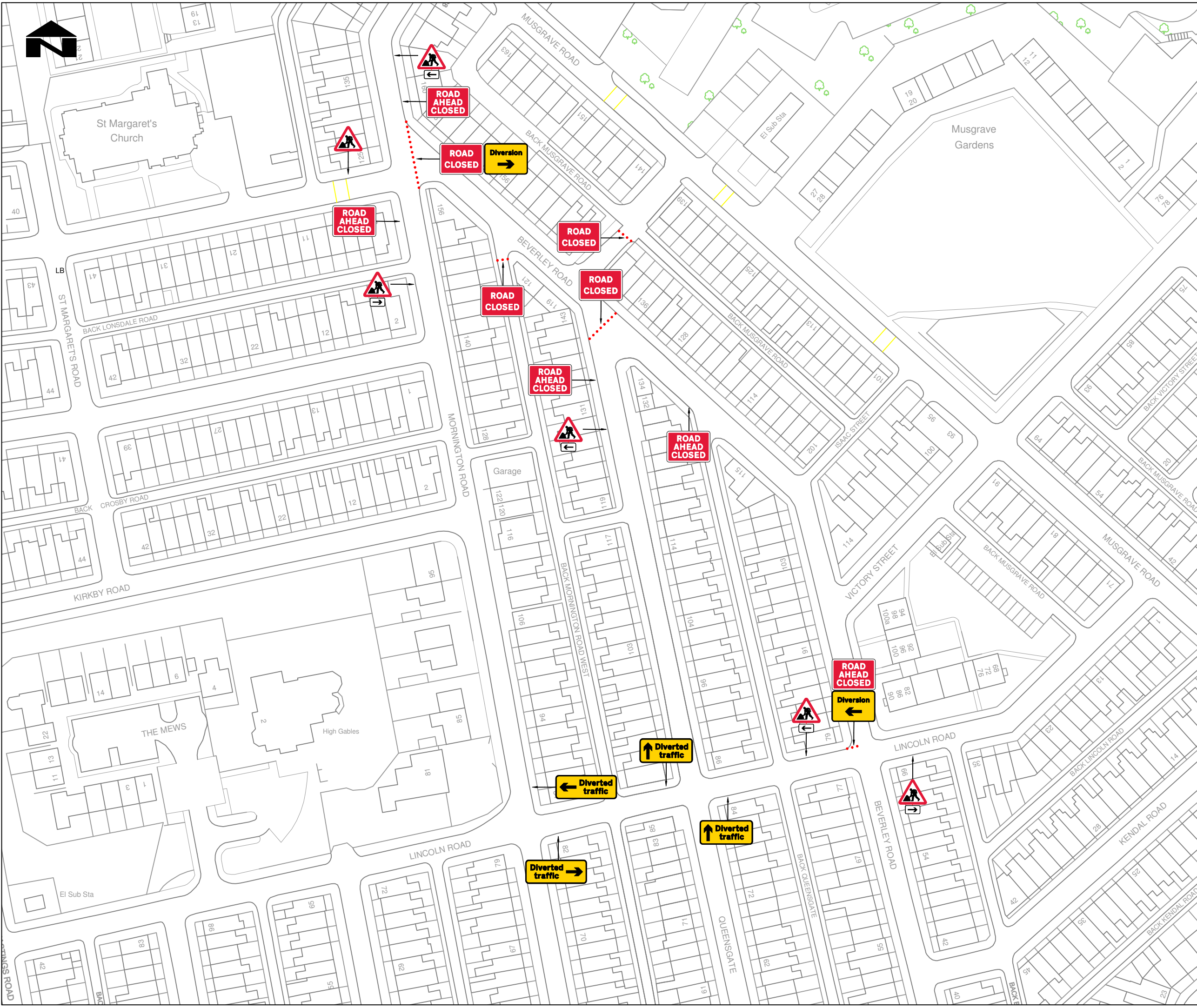

Qty: 1 Ref: 2702 Start of temporary diversion route	
Qty: 1 Ref: 2702 Start of temporary diversion route	
Qty: 1 Ref: 2703 Direction of temporary diversion route from junction ahead	
Qty: 2 Ref: 2703 Direction of temporary diversion route from junction ahead	
Qty: 1 Ref: 2703 Direction of temporary diversion route from junction ahead	
Qty: 2 Ref: 573 Direction to hazard right	
Qty: 3 Ref: 573 Direction to hazard left	
Qty: 6 Ref: 7001 Road works ahead	
Qty: 6 Ref: 7010-FP-13-9 Nature of temporary hazard ahead - Road Ahead Closed	
Qty: 4 Ref: 7010-FP-13-9 Nature of temporary hazard ahead - Road Closed	

Bolton Council
 Highway Design and Construction
 Highways and Engineering Division
 3rd Floor Paderborn House
 Le Mans Crescent
 Bolton, BL1UA

TITLE:
**BEVERLEY STREET
 RESURFACING WORKS
 ROAD CLOSURE
 DIVERSION ROUTES**

Issue	Date	Drawn By	Checked By	Drawing No
1	18/09/19	LJ	S.W	I

Original drawing size A3 - NTS

trafficDIRECT
 keeping traffic on the move

UNIT U HIGHFIELD ROAD,
 HIGHFIELD IND EST
 LITTLE HULTON,
 Manchester,
 M38 9ST

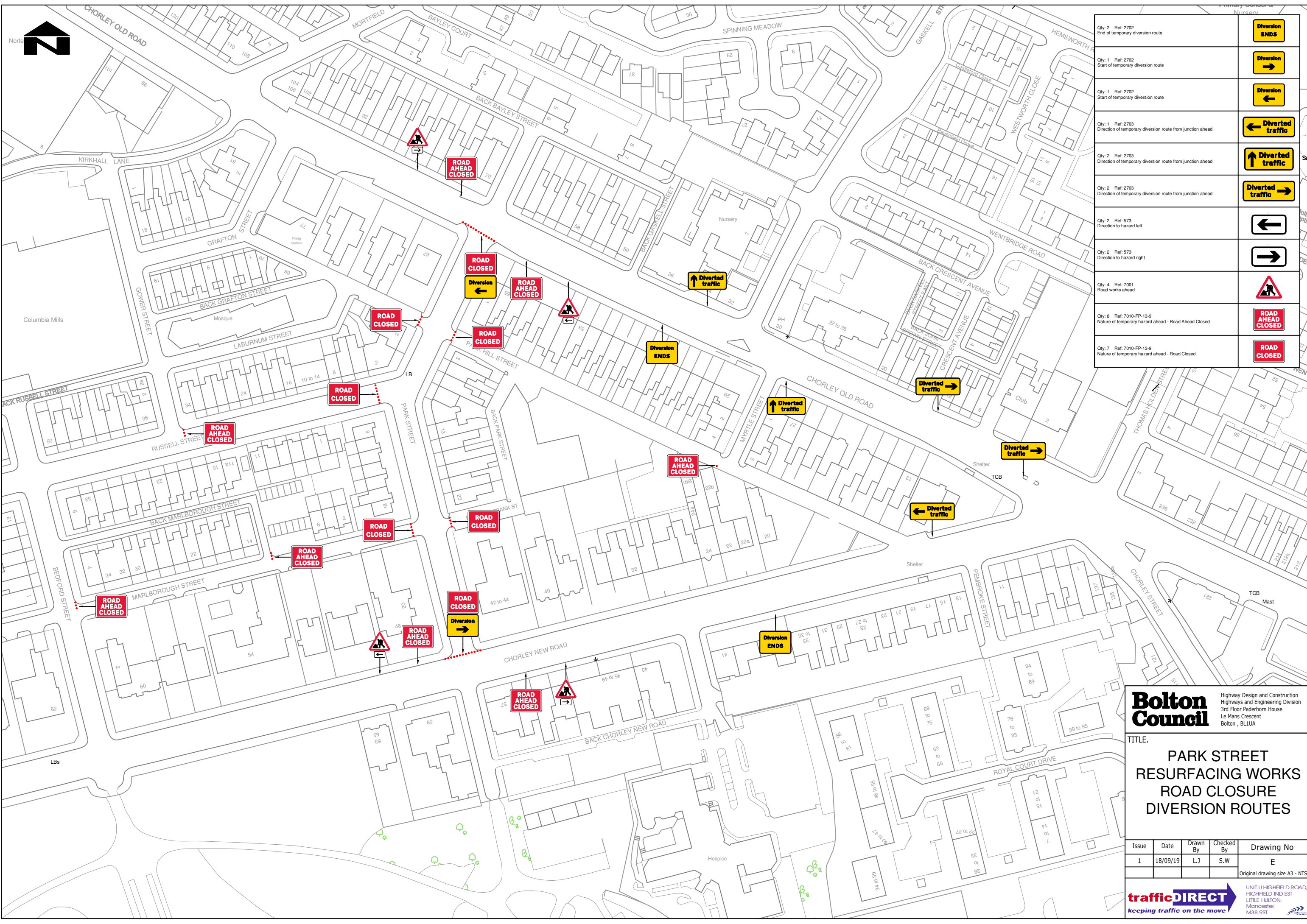

Qty: 2 Ref: 2702 End of temporary diversion route	
Qty: 1 Ref: 2702 Start of temporary diversion route	
Qty: 1 Ref: 2702 Start of temporary diversion route	
Qty: 1 Ref: 2703 Direction of temporary diversion route from junction ahead	
Qty: 2 Ref: 2703 Direction of temporary diversion route from junction ahead	
Qty: 2 Ref: 2703 Direction of temporary diversion route from junction ahead	
Qty: 2 Ref: 573 Direction to hazard left	
Qty: 2 Ref: 573 Direction to hazard right	
Qty: 4 Ref: 7001 Road works ahead	
Qty: 8 Ref: 7010-FP-13-9 Nature of temporary hazard ahead - Road Ahead Closed	
Qty: 7 Ref: 7010-FP-13-9 Nature of temporary hazard ahead - Road Closed	

Bolton Council
 Highway Design and Construction
 Highways and Engineering Division
 3rd Floor Paderborn House
 Le Mans Crescent
 Bolton, BL1UA

TITLE:
**PARK STREET
 RESURFACING WORKS
 ROAD CLOSURE
 DIVERSION ROUTES**

Issue	Date	Drawn By	Checked By	Drawing No
1	18/09/19	LJ	S.W	E

Original drawing size A3 - NTS

trafficDIRECT
 keeping traffic on the move

UNIT U HIGHFIELD ROAD,
 HIGHFIELD IND EST
 LITTLE HULTON,
 Manchester,
 M38 9ST