

NOTICE OF CONFIRMATION OF A PUBLIC PATH DIVERSION AND DEFINITIVE MAP AND STATEMENT MODIFICATION ORDER

TOWN AND COUNTRY PLANNING ACT 1990
WILDLIFE AND COUNTRYSIDE ACT 1981

THE BOROUGH COUNCIL OF BOLTON (PUBLIC FOOTPATH NO. 014 TURTON BROMLEY CROSS) PUBLIC PATH DIVERSION ORDER AND DEFINITIVE MAP AND STATEMENT MODIFICATION ORDER 2020

On the 8TH September 2021, the Borough Council of Bolton confirmed the above Order, made under Section 257 of the Town and Country Planning Act 1990 ("the 1990 Act") and under section 53A(2) of the Wildlife and Countryside Act 1981. The effect of the Order as confirmed is to divert:

Public Footpath No. 014 Turton Bromley Cross which leads over land off Darwen Road, Bromley Cross, Bolton BL7 commencing from point A on Darwen Road at grid reference SD372737 412909 in a generally southerly direction to point B at grid reference SD372825 412756 for a distance of approximately 176 metres as shown by the continuous bold black line between points A-B on the Order Plan of a width of 1.5 metres throughout.

The new line will commence from point C at grid reference SD372724 412909 leading in a generally south east by easterly direction to point D at grid reference SD372728 412908 for a distance of approximately 4 metres then curving in a generally east by southerly direction to point E at grid reference SD372756 412907 for a distance of approximately 28 metres then curving in a generally south east by southerly direction to point F at grid reference SD372779 412849 for a distance of approximately 64 metres then running in a generally southerly direction to point G at grid reference SD372779 412796 for a distance of approximately 53 metres then running in a generally easterly direction to point H at grid reference SD372789 412796 for a distance of approximately 9 metres then running in a generally southerly direction to point I at grid reference SD372789 412714 for a distance of approximately 82 metres then curving in a generally south easterly by easterly direction to point J at grid reference SD372799 412709 for a distance of approximately 13 metres then running in a generally south easterly direction to point K at grid reference SD372808 412702 for a distance of approximately 11 metres then curving and running in a generally south easterly direction to point L at grid reference SD372823 412684 for a distance of approximately 24 metres as shown by the bold black dashes between points C-D-E-F-G-H-I-J-K-L on the Order Plan over a total distance of approximately 288 metres. The width between points C-D-E-F-G-H-I-J-K will be 2 metres throughout, between points K-L will be 3 metres throughout over a tarmac surface.

The definitive map and statement shall be modified accordingly.

A copy of the confirmed Order and plan may be inspected free of charge at The Central Library, Bolton during office hours. Copies of the Order and Plan may be purchased.

The Order will come into force on the date on which The Borough Council of Bolton certify that the terms of Article 2 of the Order have been complied with but if any person aggrieved by the Order wants to question its validity or a provision contained within it on the ground that it is not within the powers of the Town and Country Planning Act 1990, or on the ground that any requirement of the Act as amended, or of any regulation made under it has not been complied with in relation to the confirmation of the Order, he or she may apply to the High Court for any of these purposes under Section 287 of the Town and Country Planning Act 1990 within 6 weeks from the date on which notice is first published as required by paragraph 7 of Schedule 14 to the Act.

Dated 17th September 2021



H Gorman, Borough Solicitor, Chief Executives Department, Town Hall, Bolton, BL1 1RU
LS/SMW/080264

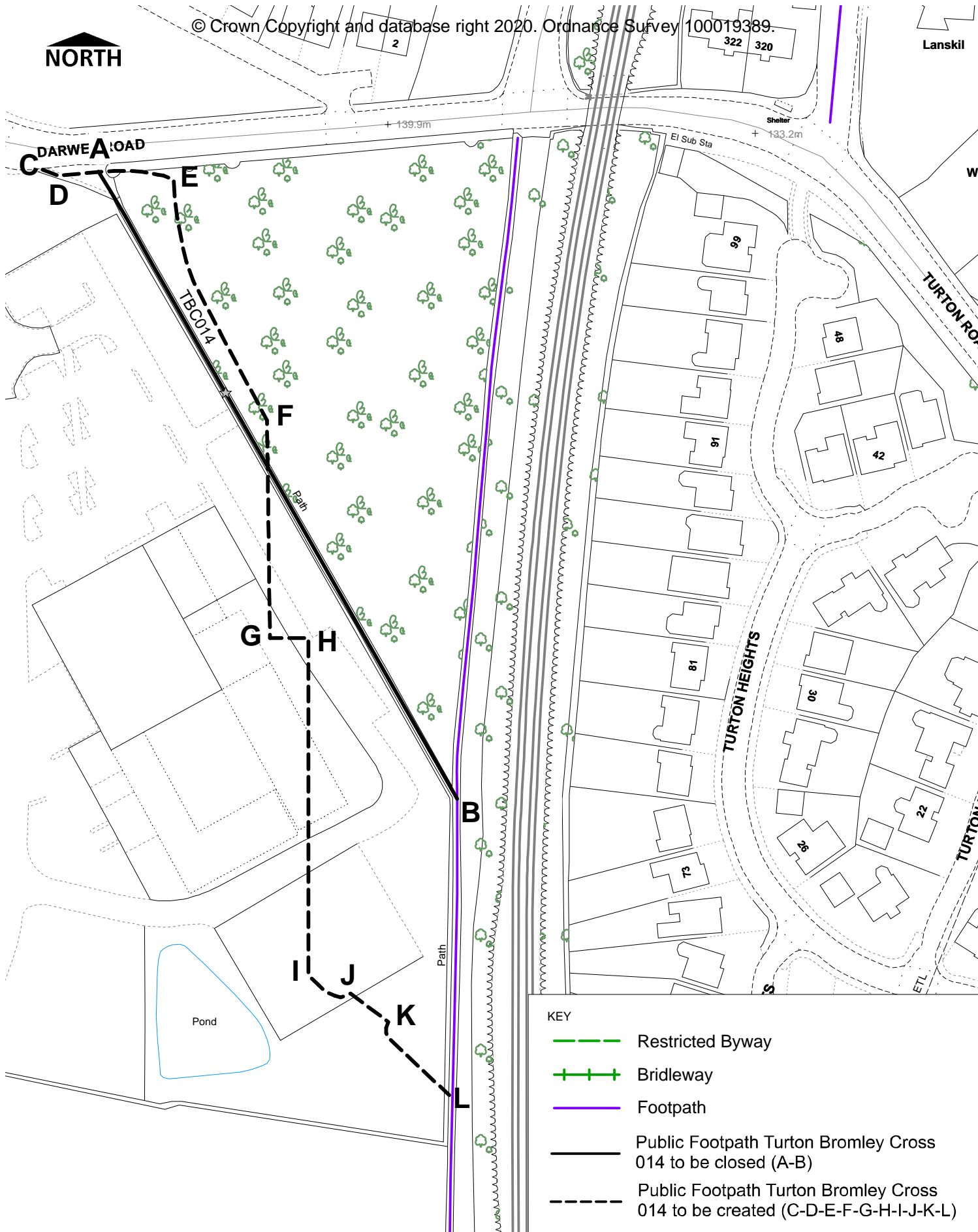

KEY	
	Restricted Byway
	Bridleway
	Footpath
	Public Footpath Turton Bromley Cross 014 to be closed (A-B)
	Public Footpath Turton Bromley Cross 014 to be created (C-D-E-F-G-H-I-J-K-L)



HIGHWAY AND ENGINEERING DIVISION
PUBLIC RIGHTS OF WAY

THE BOROUGH COUNCIL OF BOLTON
Public Footpath Turton Bromley Cross 014 Diversion
Order Section 257 Town and Country Planning Act 1990

DIRECTORATE OF PLACE

Gerald Brough BSc (Hons) MBA, Dip M
Director of Place
Town Hall, Victoria Square, Bolton, BL1 1RU

Date
03/03/2020

Scale
1:1200

Drawn
AS

Drg. No.
1Tbc014 The Plan