

**PUBLIC PATH DIVERSION AND DEFINITIVE MAP AND STATEMENT MODIFICATION
ORDER**

**TOWN AND COUNTRY PLANNING ACT 1990
WILDLIFE AND COUNTRYSIDE ACT 1981**

**THE BOROUGH COUNCIL OF BOLTON (PUBLIC FOOTPATH NO. 014 TURTON BROMLEY
CROSS PUBLIC PATH DIVERSION ORDER AND DEFINITIVE MAP AND STATEMENT
MODIFICATION ORDER 2020**

The above Order, made on 5th August 2020 under Section 257 of the Town and Country Planning Act 1980 and under section 53A(2) of the Wildlife and Countryside Act 1981 will modify the Definitive Map and Statement for the area by diverting Public Footpath No. 014 Turton Bromley Cross as follows:

Public Footpath No. 014 Turton Bromley Cross which leads over land off Darwen Road, Bromley Cross, Bolton BL7 commencing from point A on Darwen Road at grid reference SD372737 412909 in a generally southerly direction to point B at grid reference SD372825 412756 for a distance of approximately 176 metres as shown by the continuous bold black line between points A-B on the Order Plan of a width of 1.5 metres throughout.

The new line will commence from point C at grid reference SD372724 412909 leading in a generally south east by easterly direction to point D at grid reference SD372728 412908 for a distance of approximately 4 metres then curving in a generally east by southerly direction to point E at grid reference SD372756 412907 for a distance of approximately 28 metres then curving in a generally south east by southerly direction to point F at grid reference SD372779 412849 for a distance of approximately 64 metres then running in a generally southerly direction to point G at grid reference SD372779 412796 for a distance of approximately 53 metres then running in a generally easterly direction to point H at grid reference SD372789 412796 for a distance of approximately 9 metres then running in a generally southerly direction to point I at grid reference SD372789 412714 for a distance of approximately 82 meters then curving in a generally south easterly by easterly direction to point J at grid reference SD372799 412709 for a distance of approximately 13 metres then running in a generally south easterly direction to point K at grid reference SD372808 412702 for a distance of approximately 11 metres then curving and running in a generally south easterly direction to point L at grid reference SD372823 412684 for a distance of approximately 24 metres as shown by the bold black dashes between points C-D-E-F-G-H-I-J-K-L on the Order Plan over a total distance of approximately 288 metres. The width between points C-D-E-F-G-H-I-J-K will be 2 metres throughout, between points K-L will be 3 metres throughout over a tarmac surface.

A copy of the Order and Plan have been placed and may be seen free of charge at The Central Library, Le Mans Crescent, Bolton, BL1 1SE during open hours. Copies of the Order and Plan may be purchased.

Objections or representations should state the grounds on which they are made and either sent to Saskia.whalley@bolton.gov.uk or in writing to Saskia Whalley at the address below not later than the 16th September 2020.

If no objections or representations are duly made, or if any so made are withdrawn, the Council may confirm the Order as an unopposed Order. If the Order is sent to the Secretary of State for confirmation, any objections or representations which have not been withdrawn will be sent with the Order.

Dated: 5th August 2020

H Gorman
Borough Solicitor
Chief Executives Department
Town Hall
Bolton BL1 1RU

LS/SMW/80264

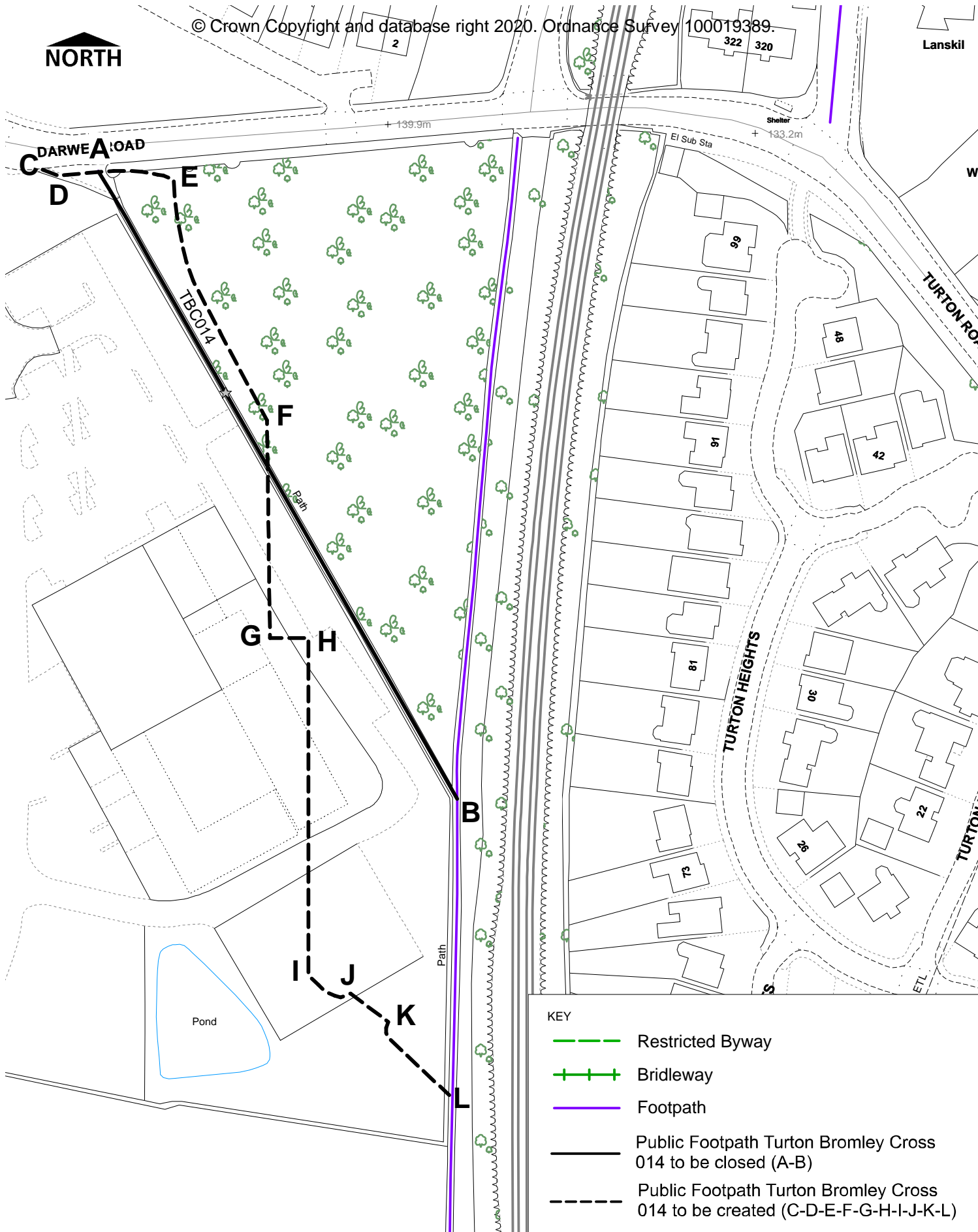

KEY	
	Restricted Byway
	Bridleway
	Footpath
	Public Footpath Turton Bromley Cross 014 to be closed (A-B)
	Public Footpath Turton Bromley Cross 014 to be created (C-D-E-F-G-H-I-J-K-L)



HIGHWAY AND ENGINEERING DIVISION
PUBLIC RIGHTS OF WAY

THE BOROUGH COUNCIL OF BOLTON
Public Footpath Turton Bromley Cross 014 Diversion
Order Section 257 Town and Country Planning Act 1990

DIRECTORATE OF PLACE

Gerald Brough BSc (Hons) MBA, Dip M
Director of Place
Town Hall, Victoria Square, Bolton, BL1 1RU

Date
03/03/2020

Scale
1:1200

Drawn
AS

Drg. No.
1Tbc014 The Plan