



# Road Closures

**Bolton  
Council**

## NOTIFICATION OF TEMPORARY ROAD CLOSURE ROAD TRAFFIC REGULATION ACT 1984

### STREET

**Brightmet Drive**

### DATES

**23 JUL 2020 for 2 weeks approx**

(end date and duration are subject to change)

### REASON

**Resurfacing**

**Public notice and diversion plan (if available) are attached.**

THE BOROUGH COUNCIL OF BOLTON  
ROAD TRAFFIC REGULATION ACT 1984 S.14  
BRIGHTMET DRIVE - TEMPORARY CLOSURE

The Council intends to make an order, operative from 23 July 2020 for 2 weeks approx, the effect of which will be to prohibit all traffic from proceeding on Brightmet Drive, between Long Lane & Garstang Ave, to enable resurfacing works to take place. Alternate route for traffic will be via Blenheim Rd. The Order will end after 18 months or on completion of the works whichever first occurs.

Bolton Council. 2 July 2020.



If your waste or recycling bins are due to be emptied during road or resurfacing works, please present them at the nearest accessible point. This will ensure that your bins can be emptied on the usual collection day.

[www.bolton.gov.uk/trafficorders](http://www.bolton.gov.uk/trafficorders)

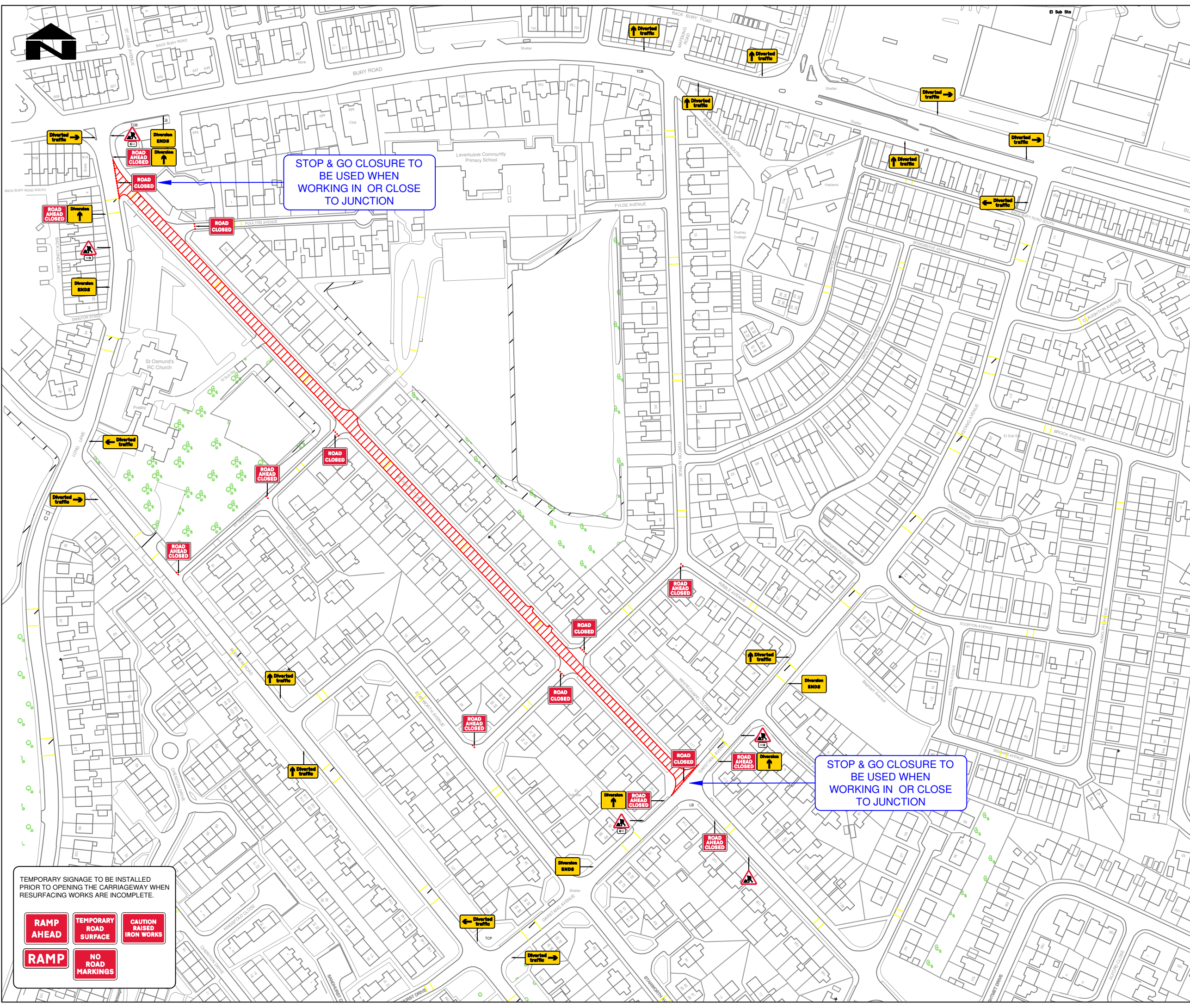

STOP & GO CLOSURE TO BE USED WHEN WORKING IN OR CLOSE TO JUNCTION

STOP & GO CLOSURE TO BE USED WHEN WORKING IN OR CLOSE TO JUNCTION

TEMPORARY SIGNAGE TO BE INSTALLED PRIOR TO OPENING THE CARRIAGEWAY WHEN RESURFACING WORKS ARE INCOMPLETE.

- RAMP AHEAD
- TEMPORARY ROAD SURFACE
- CAUTION RAISED IRON WORKS
- RAMP
- NO ROAD MARKINGS

Qty: 4 Ref: 2702 End of temporary diversion route	
Qty: 4 Ref: 2702 Start of temporary diversion route	
Qty: 7 Ref: 2703 Direction of temporary diversion route from junction ahead	
Qty: 5 Ref: 2703 Direction of temporary diversion route from junction ahead	
Qty: 3 Ref: 2703 Direction of temporary diversion route from junction ahead	
Qty: 1 Ref: 517 Road narrows on one side only ahead - right	
Qty: 1 Ref: 517 Road narrows on one side only ahead - left	
Qty: 2 Ref: 518 Single file traffic	
Qty: 2 Ref: 573 Direction to hazard left	
Qty: 2 Ref: 573 Direction to hazard right	
Qty: 1 Ref: 610 Keep right	
Qty: 2 Ref: 610 Keep left	
Qty: 5 Ref: 7001 Road works ahead	
Qty: 9 Ref: 7010-FP-13-9 Nature of temporary hazard ahead - Road Ahead Closed	
Qty: 6 Ref: 7010-FP-13-9 Nature of temporary hazard ahead - Road Closed	
Qty: 2 Ref: 7010.1 Nature of temporary hazard ahead - Traffic Control Ahead	
Qty: 2 Ref: 7011 When Stop Sign Shows Wait Here	
Qty: 1 Ref: 7021 Advance warning of PTS control on main road ahead	
Qty: 2 Ref: 7022 Advance warning of uncontrolled joining traffic	
Qty: 1 Ref: 7105 Lane closure barrier	

**Bolton Council**

Highway Design and Construction  
Highways and Engineering Division  
3rd Floor Paderborn House  
Le Mans Crescent  
Bolton, BL1UA

TITLE:  
**BRIGHTMET DRIVE  
RESURFACING WORKS  
ROAD CLOSURE  
DIVERSION ROUTES**

Issue	Date	Drawn By	Checked By	Drawing No
1	13/02/20	LJ	S.W	018

Original drawing size A3 - NTS

**trafficDIRECT** **keeping traffic on the move**

UNIT 1 HIGHFIELD ROAD,  
HIGHFIELD IND EST  
LITTLE HULTON,  
Manchester,  
M38 9ST