



Road Closures

**Bolton
Council**

**NOTIFICATION OF TEMPORARY ROAD CLOSURE
ROAD TRAFFIC REGULATION ACT 1984**

STREET

Long Lane & Empire Road

DATES

5 AUG 2019 for 3 weeks

(end date and duration are subject to change)

REASON

Gas mains

Public notice and diversion plan (if available) are attached.

THE BOROUGH COUNCIL OF BOLTON
ROAD TRAFFIC REGULATION ACT 1984 S.14
LONG LANE & EMPIRE ROAD - TEMPORARY CLOSURES

The Council intends to make an order, operative from 5 August 2019 for 3 weeks approx, the effect of which will be to prohibit all traffic from proceeding on Empire Road from Bury Rd to Bk Bury Rd and on Long Lane from Bury Rd to Bk Bury Rd South, to enable gas mains replacement works to take place. Diversion routes will be signed. The Order will end after 18 months or on completion of the works whichever first occurs.

Bolton Council. 15 July 2019.



If your waste or recycling bins are due to be emptied during road or resurfacing works please present them at the nearest accessible point. This will ensure that your bins can be emptied on the usual collection day.

www.bolton.gov.uk/trafficorders

DIG LOCATION ESTIMATED BASED ON INFORMATION PROVIDED. POTENTIAL TO CHANGE ON SITE

TO BE INSTALLED IN CONJUNCTION WITH DRAWINGS 05 REV A AND REV B

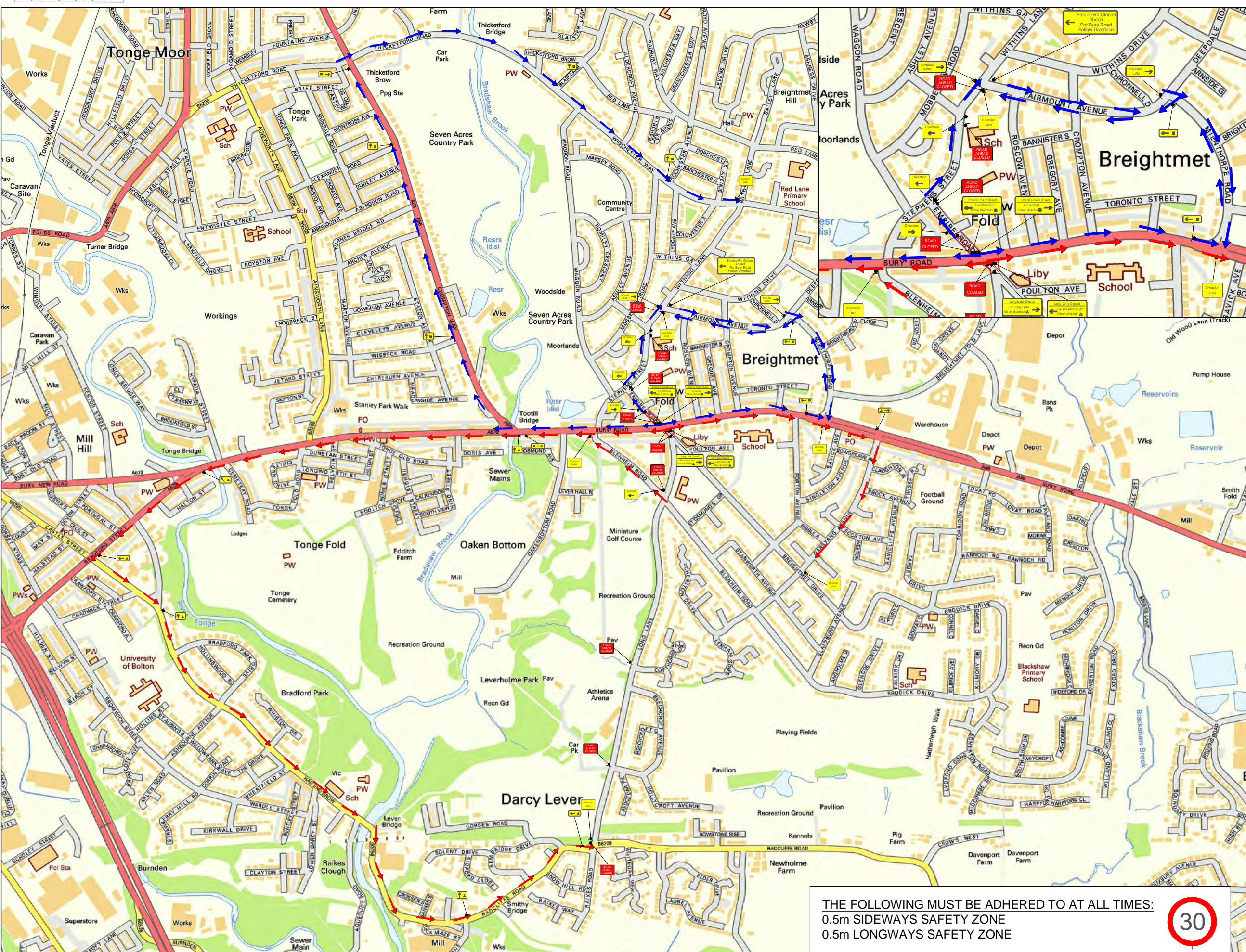

KEY:

- ROUTES
- DATUM
- ROAD CONES
- LOCATION OF ROAD SIGN
- LOCATION OF SIGNAL HEAD

-Site conditions may have changed since the design of the drawing, any changes which subsequently affect the design need to be reported by the Traffic Management Operative (and any changes implemented must comply with Chapter 8).
 -Stop/Go boards must be available and utilised in the event of portable traffic signal failure in accordance with Codes of Practice. Two Stop/Go boards are required if the site is in excess of 20m.

NOTE:
 THE FOLLOWING MUST BE ADHERED TO AT ALL TIMES:
 0.5m SIDEWAYS SAFETY ZONE
 0.5m LONGWAYS SAFETY ZONE

ROAD CLOSURE / DIVERSION

APPROX. WORKS LOCATION

Detail B

Traffic cones (45° tapers have 1.2m spacing, no relaxations)

NOTES:

- 1) During darkness, warning light to BS EN 12352:2006 should be provided in accordance with Table A.1.3 (Appendix 1).
- 2) 45° tapers have 1.2m cone spacing, no relaxations.
- 3) On motorways and all-purpose dual carriageway roads with hard shoulders on which the national speed limit applies, 1m cones will be required for both standard works and works for which relaxations may be applied, for both lead tapers and the facing wall of a lane change.

Detail C

Method C1:

Method C2:

NOTES:

- 1) During darkness, warning light to BS EN 12352:2006 should be provided in accordance with Table A.1.3 (Appendix 1).
- 2) For relaxation to Detail C1 see Table A.1.3 (Appendix 1).

Balfour Beatty ZERO HARM

SUPER PROJECT: LONG LANE, BOLTON
 GDSP YEAR 7 - 19 / 20

POSTAL CODE: BL2 6EB
 LOCATION: LONG LANE, BOLTON

TRAFFIC MANAGEMENT DRAWING
 THIS DRAWING MUST BE PRINTED IN COLOUR

Ref 'C' Drg. Drawn By: P.J. Date: 17 - 06 - 2019
 Approved By: I.C. Date: 17 - 06 - 2019

OS Ref: SO5175 Survey request No.

1:1250 @ A3
 NTS - OTHER SIZES DWG NO. NWGA200025 - 06 TM REV:

THE FOLLOWING MUST BE ADHERED TO AT ALL TIMES:
 0.5m SIDEWAYS SAFETY ZONE
 0.5m LONGWAYS SAFETY ZONE